

# SHOWGUIDE



**Complete show details**

**Full Conference timetable and program**

**Exhibitor listings and floorplans**

**tire**  
technology  
EXPO 2009

**17, 18, 19 FEBRUARY 2009, HAMBURG, GERMANY**

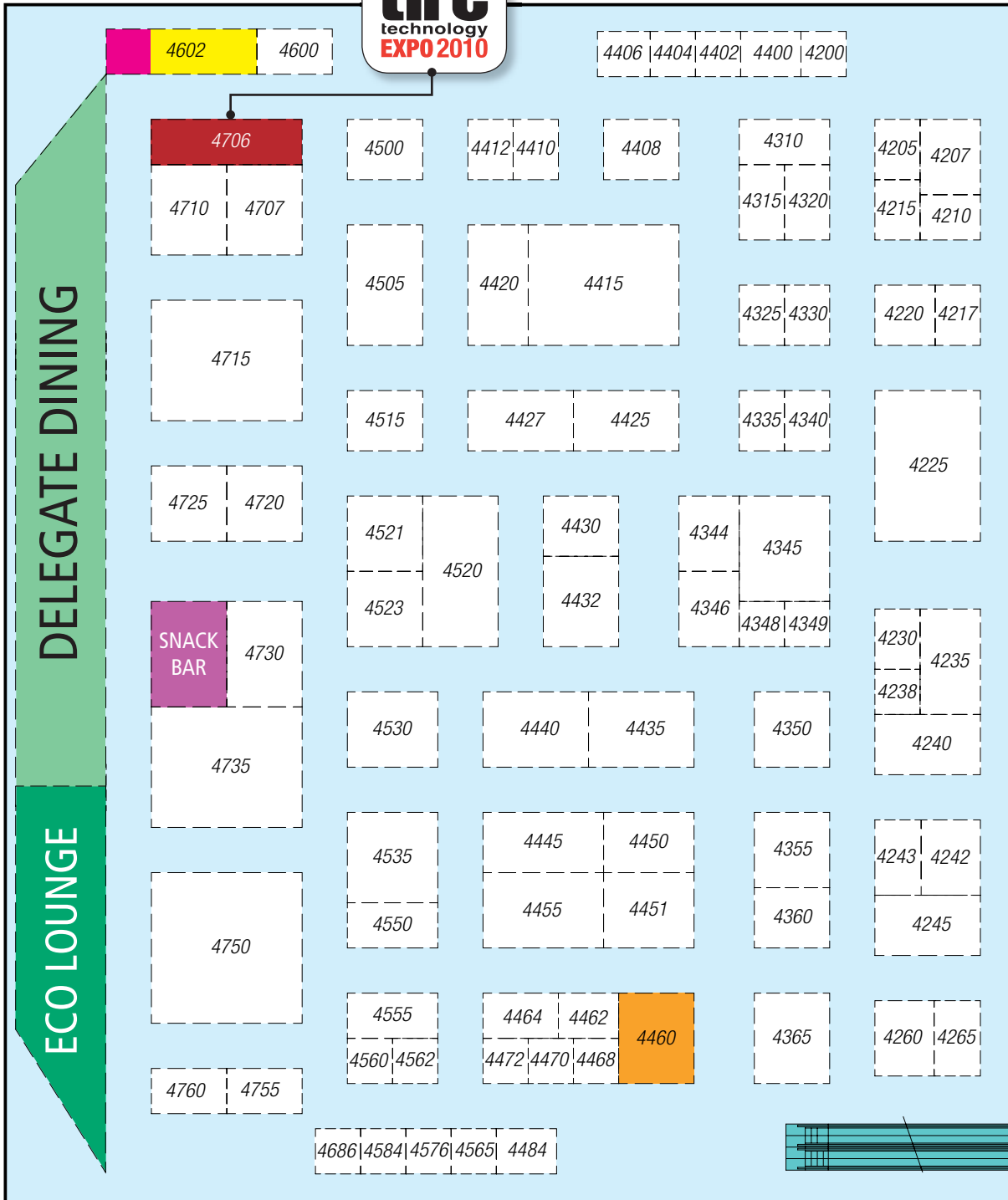

# FLOORPLAN: HALL A1

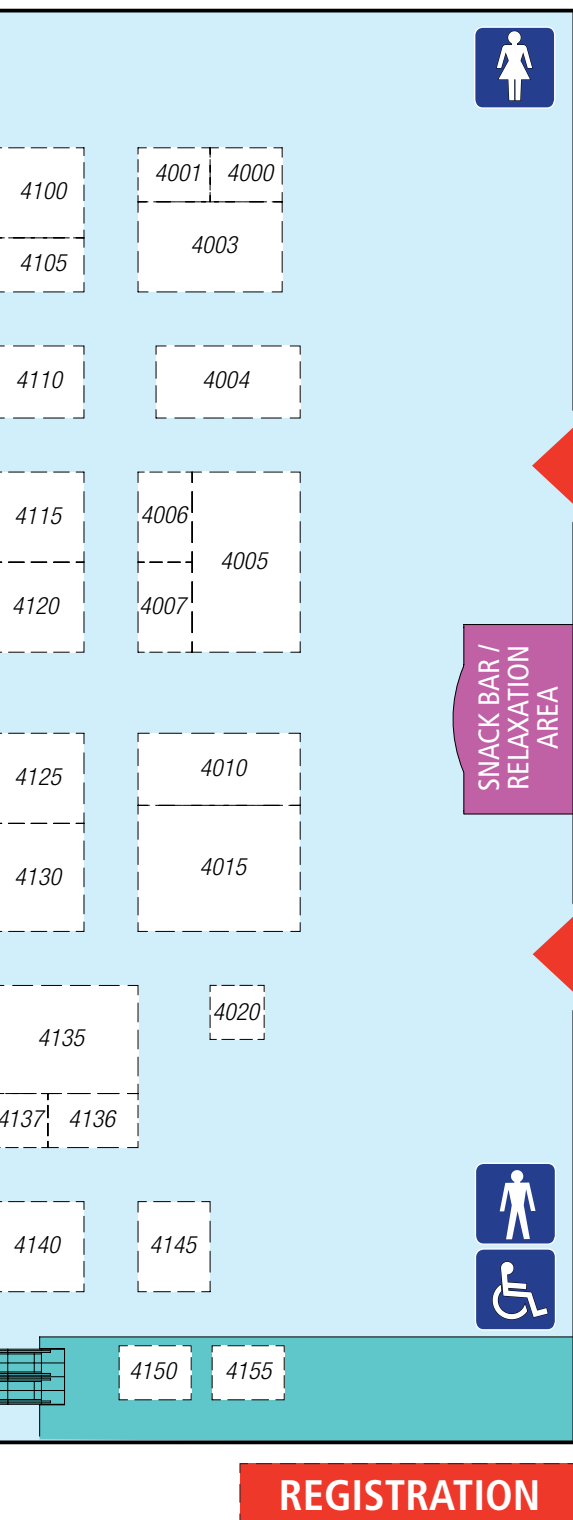

## KEY

- DELEGATE DINING
- ECO LOUNGE
- TOILETS
- ORGANIZER'S OFFICE
- TIRE TECHNOLOGY EXPO 2010
- PRESS AREA
- INTERNET AREA
- STAIRS / ESCALATORS / LIFTS
- SNACK BAR / RELAXATION AREA
- REGISTRATION

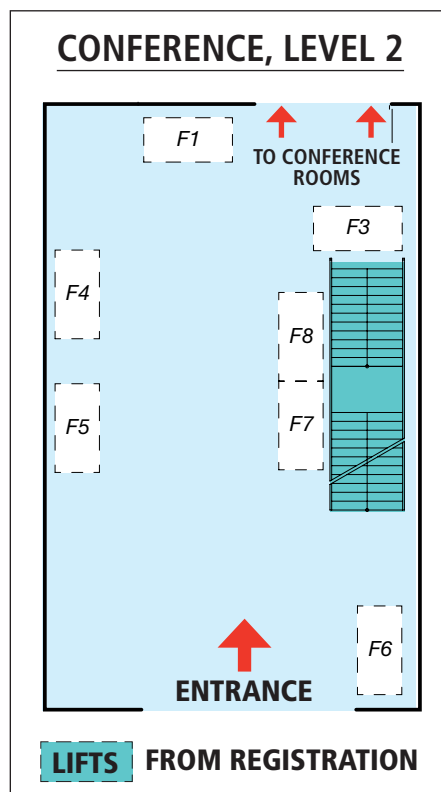

CENTRAL  
ENTRANCE

LIFTS  
TO CONFERENCE,  
LEVEL 2

# BARTELL • RMS • STEELASTIC®

## Proud of the technology we put into every tire



With the combined resources and experience of Bartell, RMS and Steelastic, the Pettibone Tire Equipment Group continues to be at the forefront of innovative new tire technology. New technology that continues to automate production, while saving valuable resources, labor and materials. And new technology that allows us to continue engineering even greater quality and reliability into our systems.

RMS is well known as a designer and manufacturer of complex rubber extrusion equipment and roller die heads, as well as first and second stage radial tire building machines. In addition, Steelastic and Bartell offer one-stop shopping for many types of tire component-making machinery systems, including bead lines, automatic apex systems, automatic bias and ply cutter systems, gum edgers, bead evaluation stations and cap strip production systems.

Look to the Pettibone Tire Equipment Group to offer unparalleled technology and service to the tire industry. With thousands of systems installed and operational world wide... Bartell, RMS and Steelastic together offer an even greater commitment to the development of quality tire component machinery, as well as tire building machinery, at substantial cost savings to our customers.

**PETTIBONE<sup>®</sup> LLC**  
**TIRE EQUIPMENT GROUP**

*Proud of the technology we put into every tire*

**Bartell Machinery Systems LLC**  
Rome NY 13440  
315-336-7600 Fax 315-336-0947  
sales@bartellmachinery.com  
www.bartellmachinery.com

**Bartell Machinery LTD**  
Telford, England:  
44-1-952-201291  
Fax 44-1-952-201083  
sales@bartellmachinery.co.uk

**The Pettibone Tire Equipment Group**  
Asia Representative Office  
4-21, Shin-Nishikata, Kuwana  
Mie, Japan 511-0863  
tisobe@steelastic.com  
www.steelastic.com

**RMS Equipment Company**  
Kitchener, Ontario, Canada N2G 4J4  
519-749-4634  
Fax 519-749-4613  
rmssales@rmsequip.com  
www.rms-ca.com

**The Steelastic Company**  
Akron OH 44310  
330-633-0505  
Fax 330-633-0527  
sales@steelastic.com  
www.steelastic.com





# Let your conveyor be a source of *profit*.

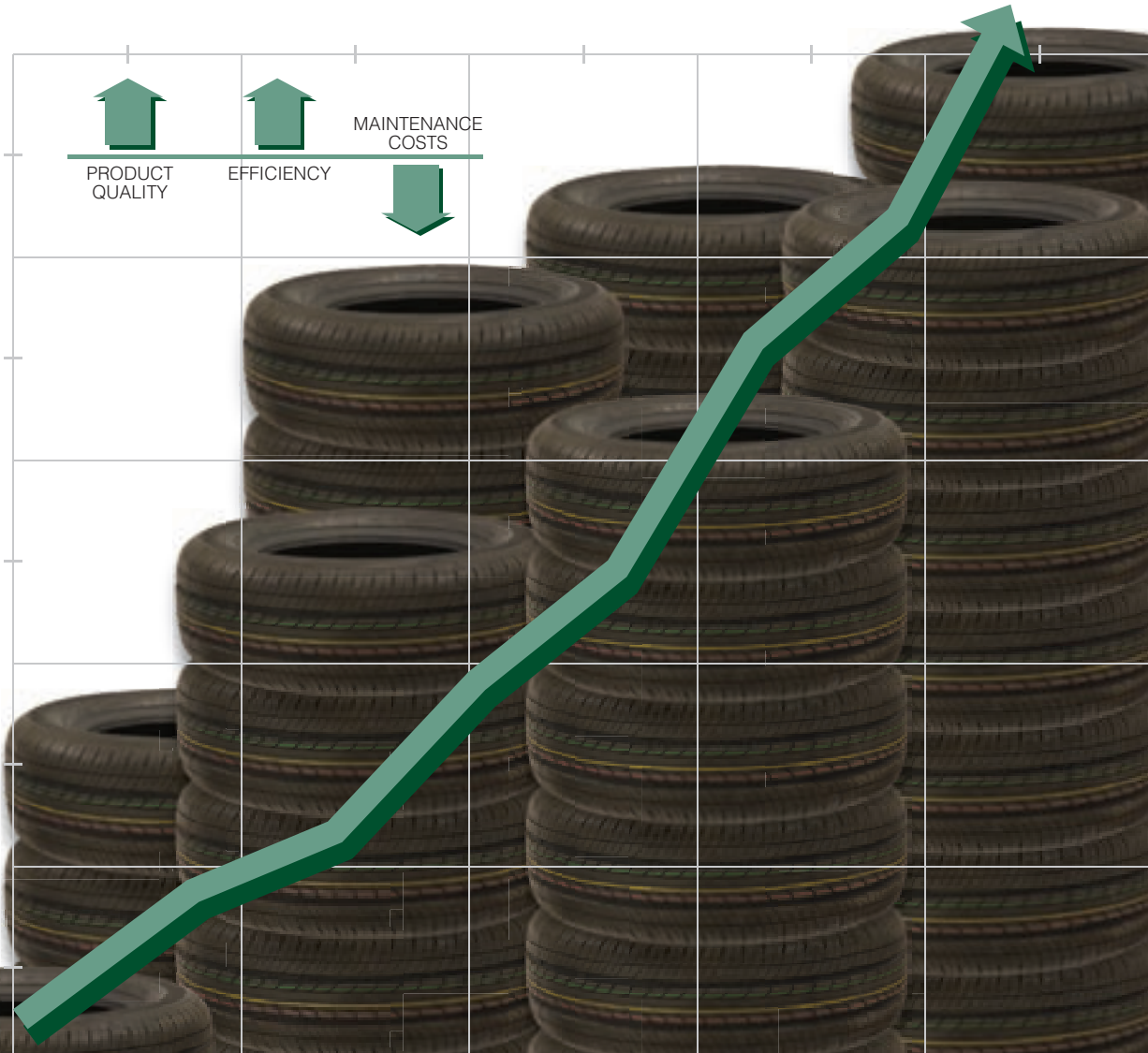

At Intralox, we use innovative problem-solving to optimize conveyance in your plant and deliver solutions proven to reduce maintenance and unscheduled downtime. Our commitment to the industry is to bring meaningful economic value to each customer and provide the global support and guarantees to ensure complete success.

Please contact the tire team to calculate the savings in your conveyors.  
[www.intralox.com](http://www.intralox.com).



A photograph showing industrial machinery used in tire manufacturing, with yellow and blue components and a control panel visible.

# Welcome to Tire Technology Expo 2009

**T**ire Technology Expo welcomes you to the fantastic city of Hamburg, and I am delighted to be able to report that, despite the global economic turmoil, the industry's most important annual exhibition and conference has once again hit new records. There are more exhibitors with us this year than ever before, and the total program of conferences and other events gives us the right to say that it is 'Bigger and Better Again'! We are also hosting the Akron Tire Mechanics Short Course, which adds yet another significant dimension to the event, and a further opportunity for tire designers to benefit from the incredible pool of knowledge that has been built up by the University of Akron.

As in previous years, by looking into our crystal ball based on our pre-registered visitor data and including those who will be participating in the Tire Technology Expo Conference and the University of Akron Tire Mechanics Short Course, we are expecting to see directors and senior executives from some 50 countries, and attendees from more than half of the world's leading tire makers. As was the case last year, once again there is a specially arranged delegation arriving from around 20 Chinese tire manufacturing companies, which will further contribute to making Tire Technology Expo 2009 a really useful and cost-effective business development and networking event. And that, most of all, is what we want to achieve for our visitors, exhibitors, and conference delegates alike.

This year, Tire Technology Expo will host our third Gala Dinner, where we will be presenting the Tire Technology International Awards for Innovation and Excellence 2009. These prestigious awards have been organized in association with *Tire Technology International* magazine. The dinner is free-to-attend for all conference delegates and for all exhibitors and their selected guests, as well as for those people who are attending Tire Technology Expo as part of our VIP program. If you have not yet received your invitation, please see a member of the Organizing Team.

As always, it is with great pride that we stage this exhibition and conference, and I sincerely hope that everyone who attends will gain a great deal from their participation.

**Tony Robinson**  
**Founder, Tire Technology Expo**  
**CEO, UKIP Media & Events Ltd**

## OPENING HOURS

Tuesday, 17 February  
10.00 – 17.00 hrs

Wednesday, 18 February  
10.00 – 17.00 hrs

Thursday, 19 February  
10.00 – 15.00 hrs

## EXHIBITION ENTRY

If you have pre-registered to visit the exhibition and have received your entry badge, you may on arrival proceed directly into the exhibition halls. If you have not pre-registered, you will be required to fill out a visitor registration form on arrival. You will then receive your official entry badge. Please keep it for use on subsequent days at the show.

# HERZLICH WILLKOMMEN

Die Tire Technology Expo lädt Sie in die herrliche Stadt Hamburg ein und ich darf Ihnen mit großer Freude mitteilen, dass, trotz der weltweit angeschlagenen Wirtschaft, die in der Branche wichtigste jährliche Fachmesse mit Konferenz wieder einmal neue Rekorde aufgestellt hat. Noch nie haben sich so viele Aussteller angemeldet, wie in diesem Jahr. Und angesichts des gesamten Konferenzprogramms, einschließlich spezieller Veranstaltungen, können wir mit Recht sagen: die Messe ist 'größer und besser als jemals zuvor'! In diesem Jahr haben wir die Universität Akron zu Gast, die auf der Messe einen Lehrgang zur Reifenmechanik anbietet, was zweifellos einen weiteren Höhepunkt der Veranstaltung darstellt. Der Kurs ist auch für Reifendesigner eine ausgezeichnete Gelegenheit, vom unglaublichen Wissensreservoir der Universität Akron zu profitieren.

Angesichts der Besucher, die sich bereits registriert haben, einschließlich der Teilnehmer an der Tire Technology Expo Konferenz und dem Lehrgang in Reifenmechanik der Universität Akron, verspricht ein Blick in unsere Kristallkugel - genau wie in den Vorjahren - den Besuch einer Vielzahl an Direktoren und Geschäftsleitungs-Mitgliedern aus ca. 50 Ländern sowie von Mitarbeitern von mehr als der Hälfte der weltweit führenden Reifenhersteller. Wie im vergangenen Jahr wird auch zur Messe 2009 eine eigens zusammengestellte Delegation aus China anreisen. Die Vertreter von rund 20 reifenherstellenden Unternehmen tragen ihren Teil dazu bei, dass die Tire Technology

Expo 2009 zu dem wird, was die Fachleute so an ihr schätzen: Eine Veranstaltung, von der die Teilnehmer profitieren, kostengünstig ihre Geschäftsentwicklung fördern und Netzwerke aufbauen können. Und genau das wollen wir unseren Besuchern, Ausstellern und Konferenzteilnehmern in allererster Linie bieten.

In diesem Jahr erleben Sie auf der Tire Technology Expo unser drittes Galadiner, bei dem wir die 'Tire Technology International Awards for Innovation and Excellence 2009' präsentieren. Die Verleihung dieser angesehenen Auszeichnungen wird in Zusammenarbeit mit der Fachzeitschrift Tire Technology International veranstaltet. Das Galadiner ist kostenlos für alle Konferenzteilnehmer und Aussteller und deren ausgewählte Gäste sowie für die Besucher der Tire Technology Expo im Rahmen unseres VIP-Programms. Um sich Ihren Platz beim Diner zu reservieren, antworten Sie bitte auf Ihre Einladung. Wenn Sie noch keine Einladung erhalten haben, setzen Sie sich bitte mit einem Mitglied des Veranstalter-Teams in Verbindung.

Wie immer sind wir stolz darauf, diese Messe mit Konferenz zu veranstalten und ich hoffe sehr, dass alle Teilnehmer viel von Ihrem Besuch mit nach Hause nehmen.

**Tony Robinson**  
**Gründer der Tire Technology Expo**  
**Vorstandsvorsitzender UKIP Media & Events Ltd**

# BIENVENUE

Le salon Tire Technology Expo vous accueille dans la fantastique ville de Hambourg et malgré les perturbations économiques mondiales, j'ai le plaisir de vous annoncer qu'en tant que plus important salon-conférence du secteur, celui-ci a une fois de plus battu des records. Les exposants sont cette année plus nombreux que jamais et le programme de conférences et d'événements nous permet de déclarer à juste titre que nous avons une fois de plus frappé fort ! Nous accueillons également l'Akron Tire Mechanics Short Course (Cours accéléré de mécanique appliquée aux pneumatiques d'Akron) qui ajoute une dimension supplémentaire à l'événement et offre aux concepteurs de pneumatiques une nouvelle opportunité de bénéficier de l'incroyable mine de connaissances accumulée par l'université Akron.

Comme pour les éditions précédentes, l'analyse des préinscriptions visiteurs et de la participation à la conférence Tire Technology Expo et à l'University of Akron Tire Mechanics Short Course (Cours accéléré de mécanique appliquée aux pneumatiques de l'université Akron) nous permet d'annoncer la présence de directeurs et de cadres supérieurs en provenance de plus de 50 pays, de même que la participation de visiteurs représentant plus de la moitié des principaux fabricants mondiaux de pneumatiques. Comme ce fut le cas l'année dernière, une délégation spéciale de quelques 20 producteurs chinois de pneumatiques sera présente, contribuant encore à faire du salon

Tire Technology Expo 2009 un événement véritablement utile et rentable pour le développement de vos activités et l'établissement de contacts. Et c'est là précisément ce que nous nous efforçons avant tout d'offrir à nos visiteurs, exposants et conférenciers.

Le salon Tire Technology Expo accueillera cette année notre troisième dîner de gala, où seront présentés les Tire Technology International Awards for Innovation and Excellence 2009. Ces prestigieuses récompenses ont été organisées en association avec le magazine Tire Technology International. Le dîner est gracieusement offert à tous les conférenciers ainsi qu'aux exposants et leur sélection d'invités, de même qu'aux personnes qui assistent au salon Tire Technology Expo dans le cadre de notre programme VIP. Pour réserver votre place à ce dîner, vous devez répondre à votre invitation. Si vous n'avez pas encore reçu votre invitation, veuillez vous adresser à un membre de l'équipe organisatrice.

Comme toujours, nous sommes extrêmement fiers d'organiser ce salon-conférence, et j'espère sincèrement que chacun pourra bénéficier au maximum de sa participation à l'événement.

**Tony Robinson**  
**Fondateur du salon Tire Technology Expo**  
**PDG, UKIP Media & Events Ltd**



**EUROPE'S LEADING INTERNATIONAL TIRE DESIGN AND  
TIRE MANUFACTURING EXHIBITION AND CONFERENCE**

# **tire** technology **EXPO 2010**

**9, 10 & 11 February 2010**  
**Köln (Cologne) Messe, Germany**

**BOOK YOUR STAND  
NOW FOR 2010**

**VISIT STAND 4706**

**[www.tiretechnology-expo.com](http://www.tiretechnology-expo.com)**

**Tire Technology Expo 2010**  
**UKIP Media & Events, Abinger House, Church Street, Dorking, Surrey RH4 1DF, UK**  
**Tel: +44 (0)1306 743744 Fax: +44 (0)1306 877411 Email: [c.scott@ukintpress.com](mailto:c.scott@ukintpress.com)**

## Valves for Curing Presses

For more than 35 years AIRTEC's ROCKY piston valves, process valves and steam regulators have been used all over the world.

- ▶ **One valve for multiple applications**  
(steam, hot/cold water, air, inert gases)
- ▶ **Maximum operating pressure 32 bar**
- ▶ **High durability**
- ▶ **Temperature range**  
– 30 °C ... + 230 °C
- ▶ **Easy to maintain**
- ▶ **Special panel systems**

AIRTEC Controls GmbH  
Westerbachstrasse 7  
61476 Kronberg  
Germany  
Phone +49 61 73 95 62-0  
Fax +49 61 73 95 62-77

Email: [info@airtec.de](mailto:info@airtec.de)  
Internet: [www.airtec-controls.de](http://www.airtec-controls.de)



## There's one reliable stop for all your belting needs

Trust Habasit as the global leader in belting –  
Your solution provider across all tire-making processes.



**Tire Technology Expo 2009**  
**Hall A1, Stand 4010**

[www.habasit.com](http://www.habasit.com)  
E-mail [info@habasit.com](mailto:info@habasit.com)

Habasit – Solutions in motion



# WHO TO SEE AT TIRE TECHNOLOGY EXPO

Company	Stand Number	Company	Stand Number	Company	Stand Number
01dB-Metravib	<b>F1</b>	Gabo Qualimeter Testanlagen GmbH	<b>F4</b>	Parker Hannifin GmbH + Co KG	<b>4100</b>
4Jet Laser Systeme Service GmbH	<b>4005</b>	GEPOC Gesellschaft Fuer		Pelmar Engineering Germany	<b>4350</b>
A.M.A. S.p.A	<b>4427</b>	Polymerchemie mbH	<b>4325</b>	Pomini Rubber & Plastics Srl	<b>4001</b>
AB Svenskt Konstsilke	<b>4007</b>	GFA De Pryck + Co	<b>4210</b>	Prodicon International Srl	<b>4310</b>
AIRTEC Controls GmbH	<b>4521</b>	Gislotica,Lda	<b>4344</b>	Qingdao Mesnac Co., Ltd	<b>4245</b>
Alfautomazione SpA	<b>4136</b>	Glebus Alloys LLC	<b>4349</b>	Rhodia Operations, SAS	<b>4140</b>
ALLIGATOR Ventilfabrik GmbH	<b>4470</b>	Glebus Alloys Sro	<b>4349</b>	RJS Corporation	<b>4430</b>
Alpha Technologies U.K.	<b>F6</b>	Gudel AG	<b>4420</b>	RMS Equipment Company	<b>4004</b>
Ammeraal Beltech Holding BV	<b>4130</b>	Habasit AG	<b>4010</b>	RMT Robotics Ltd	<b>4360</b>
APV Engineered Coatings	<b>4145</b>	Hagglunds Drives AB	<b>4220</b>	Rockwell Automation	<b>4730</b>
Attrezzeria Pagliari	<b>4427</b>	Harburg-Freudenberger		Rodolfo Comerio Snc	<b>4562</b>
A-Z Formen-und-Maschinenbau GmbH	<b>4425</b>	Maschinenbau GmbH		Rubber Point s.r.o.	<b>4245</b>
Bainite Machines Pvt. Ltd	<b>4760</b>	Herbert Maschinenbau GmbH & Co	<b>4550</b>	Samson Machinery Inc	<b>4340</b>
Bartell Machinery Ltd	<b>4004</b>	HIROTEK Inc	<b>4530</b>	Schill + Seilacher Struktol	
Bartell Machinery Systems LLC	<b>4004</b>	HOFMANN Maschinen-und		Aktiengesellschaft	<b>F3</b>
Beckhoff Automation GmbH	<b>4415</b>	Anlagenbau GmbH	<b>4523</b>	SDS Systemtechnik	<b>4260</b>
Betacontrol GmbH & Co. KG	<b>4315</b>	IKS KlingelInberg GmbH	<b>4265</b>	Seichter GmbH	<b>4450</b>
Brandenburger Isoliertechnik GmbH & Co	<b>4230</b>	Ilmberger GmbH	<b>4412</b>	Sigmavision Ltd	<b>4335</b>
BST International GmbH	<b>4115</b>	Indspec Chemical BV	<b>4006</b>	Simulia	<b>F8</b>
Buzuluk Komarov A.S.	<b>4205</b>	Intereuropean Srl	<b>4445</b>	SNE Deshors Moulage	<b>4346</b>
Bytewise Measurement Systems Inc	<b>4110</b>	Intralox, LLC Europe	<b>4345</b>	Standards Testing Labs	<b>4260</b>
Calemard S.A	<b>4000</b>	JoVision	<b>4565</b>	Steinbichler Optotechnik GmbH	<b>4484</b>
Carter International Ltd	<b>4462</b>	Kara Gostar Eng. Co.	<b>4515</b>	Systraplan GmbH & Co KG	<b>4137</b>
China United Rubber Corporation	<b>4400</b>	Kobelco Stewart Bolling Inc	<b>4432</b>	TARRC/Rubber Consultants	<b>4348</b>
Cima Impianti Spa	<b>4404</b>	Kom-Tron Systemtechnik	<b>4406</b>	Texkimp Ltd	<b>4560</b>
Cimcorp Oy	<b>4535</b>	Konstrukta - Industry, a.s.	<b>4135</b>	The Poling Group	<b>4240</b>
Cold Testing Lapland	<b>4725</b>	KraussMaffei Berstorff GmbH	<b>4015</b>	The Steelastic Company	<b>4004</b>
Collmann GmbH & Co		Kurschat GmbH	<b>4217</b>	Tien Sheng Molding Tech. Inc. (TSM)	<b>4330</b>
Spezialmaschinebau KG	<b>4120</b>	Lang GmbH & Co KG	<b>4451</b>	Tire Curing Bladders, L.L.C.	<b>4472</b>
Comerio Ercole SpA	<b>4710</b>	LAP GmbH	<b>4408</b>	<b>Tire Technology Expo 2010</b>	<b>4706</b>
Continental AG Conti Bladders	<b>4750</b>	Laser-Med GmbH	<b>4150</b>	<b>Tire Technology International</b>	<b>4706</b>
Continental AG Conti Machinery	<b>4750</b>	Leonhard Breitenbach GmbH	<b>4686</b>	TIS GmbH & Co KG	<b>4410</b>
Cybernetix	<b>4555</b>	Marangoni Meccanica SpA	<b>4520</b>	Troester GmbH & Co KG	<b>4735</b>
Dahmen GmbH	<b>4005</b>	Marbo Italia S.p.A	<b>4325</b>	TS Plzen a.s.	<b>4238</b>
Data2 Corporation	<b>4344</b>	Marbocote Ltd	<b>4325</b>	UTH GmbH	<b>4600</b>
DOLI Elektronik GmbH	<b>F7</b>	Matteuzzi Srl	<b>4105</b>	UZER MAKINA ve Kalip Sanayii A.S	<b>4464</b>
Dr Noll GmbH	<b>4755</b>	McNeil & NRM Inc	<b>4435</b>	Vanderlande Industries Nederland B.V	<b>4242</b>
Dr. Dirk Wehrhahn Measuring Systems For Quality Assurance	<b>4315</b>	MEZSERVIS spol. S.r.o.	<b>4200</b>	VIPO, a.s.	<b>4135</b>
Electronic Systems SpA	<b>4707</b>	MGT Srl	<b>4500</b>	VMI Holland BV	<b>4715</b>
Elisto GmbH	<b>4155</b>	Micro-Epsilon Messtechnik GmbH & Co KG	<b>4003</b>	WD Racing Ltd	<b>4470</b>
Erhardt & Leimer GmbH	<b>4720</b>	Micro-Poise Measurement Systems LLC	<b>4125</b>	Werba-Chem GmbH	<b>F5</b>
Farrel Limited	<b>4320</b>	Mitsubishi International GmbH	<b>4005</b>	Wyko Tire Technology Ltd	<b>4440</b>
Federal-Mogul Deva GmbH	<b>4576</b>	Muench Chemie International GmbH	<b>4235</b>	Yxlon International X-Ray GmbH	<b>4355</b>
Firestone Industrial Products	<b>4402</b>	Nakata Engineering Co. Ltd	<b>4440</b>	Zeppelin Silos & Systems GmbH	<b>4365</b>
		NDC Infrared Engineering Ltd	<b>4020</b>	ZF Passau GmbH	
		Necumer Product GmbH	<b>4215</b>	(ZF Friedrichshafen AG)	<b>4505</b>
		Oerlikon Textile GmbH & Co. KG	<b>4455</b>	Z-Laser Optoelektronik GmbH	<b>4468</b>

# EXHIBITOR LISTINGS – BY STAND NUMBER

## Stand Number Company

<b>4000</b>	Calemard S.A
<b>4001</b>	Pomini Rubber & Plastics Srl
<b>4003</b>	Micro-Epsilon Messtechnik GmbH & Co KG
<b>4004</b>	Bartell Machinery Ltd
<b>4004</b>	Bartell Machinery Systems LLC
<b>4004</b>	RMS Equipment Company
<b>4004</b>	The Steelastic Company
<b>4005</b>	4Jet Laser Systeme Service GmbH
<b>4005</b>	Dahmen GmbH
<b>4005</b>	Mitsubishi International GmbH
<b>4006</b>	Indspec Chemical BV
<b>4007</b>	AB Svenskt Konstsilke
<b>4010</b>	Habasit AG
<b>4015</b>	KraussMaffei Berstorff GmbH
<b>4020</b>	NDC Infrared Engineering Ltd
<b>4100</b>	Parker Hannifin GmbH + Co KG
<b>4105</b>	Matteuzzi Srl
<b>4110</b>	Bytewise Measurement Systems Inc
<b>4115</b>	BST International GmbH
<b>4120</b>	Collmann GmbH & Co Spezialmaschinebau KG
<b>4125</b>	Micro-Poise Measurement Systems LLC
<b>4130</b>	Ammeraal Beltech Holding BV
<b>4135</b>	Konstrakta - Industry, a.s.
<b>4135</b>	VIPO, a.s.
<b>4136</b>	Alfautomazione SpA
<b>4137</b>	Systraplan GmbH & Co KG
<b>4140</b>	Rhodia Operations, SAS
<b>4145</b>	APV Engineered Coatings
<b>4150</b>	Laser-Med GmbH
<b>4155</b>	Elisto GmbH
<b>4200</b>	MEZSERVIS spol. S.r.o.
<b>4205</b>	Buzuluk Komarov A.S.
<b>4210</b>	GFA De Pryck + Co
<b>4215</b>	Necumer Product GmbH
<b>4217</b>	Kurschat GmbH
<b>4220</b>	Hagglunds Drives AB
<b>4225</b>	Harburg-Freudenberger Maschinenbau GmbH
<b>4230</b>	Brandenburger Isoliertechnik GmbH & Co
<b>4235</b>	Muench Chemie International GmbH
<b>4238</b>	TS Plzen a.s.
<b>4240</b>	The Poling Group
<b>4242</b>	Vanderlande Industries Nederland B.V

<b>4245</b>	Qingdao Mesnac Co., Ltd
<b>4245</b>	Rubber Point s.r.o.
<b>4260</b>	SDS Systemtechnik
<b>4260</b>	Standards Testing Labs
<b>4265</b>	IKS Klingelberg GmbH
<b>4310</b>	Prodicon International Srl
<b>4315</b>	Betacontrol GmbH & Co. KG
<b>4315</b>	Dr. Dirk Wehrhahn Measuring Systems For Quality Assurance
<b>4320</b>	Farrel Limited
<b>4325</b>	GEPOC Gesellschaft Fuer Polymerchemie mbH
<b>4325</b>	Marbo Italia S.p.A
<b>4325</b>	Marbocote Ltd
<b>4330</b>	Tien Sheng Molding Tech. Inc. (TSM)
<b>4335</b>	Sigmavision Ltd
<b>4340</b>	Samson Machinery Inc
<b>4344</b>	Data2 Corporation
<b>4344</b>	Gislotica,Lda
<b>4345</b>	Intralox, LLC Europe
<b>4346</b>	SNE Deshors Moulage
<b>4348</b>	TARRC/Rubber Consultants
<b>4349</b>	Glebus Alloys Sro
<b>4349</b>	Glebus Alloys LLC
<b>4350</b>	Pelmar Engineering Germany
<b>4355</b>	Yxlon International X-Ray GmbH
<b>4360</b>	RMT Robotics Ltd
<b>4365</b>	Zeppelin Silos & Systems GmbH
<b>4400</b>	China United Rubber Corporation
<b>4402</b>	Firestone Industrial Products
<b>4404</b>	Cima Impianti Spa
<b>4406</b>	Kom-Tron Systemtechnik
<b>4408</b>	LAP GmbH
<b>4410</b>	TIS GmbH & Co KG
<b>4412</b>	Ilmberger GmbH
<b>4415</b>	Beckhoff Automation GmbH
<b>4420</b>	Gudel AG
<b>4425</b>	A-Z Formen-und-Maschinenbau GmbH
<b>4427</b>	Attrezzzeria Pagliari
<b>4427</b>	A.M.A. S.p.A
<b>4430</b>	RJS Corporation
<b>4432</b>	Kobelco Stewart Bolling Inc
<b>4435</b>	McNeil & NRM Inc
<b>4440</b>	Nakata Engineering Co. Ltd
<b>4440</b>	Wyko Tire Technology Ltd
<b>4445</b>	Intereuropean Srl
<b>4450</b>	Seichter GmbH
<b>4451</b>	Lang GmbH & Co KG
<b>4455</b>	Oerlikon Textile GmbH & Co. KG

<b>4462</b>	Carter International Ltd
<b>4464</b>	UZER MAKINA ve Kalip Sanayii A.S
<b>4468</b>	Z-Laser Optoelektronik GmbH
<b>4470</b>	Alligator ventiltfabrik GmbH
<b>4470</b>	WD Racing Ltd
<b>4472</b>	Tire Curing Bladders, L.L.C.
<b>4484</b>	Steinbichler Optotechnik GmbH
<b>4500</b>	MGT Srl
<b>4505</b>	ZF Passau GmbH (ZF Friedrichshafen AG)
<b>4515</b>	Kara Gostar Eng. Co.
<b>4520</b>	Marangoni Meccanica SpA
<b>4521</b>	AIRTEC Controls GmbH
<b>4523</b>	HOFMANN Maschinen-und Anlagenbau GmbH
<b>4530</b>	HIROTEK Inc
<b>4535</b>	Cimcorp Oy
<b>4550</b>	Herbert Maschinenbau GmbH & Co
<b>4555</b>	Cybernetix
<b>4560</b>	Texkimp Ltd
<b>4562</b>	Rodolfo Comerio Snc
<b>4565</b>	JoVision
<b>4576</b>	Federal-Mogul Deva GmbH
<b>4600</b>	UTH GmbH
<b>4686</b>	Leonhard Breitenbach GmbH
<b>4706</b>	Tire Technology Expo 2010
<b>4706</b>	Tire Technology International
<b>4707</b>	Electronic Systems SpA
<b>4710</b>	Comerio Ercole SpA
<b>4715</b>	VMI Holland BV
<b>4720</b>	Erhardt & Leimer GmbH
<b>4725</b>	Cold Testing Lapland
<b>4730</b>	Rockwell Automation
<b>4735</b>	Troester GmbH & Co KG
<b>4750</b>	Continental AG Conti Machinery
<b>4750</b>	Continental AG Conti Bladders
<b>4755</b>	Dr Noll GmbH
<b>4760</b>	Bainite Machines Pvt. Ltd
<b>F1</b>	01dB-Metravib
<b>F3</b>	Schill + Seilacher Struktol Aktiengesellschaft
<b>F4</b>	Gabo Qualimeter Testanlagen GmbH
<b>F5</b>	Werba-Chem GmbH
<b>F6</b>	Alpha Technologies U.K.
<b>F7</b>	DOLI Elektronik GmbH
<b>F8</b>	Simulia



# INTEREUROPEAN

MILANO - ITALY

## MACHINERY & EQUIPMENT FOR THE TIRE & RUBBER INDUSTRY



TWIN SCREW EXTRUDERS & BATCH-OFF LINES

EXTRUSION LINES FOR SIDEWALLS AND TREAD

INNERLINER CALENDER LINES

CUTTER & SPlicer LINES FOR FABRIC AND STEEL CORD PLY

BEAD APERING LINES

BEAD WINDING LINES

BEAD WRAPPING & CHIPPER/FLIPPER APPLICATION LINES

PRE-ASSEMBLING LINES FOR SEMI-FINISHED PRODUCTS

GREEN TYRE PAINTING MACHINES

TYRE BUILDING MACHINES FOR PCR / LT / TRUCK & BUS / OTR TYRES

DRUMS, BLADDERS AND TOOLING FOR TYRE BUILDING MACHINES

STAND-ALONE SERVICERS, LET-OFF AND WIND-UP STATIONS

TESTING EQUIPMENT

FULL RANGE OF MACHINERY FOR PRODUCTION OF AIR-SPRINGS

UPGRADE & MODERNIZATION OF EXISTING MACHINERY & EQUIPMENT

QUALITY CONSULTING SERVICES



**INTEREUROPEAN S.R.L.**

VIA DELLA MOIA, 1

20020 ARESE (MI)

MILANO, ITALY

PHONE: (+39) 02 9384351

FAX: (+39) 02 93582520

E-MAIL: [INFO@INTEREUROPEAN.IT](mailto:INFO@INTEREUROPEAN.IT)

INTERNET: [HTTP://WWW.INTEREUROPEAN.IT](http://WWW.INTEREUROPEAN.IT)



## USEFUL INFORMATION

### Organizer's office

If you require assistance in finding your way around the Expo, the organizer's office is located at the rear of Hall A1 on stand number 4602. Alternatively visit the Tire Technology Expo 2009 stand 4706 where booths for 2010 can be booked

ORGANIZER'S OFFICE → STAND 4602

### Press area

Members of the press will be given free access to the exhibition and conference on production of their press credentials. A press area located next to the organizer's office at the rear of the hall will be available throughout the exhibition where members of the press can read up on exhibitor news. Please contact the organizer's office for complimentary business facilities.

### Conference information

The 2009 conference program once again brings together more than 100 experts from many of the world's leading research establishments and centres of excellence. This year's packed program will be opened by Dr Dieter Freitag, general director, Michelin Germany.

Presentations on tire technology versus increasing costs and performance regulations will be the opening highlight, with further sessions discussing manufacturing technologies, the virtual tire-learning from tire property predictions, increased value from compounding additives, material innovations, regulations, cord advances, tire properties. Plus this year there is a session on the TYROSAFE project and partner sessions with TAARC and the BTMA. 2009 welcomes the return of the Akron University Tire Mechanics Short Course which will run parallel to the conference. Tutored by renowned experts this four-day educational and development course, commencing on February 16, will provide engineers and scientists with an in-depth intense study of developments surrounding tire engineering.

→ SEE CONFERENCE INFORMATION ON PAGE 13



### Snack bar and dining

A snack bar and relaxation area is available at the front of the hall. VIP and Delegate Dining is located at the rear of the hall and is accessed on production of a pass.

### Business services

Complimentary business services are available at the Organizer's office in Hall A1.

## Tire Technology Awards 2009

The 2009 Tire Technology Awards for Innovation and Excellence will be presented at the Gala Dinner being held at the prestigious Grand Elysee Hotel in Hamburg on Wednesday, 18 February. The evening presents a unique networking opportunity in luxurious surroundings with delicious food, wine and top entertainment.

More than 500 tire industry professionals will be present to see the awards presented live in the world's biggest celebration of tire excellence. The awards are organized in association with the magazine *Tire Technology International*, a publication of UKIP Media & Events, who are the sponsors of this year's Gala Dinner and Awards Ceremony.



## What to do in Hamburg

What are the first things that come to mind when you think of Hamburg? Probably the city's stunning location on the Elbe and Alster Rivers, the colourful activity in the St. Pauli entertainment district, unforgettable musicals, a night at the theatre, Michaelis Church (colloquially 'der Michel') or the impressive harbour.

Hamburg, which is 1,200 years old, is loved both for its contemporary scene as well as for its cultural offerings. In between traditional trading houses and renowned theatres, the latest trends are always cropping up.

Website: [www.english.hamburg.de](http://www.english.hamburg.de)

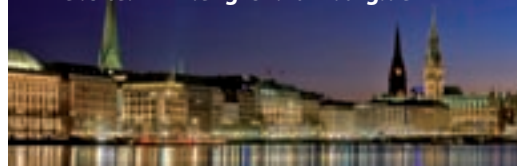

## Accessibility

Hall A1 is on the ground level and is fully accessible. The conference area is accessible by lift. For further assistance please ask a member of the organizing team.

## Tire Technology International

**Tire Technology International** is the leading international publication dedicated to tire design, materials and manufacturing technology. With editorial support from respected research institutes and advertising support from every leading supplier of tire manufacturing equipment and materials, it is a vital resource for tire manufacturing experts everywhere. Visit stand 4706 for more information.



TIRE TECHNOLOGY STAND → 4706

# tire

technology  
INTERNATIONAL

## ***Tire Technology International***

is the world's leading international publication exclusively concerned with tire design, tire materials and tire manufacturing technology.

*Tire Technology International* is distributed into 80 countries free of charge on an individually named basis to senior executives and managers responsible for operations and capital investment programs.

# tire

technology  
INTERNATIONAL

NOVEMBER 2008

## **AUTOMATION**

Automation technology for tire production

## **RESEARCH AND DEVELOPMENT**

Why now is the time to invest in research

## **ACTIVE WHEEL**

Take a look inside Michelin's innovative tire/wheel design

# Natural science

The natural world may hold the key to future reinforcing materials **PLUS** The latest TKS research could solve the global natural rubber problem

## **INTERVIEWS**

Guy Edington  
Standards Testing Labs

Dr Andy Chapman  
Tun Abdul Razak Research Centre

Dr Lei Jong  
US Department of Agriculture

Professor Michael Ellison  
Clemson University

Dr Nikolaj Bogatyrev  
University of Bath

[www.ukipme.com](http://www.ukipme.com)

Pick up  
your free copy  
on stand no. 4706

To obtain a regular free copy of Tire Technology International, or to find out more about advertising within a future issue, contact:

Colin Scott, UKIP Media & Events Ltd, Abinger House, Church Street, Dorking, Surrey, RH4 1DF, UK.

Tel: +44 (0) 1306 743744 Fax: +44 (0) 1306 742525 Email: [c.scott@ukintpress.com](mailto:c.scott@ukintpress.com)



# TIRE TECHNOLOGY EXPO CONFERENCE

Now in its ninth year, **Tire Technology Expo** is Europe's most important tire design and manufacturing technology exhibition and conference, with some 130 exhibiting companies. Tire Technology Expo 2009 offers the visitor a technology showcase covering materials and equipment through the complete spectrum of the tire design and manufacturing process. Tire Technology Expo 2009 also offers visitors, exhibitors, and conference delegates an unrivalled networking opportunity within the tire design and manufacturing sector.

## SESSIONS AT A GLANCE

### DAY 1

SESSION 1: **TIRE TECHNOLOGY VERSUS INCREASING COSTS AND PERFORMANCE REGULATIONS**

SESSION 2: **MANUFACTURING TECHNOLOGIES**

SESSION 3: **THE VIRTUAL TIRE: LEARNING MORE FROM TIRE PROPERTY PREDICTIONS**

SESSION 4: **GETTING INCREASED VALUE FROM TIRE COMPOUNDING ADDITIVES**

### DAY 2

SESSION 1: **TIRE MATERIAL INNOVATIONS**

SESSION 2: **TIRE REGULATIONS: A FORCE FOR PROGRESS OR A FARCE?**

SESSION 3: **THE VIRTUAL TIRE: LEARNING MORE FROM TIRE PROPERTY PREDICTIONS (CONTINUED)**

SESSION 4: **CORD ADVANCES**

SESSION 5: **THE TYROSAFE PROJECT**

SESSION 6: **UNDERSTANDING TIRE PROPERTIES**

### DAY 3

SESSION 1: **THE INTELLIGENT TIRES' ROLE IN VEHICLE ELECTRONIC SYSTEMS**

SESSION 2: **NATURAL RUBBER: THE EVOLVING POLYMER**

SESSION 3: **CONSEQUENCES FOR TIRES OF THEIR MORE COMPLEX LIFESTYLE AND LONGER LIFE POTENTIAL**

## DAY 1 SESSION 1

TUESDAY 17 FEBRUARY 2009

### TIRE TECHNOLOGY VERSUS INCREASING COSTS AND PERFORMANCE REGULATIONS

**09.00 – 09.15** OPENING ADDRESS

Dieter Freitag, general director, Michelin Germany

**09.15 – 09.45** TPMS AND LEGAL REQUIREMENTS – THEORY AND PRACTICE OF TESTABILITY

Joerg Sturmhoebel, Audi/Nira Dynamics and Victor Underberg, Audi

**09.45 – 10.15** THE FUTURE OF INDIRECTLY MEASURING TPMS

Bernd Schuchhardt, Dunlop-Tech

**10.15 – 10.45** THE TREAD ACT – A LOOK BACK AND A LOOK FORWARD

Mike Wischhusen, Michelin North America

**10.45 – 11.05** MORNING BREAK

**11.05 – 11.35** HOW WILL THE NEW REGULATORY FRAMEWORK SHAPE THE TIRE MARKET FROM 2012?

Mrs F. Cinaralp, ETRMA

**11.35 – 12.05** TIRE TECHNOLOGY TRENDS DRIVEN BY COST AND REGULATIONS

Dr Christoph Bederna, Continental

**12.05 – 12.35** THE HISTORY OF RUNFLAT TIRES

Bernd Loewenhaupt, Goodyear Dunlop Tires Germany

**12.35 – 13.05** CONTINENTAL TIRES AND TIRE ELECTRONICS TECHNOLOGY

Peter Saeger, Continental

**13.05 – 14.00** LUNCH

**14.00 – 14.30** INDUSTRY FOCUS ON ROLLING RESISTANCE: WHERE TO MAKE THE TRADE-OFFS?

Pim van der Jagt, Ford

**14.30 – 15.00** TIRE ROLLING RESISTANCE REDUCTION BY NANOSTRUCTURE-ORIENTED PROPERTIES CONTROL TECHNOLOGY

Keizo Akutagawa, Bridgestone Technical Centre Europe

**15.00 – 15.30** TIRE PASS-BY NOISE REDUCTION BY USING SLOT RESONATORS

Shu Fujiwara, Bridgestone Technical Centre Europe

**15.30 – 16.00** UNIFORMITY – A CRUCIAL ATTRIBUTE OF TIRE/WHEEL ASSEMBLIES

Marion G. Pottinger, M<sup>2</sup>Engineering (presented by Dr Roger Williams)

**16.00 – 16.20** AFTERNOON BREAK

**16.20 – 16.50** DEVELOPMENT OF A COMPOSITE WHEEL – THE LATEST ACHIEVEMENTS

Prof. Ulf Sandberg, VTI (Swedish National Road & Transport Research Inst)

**16.50 – 17.20** CONTINUOUS MOBILITY – DEVELOPING A NON-PNEUMATIC TIRE (NPT) FOR 21ST-CENTURY MILITARY VEHICLES

Michael Tercha and Ed Hall, Resilient Technologies

**17.20 – 17.50** NATURAL RUBBER PRODUCTIVITY: SOCIO-ECONOMIC PERSPECTIVES

Dr Abdul Aziz S A Kadir

## DAY 1 SESSION 2

TUESDAY 17 FEBRUARY 2009

### MANUFACTURING TECHNOLOGIES

**10.00 – 10.20** LASER MATERIAL PROCESSING IN THE TIRE INDUSTRY – APPLICATION OVERVIEW

Joerg Jetter, 4Jet Sales & Service

**10.20 – 10.40** NEW PC APEXER FROM CONTI MACHINERY

František Pilný, Continental Matador Rubber

**10.40 – 11.00** HIGH-SPEED CALENDER LINES FOR TIRE INDUSTRIES. DEVELOPMENTS OF AUTOMATIC WINDING EQUIPMENT

Renato Lualdi, Comero Ercole

**11.00 – 11.20** MAS400 – THE NEW COST-EFFECTIVE AND TAILOR-MADE SOLUTION FOR TIRE BARCODE READING PROCESS OFFERING HIGHEST READ RATES

Ralf Weisser, Datalogic Automation

**11.20 – 11.40** TIRE CONTOUR MEASUREMENT BY SHEET OF LIGHT

Dr Oliver Scholz, Fraunhofer Institut für Integrierte Schaltungen

**11.40 – 12.00** GABOTACK – THE TACKINESS TESTER FOR THE TIRE INDUSTRY. DETERMINATION OF THE TACKINESS OF GREEN TIRES

Herbert Halm, GABO Qualimeter

**12.00 – 14.00** LUNCH

**14.00 – 14.20** NEW ROTOR TECHNOLOGY – ADVANCED ROTOR DESIGNS

Richard J Jorkasky II and Norifumi Yamada, Kobelco  
Stewart Bolling

**14.20 – 14.40** STATISTICAL TOOLS IN AN ANALYTICAL LABORATORY – CHEMOMETRY

Dr Giansante Rugo, Pelmar Engineering Group

**14.40 – 15.00** HIGH-SPEED AND COST-EFFECTIVE SHEAROGRAPHY TIRE TESTING FOR PASSENGER, TRUCK, AVIATION AND OTR TIRES

Rainer Huber, Steinbichler Optotechnik

**15.00 – 15.20** FAST SHEAROGRAPHY INSPECTION FOR NEW TIRE PRODUCTION

Roland Zehentmaier, Steinbichler Optotechnik

**15.20 – 15.40** STRAINING AND HIGH-PRESSURE EXTRUSION APPLICATIONS IN THE TIRE INDUSTRY

Winfried Trost, Uth

**15.40 – 16.00** AFTERNOON BREAK

**16.00 – 16.20** VMI MAXX: MAXIMUM PERFORMANCE IN SINGLE-STAGE TIRE BUILDING

J. K. Grashuis, VMI

**16.20 – 16.40** SPRING VENTS – NEW TECHNOLOGY

Michael Stefanidis, Glebus Alloys Europe

**16.40 – 17.00** VISUAL INSPECTION OF TIRE – EVALUATION AND IMPROVEMENT

Mohammad Zendeirooh Kermani, Barez Industrial Group

**17.00 – 17.20** APPLYING THE TIME SERIES IN ANTICIPATING THE DEFECTS IN THE TIRE INDUSTRY

Reza Farivar, Kavir Tire

**17.20 – 17.40** TIRE MANUFACTURERS IMPROVE SAFETY WITHOUT COMPROMISING PRODUCTIVITY

James Neawedde, Rockwell Automation

**DAY 1 SESSION 3**

TUESDAY 17 FEBRUARY 2009

**THE VIRTUAL TIRE: LEARNING MORE FROM TIRE PROPERTY PREDICTIONS**

SESSION ORGANIZED BY DR MIKE BLUNDELL, COVENTRY UNIVERSITY

**13.30 – 13.55** MODELING FOR OPTIMIZED WINTER TIRE PERFORMANCE

Jerome Delu, Goodyear

**13.55 – 14.20** CHALLENGE FOR AIRCRAFT TIRES

Dr Wei Ding, Dunlop Aircraft Tyres

**14.20 – 14.45** TITLE TO BE CONFIRMED

Prof Dr Peter Lugner, University of Technology, Vienna

**14.45 – 15.10** RMOD-K 7 AND MISUSE LOAD CASES

Prof. Dr Oertel, Brandenburg University

**15.10 – 15.30** AFTERNOON BREAK

**15.30 – 15.55** APPLICATION OF IMAGE PROCESSING TECHNIQUES IN THE GENERATION OF TIRE CROSS-SECTION GEOMETRY AND FE MODEL

Dr Oluremi Olatunbosun, University of Birmingham

**15.55 – 16.20** AIRCRAFT TIRE MODELING

Gary Wood, Coventry University

**16.20 – 16.45** TOWARD THE FAST AND ACCURATE SIMULATION OF IN-PLANE TRANSIENT TIRE DYNAMICS

Dr George Mavros, Loughborough University

**16.45 – 17.10** INTERPLY SHEAR STRESS PREDICTION OF DIFFERENT BELTS STRUCTURE OF A PASSENGER CAR TIRE BY A DEVELOPED FEM

Ms Mahdih Zamzamzadeh, Barez Industrial Group

**DAY 1 SESSION 4**

TUESDAY 17 FEBRUARY 2009

**GETTING INCREASED VALUE FROM TIRE COMPOUNDING ADDITIVES**

SESSION ORGANIZED BY DR LOTHAR STEGER, CONSULTANT

**13.30 – 13.55** RUBBER PROCESSING STARTS WITH MIXING: A REVIEW OF THE INDUSTRIAL SCALE MIXING PROCESS

Gerard Nijman, Vredestein Banden-Enschede

**13.55 – 14.20** NEW PLASTICIZERS – NEW ANALYTICAL CHALLENGES

Jürgen Trimbach and Tobias Wagner, Hansen & Rosenthal

**14.20 – 14.45** TIRE WET GRIP: AN INSIGHT

Massimo Cialone, Marangoni Group

**14.45 – 15.10** NON-CONVENTIONAL ACCELERATOR COMPOUNDING – A TOOL IN SILICA TECHNOLOGY?

Thomas Früh, Rhein Chemie-Mannheim

**15.10 – 15.30** AFTERNOON BREAK

**15.30 – 15.55** NEW FUNCTIONALIZED SBRS TO MEET FUTURE TIRE PERFORMANCE DEMANDS

Norbert Steinhauser and Thomas Gross, Lanxess-PBR

**15.55 – 16.20** IMPROVEMENT IN TIRE PERFORMANCE WITH NEW POLYMER-NANO-ADDITIVES

Lothar Steger, consultant

**16.20 – 16.45** PROCESSING BEHAVIOR OF HIGH-CIS POLYBUTADIENES IN RUBBER COMPOUNDS HIGHLIGHTING NEODYMIUM POLYBUTADIENES

Heike Kloppenburg and Thomas Gross, Lanxess-PBR

**16.45 – 17.10** APPLICATION OF SURFACE-MODIFIED NANO ZINC OXIDE IN SULFUR VULCANIZATION OF TIRE TREAD COMPOUND

Ms Mercedeh Malekzadeh and Dr Saeed Taghvaei, Islamic Azad University & Rubber Industries Engineering and Research

## DAY 2 SESSION 1

WEDNESDAY 18 FEBRUARY 2009

### TIRE MATERIAL INNOVATIONS

**09.00 – 09.25** A TIRE PERSPECTIVE OF OPPORTUNITIES AND HSE ISSUES IN NANOMATERIALS: THE CASE OF ORGANCLAYS

Dr Luca Giannini, Pirelli Tyre Co

**09.25 – 09.50** TIRE FILLERS: IS IT ALL JUST BLACK OR WHITE?

Dr Ali Ansarifar, Loughborough University

**09.50 – 10.15** EXXCORE DVA: AN INNOVATIVE NEW INNERLINER TECHNOLOGY

Robert N. Webb, ExxonMobil Chemical

### 10.15 – 10.35 MORNING BREAK

**10.35 – 11.00** RELEASE AGENTS IN TIRE MANUFACTURING

Dr Dietmar Hoff, Rhein Chemie Rheinau

**11.00 – 11.25** SULFRON 3001: LATEST FINDINGS TO SIGNIFICANTLY REDUCE ROLLING RESISTANCE FOR TIRES

Dr Nico Huntink, Teijin Aramid

**11.25 – 11.50** EFFECT OF TALC ON ROLLING RESISTANCE IN TREAD COMPOUNDS

Dr Gilles Meli, Rio Tinto Minerals/Luzenac

### 11.50 – 13.30 LUNCH

**13.30 – 13.55** HIGH QUALITY DHA MEASUREMENT LEADS TO BETTER TIRE PERFORMANCES PREDICTIONS

Laurent Perier, OldB-Metravib

**13.55 – 14.20** IMPROVING ROLLING RESISTANCE AND WET GRIP – NEXT-GENERATION SOLUTION SBRS

Dr Dieter Bellgardt, Dow Olefinverbund

**14.20 – 14.45** ENERGY-EFFICIENT TIRE COMPOUND PROCESSING

Colin Clarke, Schill & Seilacher

**14.45 – 15.10** FUTURE TIRE OIL SCENARIO, GLOBAL REFINING TRENDS AND THE IMPACT ON TIRE AND POLYMER PRODUCERS

Gunnar Stang, Alavi, Nynas

**15.10 – 15.35** WET TRACTION – ONE CONCURRENT OF THE MAGIC TRIANGLE OF TIRES

Dr Michael Heinz, Evonik

### 15.35 – 15.55 AFTERNOON BREAK

**15.55 – 16.20** EXAMPLES OF THE APPLICATION OF TREATED MINERAL FILLERS IN SELECTED TIRE COMPOUNDS – A WAY TO COST REDUCTION

Marek Gardavsky, Werba-Chem

**16.20 – 16.45** HIGH-PERFORMANCE SILICAS: A VERSATILE WAY TO IMPROVE HYSTERESIS/PERMEABILITY OF RUBBER COMPOUNDS

Dr Laurent Guy, Rhodia Silica

**16.45 – 17.10** SILICONE RESINS IN RUBBER COMPOUNDING: CHARACTERIZATION, PROCESSING AND PERFORMANCE IN TIRE TREAD FORMULATIONS

Manfred Gloeggler and Thomas Chaussee, Dow Corning

**17.10 – 17.35** THE EFFECT OF CHAIN LENGTH AND SATURATION OF FATTY ACID AS AN ACTIVATOR IN RUBBER VULCANIZATION WITH MERCAPTO ACCELERATOR ON ACTIVATION ENERGY AND CONSTANT RATE

Mrs Sedigheh farsizadeh Zarandi and Ms Marzieh Rouhy, Kerman Tire & Rubber

## DAY 2 SESSION 2

WEDNESDAY 18 FEBRUARY 2009

### TIRE REGULATIONS: A FORCE FOR PROGRESS OR A FARCE?

**09.00 – 09.25** PROPOSED EU TECHNICAL LEGISLATION ON TIRES

Ian Knowles, European Commission

**09.25 – 09.50** RECENT TRENDS IN TIRE LEGISLATION REGARDING NOISE, ROLLING RESISTANCE AND WET GRIP

Urs Reichart, Federal Environmental Agency



**09.50 – 10.15** REACH – SHOULD USERS OF CHEMICALS BE WORRIED?

[Simon Brearley, The REACH Centre](#)

**10.15 – 10.40** IMPLEMENTATION OF REACH AT A MEDIUM-SIZE COMPANY. NEXT STEPS AFTER PRE-REGISTRATION

[Dr Volker Börger, Schill & Seilacher](#)

#### **10.40 – 11.00 MORNING BREAK**

**11.00 – 11.25** REACH FROM TREE TO TIRE

[Dr Steffen Erler, Smithers Rapra](#)

**11.25 – 11.50** REACH: A NEW ERA HAS STARTED  
END-DEC 2008?

[L. Zullo, ETRMA](#)

**11.50 – 12.15** TITLE TO BE CONFIRMED

[Nina Renshaw, The European Federation for Transport & Environment](#)

#### **12.15 – 14.00 LUNCH**

**14.00 – 14.25** TIRE SAFETY AND REGULATORY ISSUES  
IN THE US

[Sean Kane, Safety Research & Strategies](#)

**14.25 – 14.50** REACH – HOW TO OPERATE EFFICIENTLY IN  
SIEFS AND CONSORTIA

[Andrew Fasey, The REACH Centre and Protection Through Knowledge \(PTK\) Ltd](#)

#### **14.50 – 15.35 AFTERNOON BREAK**

**15.35 – 16.00** TITLE TO BE CONFIRMED

[Prof. Ulf Sandberg, VTI \(Swedish National Road & Transport Research Inst\)](#)

**16.00 – 16.25** THE KYOTO PROTOCOL AND THE CARBON  
BLACK INDUSTRY

[Gilles Moninot, Columbian Carbon Europa](#)

**16.25 – 16.50** IMPROVED REQUIREMENTS FOR APPROVAL  
OF ISO 10844 TEST SURFACES FOR NOISE CERTIFICATION  
OF TIRES AND VEHICLES

[Dr Gijsjan van Blokland, M+P](#)

## **DAY 2 SESSION 3**

**WEDNESDAY 18 FEBRUARY 2009**

### **THE VIRTUAL TIRE: LEARNING MORE FROM TIRE PROPERTY PREDICTIONS (CONTINUED)**

**SESSION ORGANIZED BY DR MIKE BLUNDELL,  
COVENTRY UNIVERSITY**

**09.00 – 09.25** TRENDS IN DESIGN AND SIMULATION

[Frans Peeters, Simulia Europe](#)

**09.25 – 09.50** DETERMINING EQUI-BIAxIAL FATIGUE  
PROPERTIES OF ELASTOMERS USING THE DYNAMET  
SYSTEM

[Dr Steve Jerrams, Dublin Institute of Technology](#)

**09.50 – 10.15** VISCOELASTIC ANALYSIS OF ROLLING TIRES  
USING FINITE ELEMENT METHOD

[Dr Mir Hamid Reza Ghoreishy, Iran Polymer Institute](#)

**10.15 – 11.10** TIRE MODELING: PREDICTION OF  
TEMPERATURE AND SPEED EFFECTS ON X-Y TIRE FORCES

[Dr Pierre Fevrier, Michelin Technology Centre](#)

## **DAY 2 SESSION 4**

**WEDNESDAY 18 FEBRUARY 2009**

### **CORD ADVANCES**

**SESSION ORGANIZED BY DR NICO HUNTINK,  
TEIJIN ARAMID BV**

**14.25 – 14.50** LYOCCELL TIRE CORD FOR ULTRA HIGH-  
PERFORMANCE TIRES

[Dr Soo Myung Choi, Hyosung Corporation](#)

**14.50 – 15.15** BRINGING INNOVATION TO TIRE TECHNOLOGY

[Albert Galan Llongueras, TwistTechnology](#)

**15.15 – 15.40** A REVOLUTIONARY NEW TYPE OF PET TIRE  
YARN FOR CARCASS APPLICATIONS

[Bas Krins, Applied Polymer Innovations, Emmen](#)

#### **15.40 – 16.00 AFTERNOON BREAK**

**16.00 – 16.25** ADHESION ACTIVATION OF TWARON  
ARAMID FIBERS: CHEMICAL VERSUS PLASMA TREATMENT

[Dr Pieter de Lange, and P. G. Akker, Teijin Aramid](#)

**16.25 – 16.50** SOME ASPECTS OF ADHESION OF ARAMID  
TIRE CORDS

[Maarten van de Made, TFA Institute](#)

**If precision is  
your deciding factor:  
The mixing room  
experts are Zeppelin!**

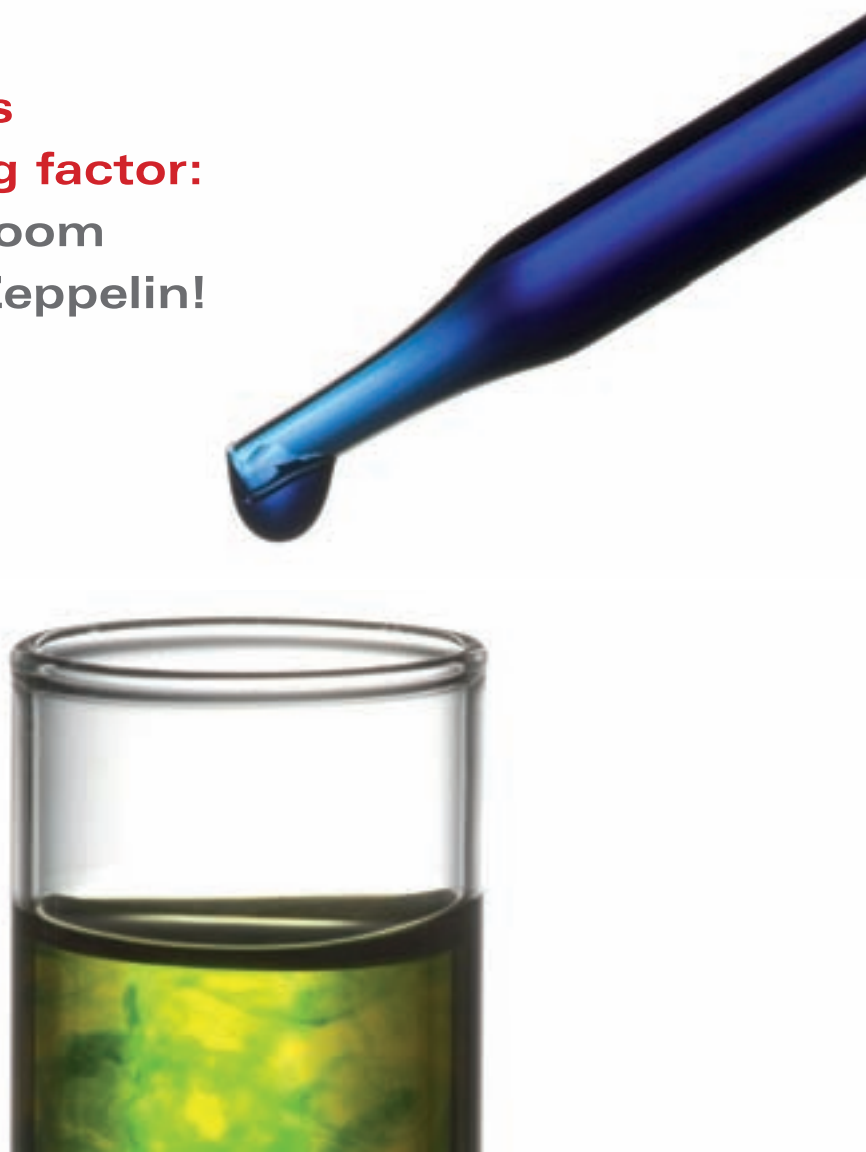

**Sensitive to your needs.**



**Whether liquid, solid or powder components: the mixing room experts from Zeppelin provide the exact "batch" mixture for your compound.**

Our purpose designed, field proven technologies for dosing and weighing assure you the highest accuracy without compromise, giving maximum profitability day in – day out. For storing, conveying, dosing, weighing up to batch tracing – use the experience of the leading system manufacturer to guarantee your success! Visit us at Tire Technology Expo 2009, Hamburg, Germany, Stand 4365.

**Zeppelin Silos & Systems GmbH**  
Leutholdstr. 108 · D-88045 Friedrichshafen  
E-mail: [zentral.fn@zeppelin.com](mailto:zentral.fn@zeppelin.com)  
Phone: +49 7541 202-279 · Fax: +49 7541 202-491  
[www.zeppelin-industry.com](http://www.zeppelin-industry.com)

**ZEPPELIN®**  
**All specialists under one roof**

**16.50 – 17.15** STANDARD REQUIREMENTS AND FUTURE TRENDS

*Dr Peter Zmolek, Continental*

## DAY 2 SESSION 5

WEDNESDAY 18 FEBRUARY 2009

### THE TYROSAFE PROJECT

SESSION ORGANIZED BY STEVE PHILLIPS, SECRETARY GENERAL, THE NATIONAL HIGHWAY RESEARCH LABORATORIES OF EUROPE

**09.00 – 09.10** AN INTRODUCTION TO THE TYROSAFE PROJECT

*Manfred Haider, Tyrosafe/Arsenal Research*

**09.10 – 09.35** EUROPEAN POLICIES CONCERNING ROAD SURFACE CHARACTERISTICS

*Roland Spielhofer, Tyrosafe/Arsenal Research*

**09.35 – 10.00** ROLLING RESISTANCE OF TWO PASSENGER CAR TIRES ON 40 DIFFERENT ROAD SURFACES

*Gijsjan van Blokland, M+P*

**10.00 – 10.25** LESSONS LEARNED FROM PREVIOUS SKID RESISTANCE HARMONIZATION ATTEMPTS

*Erik Vos, Tyrosafe/RWS*

### 10.25 – 10.45 MORNING BREAK

**10.45 – 11.10** LOW-NOISE ROAD SURFACE: CURRENT PRACTICES

*Fabienne Anfosso, Tyrosafe/LCPC*

**11.10 – 11.35** ROLLING RESISTANCE MEASUREMENTS

*Jerzy Ejsmont, TU Gdansk*

**11.35 – 12.00** THE INTERACTION BETWEEN SURFACE TEXTURE AND TIRE TREAD DEPTH IN RELATION TO SKID RESISTANCE

*Martin Greene, Tyrosafe/TRL*

**12.00 – 12.15** TITLE TO BE CONFIRMED

*Joachim Neubauer, Michelin*

**12.15 – 12.30** SUMMARY OF THE PRESENTATIONS

*Manfred Haider, Tyrosafe/Arsenal Research*

## DAY 2 SESSION 6

WEDNESDAY 18 FEBRUARY 2009

### UNDERSTANDING TIRE PROPERTIES

**14.00 – 14.25** A TREADWEAR TEST PROCEDURE AND THE INFLUENCE THAT THE SILICA COMPOUND EXERTS ON THE TIRE TREAD WEAR

*Shunichi Yamazaki, Intelligent Vehicle Research Institute*

**14.25 – 14.50** DYNAMIC BEHAVIOR OF PRESTRAINED ELASTOMERS

*Nutthanun Suphadon, University of London*

**14.50 – 15.15** FRICTIONAL SLIDING OF RUBBER

*Philip Gabriel, University of London*

**15.15 – 15.40** CORRELATION BETWEEN PHYSICO-MECHANICAL PROPERTIES OF NR-BR BLENDS IN TIRE TREAD FORMULATION WITH THEIR THERMAL BEHAVIOR

*Mrs Fereshteh Motiee and Dr Saeed Taghvaei-Ganjali, Islamic Azad University – North Tehran Branch*

### 15.40 – 16.00 AFTERNOON BREAK

**16.00 – 16.25** ROAD-EMBEDDED SYSTEMS FOR MEASURING STRESSES IN THE TIRE-ROAD CONTACT PATCH

*Dr Gabriel Anghelache, University Politehnica of Bucharest*

**16.25 – 16.50** A LOCAL VIEW OF TIRE TRACTION MECHANISMS

*Stefan Ripka, Institute of Dynamics and Vibration Research*

**16.50 – 17.15** FUNDAMENTALS OF RUBBER-ICE FRICTION

*Dr Jane Blackford, University of Edinburgh*

**17.15 – 17.40** TITLE TO BE CONFIRMED

*Bernward Mähner, SDS Systemtechnik*

## DAY 3 SESSION 1

THURSDAY 19 FEBRUARY 2009

### THE INTELLIGENT TIRES' ROLE IN VEHICLE ELECTRONIC SYSTEMS

SESSION ORGANIZED BY FEDERICO MANCOSU, PIRELLI PNEUMATICI

**09.30 – 09.55** ADDITIONAL INFORMATION FOR VEHICLE DYNAMICS USING CYBER TIRE: AQUAPLANING

*Massimo Brusarosco, Pirelli Tire*

**09.55 – 10.20** VEHICLE DYNAMICS: POSSIBLE IMPROVEMENTS USING TIRE DATA

*Francesco Braghin, Politecnico di Milano*

# YOUR NEEDS, OUR MISSION



## VMI MAXX Productivity Without Compromise

Having the right production equipment is critical for making superior products. It is essential to select suppliers with superior technology.

VMI has pushed back the boundaries of tire building by offering unprecedented levels of productivity without compromising quality or flexibility.

We develop new ideas, concepts and equipment modifications and implement the latest technologies, that give you a competitive edge. We take care of your business.

VMI Holland BV  
Tel. +31-578 679 111  
Fax +31-578 621 317  
E-mail: [sales@vmi-group.com](mailto:sales@vmi-group.com)

[www.vmi-group.com](http://www.vmi-group.com)



## WORLDWIDE TIRE PRODUCTION TOOLING Keeping the World on the move!



### WYKO Tire Technology are the world leaders

in the design and manufacture of  
tooling used in conventional and advanced  
tire building systems where quality,  
accuracy and efficiency is demanded.



EUROPE

WYKO TIRE TECHNOLOGY LTD (UK)  
T: +44 (0) 1384 844100 F: +44 (0) 1384 239572  
E: [sales@wyko-tyre.com](mailto:sales@wyko-tyre.com) W: [www.wyko-tyre.com](http://www.wyko-tyre.com)

WYKO TIRE TECHNOLOGY LTD (GERMANY)  
T: +49 (0) 6074 48340-0 F: +49 (0) 6074 48340-49  
E: [ingo.matthies@wyko-tyre.com](mailto:ingo.matthies@wyko-tyre.com)  
W: [www.wyko-tyre.com](http://www.wyko-tyre.com)



USA

WYKO TIRE TECHNOLOGY INC (USA)  
T: +1 865 856 2317 F: +1 865 856 2092  
E: [wyko@wykous.com](mailto:wyko@wykous.com) W: [www.wyko-tyre.com](http://www.wyko-tyre.com)



CHINA

WYKO (SHANGHAI) TRADING CO. LTD  
T: +86 21 5109 5898 F: +86 21 5190 1970  
E: [gu.xian@wyko-tyre.cn](mailto:gu.xian@wyko-tyre.cn) W: [www.wyko-tyre.cn](http://www.wyko-tyre.cn)

An **ERIKS** Company

**10.20 – 10.45** TIRE-ROAD CONTACT INFORMATION FOR ADVANCED DRIVER ASSISTANCE SYSTEMS

[Ari Tuononen, Helsinki University of Technology](#)

**10.45 – 11.10** THE SELF-INFLATING TIRE

[Maros Topoli, Coda Development](#)

**11.10 – 11.35** TIRE-ROAD FRICTION ESTIMATION FOR APPLICATION IN CHASSIS CONTROL SYSTEMS AND ADVANCED DRIVER ASSISTANCE SYSTEMS

[Marco Pesce, Centro Ricerche Fiat](#)

## DAY 3 SESSION 2

THURSDAY 19 FEBRUARY 2009

### NATURAL RUBBER: THE EVOLVING POLYMER

SESSION ORGANIZED BY DR ANDREW TINKER, TARRC

**09.00 – 09.25** SILICA IMPROVES NR-BASED TRUCK-TREAD PERFORMANCE

[Paul Brown, TARRC](#)

**09.25 – 09.50** ALKYLPHENOL-POLYSULFIDE GRAFTED EPDM IN BLENDS WITH NR/BR FOR OZONE-RESISTANT TIRE SIDEWALLS

[Hong-mei Zhang, Teijin Aramid](#)

**09.50 – 10.15** NATURALLY BETTER PERFORMANCE – IMPROVED UNDERSTANDING OF RUBBER-FILLER INTERACTION

[Stuart Cook, TARRC](#)

### 10.15 – 10.35 MORNING BREAK

**10.35 – 11.00** ENHANCED PASSENGER TIRE TREAD PERFORMANCE FROM SUSTAINABLE RESOURCES

[Paul Brown, TARRC](#)

**11.00 – 11.25** DELINK DEVULCANIZATION TECHNOLOGY – A NEW OPTION FOR SUSTAINABILITY IN THE TIRE INDUSTRY

[Steve Nieto, Green Rubber Global](#)

**11.25 – 11.50** NR PRODUCTION IN THE FUTURE

[Dr Abdul Aziz S A Kadir](#)

## DAY 3 SESSION 3

THURSDAY 19 FEBRUARY 2009

### CONSEQUENCES FOR TIRES OF THEIR MORE COMPLEX LIFESTYLE AND LONGER LIFE POTENTIAL

SESSION ORGANIZED BY JOHN DORKEN, BTMA

**09.00 – 09.25** END OF LIFE TIRES: NEW ECONOMICAL AND ENVIRONMENTALLY FRIENDLY OPPORTUNITIES

[Catherine Clauzade, Aliapur](#)

**09.25 – 09.50** CONSUMER REQUIREMENTS ON TIRE TECHNOLOGY AND PERFORMANCE

[Dr Henry Görlitz, Bereich Untersuchungen Abt. Produkttests II](#)

**09.50 – 10.15** COUNTERACT BALANCING BEADS ELECTROSTATIC TIRE BALANCING

[James LeBlanc, Counteract Balancing Beads](#)

### 10.15 – 10.35 MORNING BREAK

**10.35 – 11.00** JUST HOW WORN ARE OUR TIRES? THE NEED FOR TREAD DEPTH INFORMATION ON THE IN-SERVICE FLEET

[Dr John C Bullas, Atkins Highways & Transportation](#)

**11.00 – 11.25** TITLE TO BE CONFIRMED

[Mike Owen, Retail Motor Industry Federation](#)





**KLINGELBERG  
GROUP**

*Red-Hot* **for Tire**



## KNIVES FOR THE TIRE INDUSTRY

**tire** 17-19 Februar  
technology Hamburg Messe  
**EXPO 2009** Germany  
**EXHIBITOR** Stand 4265

IKS KLINGELBERG GROUP · THE KNIFE MANUFACTURERS

 DIVISION **PLASTIC, RUBBER & RECYCLING**    

[www.interknife.com](http://www.interknife.com)

IKS KLINGELBERG GmbH · In der Fleute 18 · 42897 Remscheid · Tel.: +49 (0)2191 / 969-0

## I N T E L L I G E N T M A T E R I A L T E S T I N G

# Testing Instruments from Testing Experts

The dynamic testing instruments of GABO QUALIMETER are used very successfully in the material development and for quality control since several decades.

### **EPLEXOR® DMTS/DMTA**

The well-known Dynamic Mechanic Thermal Analyser to ascertain visco-elastic properties (Young's Modulus, glass transition, frequency and temperature behaviour)

### **GABOMETER® Flexometer/Fatigue Tester**

The newly designed Goodrich Flexometer for heat build-up and blow out tests

### **GABOTACK® Quality Control**

The tackiness tester for "Green Tires", epoxy resins and much more

### **QUALIMETER® Quality Control**

Provides online quality control during production processes (static and dynamic spring rate, hardness and visco-elastic properties)



**GABO QUALIMETER Testanlagen GmbH**  
Schulstr. 6 · 29693 Ahlden/Germany  
Phone: +49 5164 8019-0  
Fax: +49 5164 8019-30  
e-mail: [info@gabo.com](mailto:info@gabo.com)  
internet: [www.gabo.com](http://www.gabo.com)

**tire technology**  
**Expo 2009**  
Hall A1, F04 – Foyer  
Hamburg, Germany  
17.-19. Februar 2009  
[www.tiretechnology-expo.com](http://www.tiretechnology-expo.com)

Foto: © Dominique Leroy - fotolia



# TIRE MECHANICS SHORT COURSE

**The 34th Tire Mechanics Short Course will be held concurrently with Tire Technology Expo 2009 in Hamburg, Germany on 16/17/18/19 February 2009.**

This four-day course will provide engineers and scientists with an in-depth, intense study of the latest developments surrounding tire engineering.

The course is designed for practising engineers, chemists and scientists who are concerned with tires and vehicles, and who have an engineering or science background at the Bachelor of Science level. The basic aspects of the mechanics of pneumatic tires will be introduced by internationally renowned experts in tire mechanics.

**Over 1,000 pages** of course notes on CDs prepared by the instructors will be provided for all participants. Those who complete this course will receive a certificate from The University of Akron.

## MONDAY 16 FEBRUARY 2009

**08:00 – 09:00** LATE REGISTRATION,  
WELCOME AND INTRODUCTION

Dr Benjamin T.F. Chung,  
Department of Mechanical Engineering,  
The University of Akron, USA

**09:00 – 12:00** STRENGTH, WEAR AND  
FRICTION OF RUBBER

Dr Alan Gent,  
Institute of Polymer Science,  
The University of Akron, USA

To fully understand friction and wear of tires, a basic knowledge of the mechanical properties of rubber is needed. This presentation deals with the elasticity and strength of rubber, its visco-elastic properties that cause rubber to have inherent damping, and the laboratory measurement and interpretation of tear strength, fatigue resistance and adhesion to wire cord. The unusual frictional properties of rubber are discussed, and the difficulty in meeting the competing

requirements of low rolling resistance for good fuel economy, but high sliding friction for good traction and braking. Some fundamental factors governing the rate of wear of tires are also outlined.

- I. Elasticity and viscoelasticity
- II. Strength of rubber compounds
- III. Rolling and sliding friction
- IV. Abrasion of rubber and wear of tires

## 12:00 – 13:00 LUNCH

**13:00 – 18:00** THE TIRE AS A VEHICLE  
COMPONENT

Dr Gerald Potts,  
Test Measurement Systems Inc, USA

Today's pneumatic tire must serve four functions: (1) support a moving load; (2) generate steering forces; (3) generate driving and braking forces; and (4) provide isolation from road irregularities. In examining the complex mechanism involved in satisfying the four requirements, participants will study the tire's importance in determining overall vehicle

# AKRON UNIVERSITY TIRE MECHANICS SHORT COURSE

performance; for no matter what level of complexity is designed into a vehicle, its only communication with the road is through its tires.

- I. Basic functions
- II. Lateral force tire models
- III. Cornering transients
- IV. Vehicle ride characteristics

## TUESDAY 17 FEBRUARY 2009

### 08:00 – 12:00 TIRE MATERIALS AND MANUFACTURING

Dr Joseph Walter,  
The University of Akron, USA

The materials used in today's pneumatic tires are designed to act in concert with construction features to provide optimum durability and performance for a given tire application. Proper rubber compound formulation and application of cord-rubber composites are crucial to the successful operation of a tire. This part of the course provides participants with an introduction to the unique performance and physical properties of rubber compounds and textile materials used in tires and an overview of tire manufacturing operation.

- I. Material composition of a tire
- II. The rubber compound
- III. Processing of rubber compounds
- IV. Reinforcements – textile and steel cord

### 12:00 – 13:30 LUNCH & EXHIBITS VISIT

### 13:30 – 15:00 RULES AND REGULATIONS GOVERNING TIRES

Dr Joseph Walter,  
Department of Mechanical Engineering,  
The University of Akron, USA

Government regulations, industry standards, customer specifications, and marketing requirements directly impact the ultimate design (and consequently the performance level) of all tires – particularly original equipment and aftermarket passenger car tires. Discussed in this part of the course are:

- I. The current state of regulatory affairs, including the TREAD Act and Energy Act of 2007
- II. The design trade-offs often inherent in meeting sometimes conflicting rules and regulations
- III. Different market requirements

### 15:00 – 17:00 EXHIBITS VISIT

## WEDNESDAY 18 FEBRUARY 2009

### 08:00 – 12:00 ADVANCED TIRE MODELING

Dr Joseph Padovan,  
Department of Mechanical Engineering,  
The University of Akron, USA

This presentation will include past, present and possible future analytical-numerical models of the tire, a development of the tire behavior and discussions of current numerical simulation techniques.

- I. Introduction to FEA modeling
- II. Multi-length scale modeling of tires
- III. Time-dependent properties of elastomers (SBR, BR, NR, ..., EPDM) and plastics (nylon, Kevlar, nylon, ..., polyester)
- IV. Critical speed
- V. Rolling resistance
- VI. FEA modeling of tire stochastic effects
- VII. Optimization of cord spacing
- VIII. Fracture mechanics fundamentals
- IX. Modeling of stochastic effects on durability
- X. Overall fatigue analysis procedure
- XI. Hydroplaning analysis

## > COURSE INSTRUCTORS



DR BENJAMIN T.F. CHUNG  
Department of Mechanical  
Engineering, The University  
of Akron, USA



DR ALAN GENT,  
Institute of Polymer  
Science, The University  
of Akron, USA



DR GERALD POTTS,  
Test Measurement  
Systems Inc, USA



DR JOSEPH D. WALTER,  
The University of Akron,  
USA

## 12:00 – 13:00 LUNCH & EXHIBITS VISIT

### 13:00 – 14:30 ADVANCED TIRE MODELING

Dr Joseph Padovan,  
Department of Mechanical Engineering,  
The University of Akron, USA

### 14:30 – 18:00 TIRE WEAR, TRACTION AND FORCE GENERATION

Dr Marion G. Pottinger,  
M'gineering LLC, USA

Tire force generation, wear and traction are all crucially determined by what takes place in the tire/road contact patch. This section provides a discussion of how tire design, kinematics, the road surface, and driver behavior come together to determine wear, traction, and cornering behavior. The discussion is conducted not only on a scientific basis, but also with an eye to product design.

- I. Tire contact stresses and displacement
- II. The effect of contact stresses and displacements on wear
- III. Tire force generation and the effect of tread design
- IV. Tire forces, traction, and design
- V. Other design-related topics affected by footprint behavior

## THURSDAY 19 FEBRUARY 2009

### 08:00 – 12:00 TIRE STRESS AND DEFORMATION ANALYSIS

Dr Michael Trinko,  
Department of Mechanical Engineering,  
The University of Akron, USA

The properties of the anisotropic cord rubber composite have primary control of the overall

performance characteristics of pneumatic tires. In order to optimize a given tire performance parameter, knowledge of the combined cord rubber composite material properties is necessary and will be covered in this part of the course.

- I. Composite material stiffness calculation
- II. Analytical techniques (classical methods)
  - A. Equilibrium tire design
  - B. Cord load, bead force, and burst pressure calculations
- III. Experimental techniques (point and whole field methods)
  - A. Cord tension and rubber strain measurements
  - B. Belt edge strains/stresses
  - C. Tire-to-road and tire-to-rim contact

## 12:00 – 13:00 LUNCH & EXHIBITS VISIT

### 13:00 – 14:30 TIRE STRESS AND DEFORMATION ANALYSIS

Dr Michael Trinko,  
Department of Mechanical Engineering,  
The University of Akron, USA

### 14:30 – 15:00 COURSE EVALUATION AND DISTRIBUTION OF CERTIFICATES

Dr Benjamin T.F. Chung,  
Department of Mechanical Engineering,  
The University of Akron, USA



DR JOSEPH PADOVAN,  
Department of Mechanical  
Engineering, The University  
of Akron, USA



DR MARION G. POTTINGER,  
M'gineering LLC, USA



DR MICHAEL TRINKO,  
Department of Mechanical  
Engineering, The University  
of Akron, USA

Design | Technology | Materials | Manufacturing

**26, 27, 28 October 2009,**  
**HITEX Exhibition Centre, Hyderabad, India**



**BOOK YOUR STAND NOW!**  
**VISIT STAND NO. 4706**

**THE WORLD'S LEADING TIRE  
DESIGN AND TIRE MANUFACTURING  
EXHIBITION AND CONFERENCE  
COMES TO INDIA**

[www.tiretechnology-expoindia.com](http://www.tiretechnology-expoindia.com)

**tire**  
technology  
**EXPO INDIA**



# EXHIBITOR LISTINGS

## 01DB-METRAVIB

**Stand:** F1

**Stand Representatives:** Arnaud Favier

**Address:** 200 Chemin Des Ormeaux, Limonest, F-69578, Cedex, France

**Tel:** +33 4 72 52 48 00

**Fax:** +33 4 78 66 340 1

**Email:** arnaud.favier@01db-metravib.com

**Web:** www.dma-instruments.com

For 40 years, 01dB-METRAVIB has been recognized worldwide as the most innovative manufacturer of DMA for the analysis of the viscoelastic properties: E\*, G\*, Tan delta and their dependence to temperature, frequency and strain. Our range offers unmatched capabilities to analyze rubber over wide strain, force and frequency domains. In addition to classical DMTA capabilities (glass transition, Payne/Mullins effects, creep, master curves calculation, influence of reinforcement and additive), the METRAVIB catalog includes unmatched instruments and functionalities (robotized shear mode, multi-harmonics control for pulse or customized waveform, customized measurement channels, heat build up, control of hygrometry).

## 4JET LASER – SYSTEME-SERVICES

**Stand:** 4005

**Stand Representatives:** Christoph Rutsch, Jörg Jetter, Andreas Stec

**Address:** Rheinstrasse 9, Huckelhoven, 41836, Germany

**Tel:** +49 (0) 243397540

**Email:** joerg.jetter@4jet.de

**Web:** www.4jet.de

4JET supplies laser mold cleaning systems and laser tire marking systems to most leading tire makers. This year, 4JET will launch its new T-Mark Compact hand-held laser tire marking system at Tire Expo. The

T-Mark Compact allows engraving of serial numbers, country codes, logos, etc. on tire sidewalls.

## A-Z FORMEN-UND-MASCHINENBAU GMBH



**Stand:** 4425

**Stand Representatives:** Rainer Hilke, Gerhard Schmaderer, Andreas Hofmaier, Reinhard Winter, Tatjana Slobodskaja

**Address:** Dessauerstrasse 9, Munich, D-80992, Germany

**Tel:** +49 891 498 1711

**Fax:** +49 891 498 1790

**Email:** rhilke@a-z-gmbh.de

**Web:** www.a-z-gmbh.de

A-Z produces molds and containers in Germany and Czech Republic. By substantial investments and improved technology, A-Z is known to meet the technical requirements to produce molds with the most complex tread designs. In addition, more than 13,000 containers, were supplied to international tire producers. The all in-house production facilities, the different technologies for the tread pattern and the well-established A-Z container system ensure that A-Z is one of the leading independent suppliers throughout the world. A-Z: the company for tire molding solutions from A to Z.

## AB SVENSKT KONSTILKE

**Stand:** 4007

**Address:** PO Box 31, Borås, SE-50307, Sweden

**Tel:** +46 33 205 400

**Fax:** +46 33 205 420

**Email:** mail@konstsilke.com

## AIRTEC CONTROLS GMBH



**Stand:** 4521

**Stand Representatives:** Hartmut Hahnwald

**Address:** Westerbachstr 7, Kronberg, D-61476, Germany

**Tel:** +49 6173 956211

**Fax:** +49 6173 956266

**Email:** i.huber@airtec.de

**Web:** www.airtec-controls.de

Airtec Controls is supplier of Rocky piston valves suitable for steam, gas, hot and cold water. They are preferably used in the tire industry. Available in sizes from 1/4" to 2" either with flange or thread connection. The product line also covers steam regulators, steam control valves, check valves and knuckle joints. Complete customer-designed panel units (valve systems on manifold) for curing presses, chuck loaders and center mechanism complete the product line.

## ALFAUTOMAZIONE SPA

**Stand:** 4136

**Address:** Via Cadore 21, Lissone, MI, I-20035, Italy

**Tel:** +39 039 2435 1

**Fax:** +39 039 2459980

**Email:** info@alfautomazione.com

**Web:** www.alfautomazione.com

## ALLIGATOR VENTILFABRIK GMBH

**Stand:** 4470

**Address:** Richard-Steiff-Straße 4, D-89537 Giengen/Brenz, Germany

**Tel:** +49 (0) 7322 130 0

**Fax:** +49 (0) 7322 130 359

## ALPHA TECHNOLOGIES UK

**Stand:** F6

**Stand Representatives:** Wilfried Emunds, Michaela Kahr

**Address:** Unit 2B Crowood House, Gypsy Lane, Swindon, SN2 8YY, Wilts, UK

**Tel:** +44 1793 601100 Ext 120

**Fax:** +44 1793 615214

**Email:** christine.martin@dynisco.com

**Web:** www.alpha-technologies.com

Alpha Technologies is the world-famous rubber instruments manufacturer. The MDR2000, MV2000 and RPA2000 are the most popular testing instruments in every tire and rubber company. With the expansion of business, Alpha Technologies is now offering a wider range of instruments, including the disperGRADER+ to measure the dispersion of fillers in mixed compounds, and the FTFT to determine the fatigue life properties of cured samples. Our sales and service team have more than 10 years' experience in Alpha Technologies and serving our customers professionally.

## A.M.A. SPA



**Stand:** 4427

**Stand Representatives:** Andrea Tuninetti

**Address:** ss 98 Km 77, 500, Bitonto, (BA), I-70032, Italy

**Tel:** +39 (0) 11 959 2367

**Fax:** +39 (0) 11 957 2368

**Email:** info@ama-spa.com

**Web:** www.ama-spa.com

## AMMERAAL BELTECH HOLDING BV

**Stand:** 4130

**Stand Representatives:** Giuseppe Allais

**Address:** Marketing + Sales, Hermsdorfer Str 3, Geesthacht, D-21502, Germany

**Tel:** +49 4152 937110

**Fax:** +49 4152 937167

**Email:** evdbliefk@ammeraalbeltech.com

**Web:** www.ammeraalbeltech.com

Company focus: The completion of the uni plastic modular belt range for the tire industry. The uni Roller Top Belt (RTB) – a collector belt of finished tires from vulcanizing/curing presses and final tire handling. The uni OWL belt – a heat- and wear-resistant belt with large open areas for easy drainage and airflow. Equipment focus: deep tank and batch-off equipment; a new synthetic Silam belt for rubber mixing. The benefit: the high temperature resistance. Amseal Tyre – a wear-resistant seal edge system specifically for the rubber industry. Our ultrasync belt range – positive drive belts for tire building machines. Ammeraal Beltech offers the widest belting service network worldwide.

## APV ENGINEERED COATINGS

**Stand:** 4145

**Stand Representatives:** David Rogers, Sigi Wahl, Massimo Navarra

**Address:** 1390 Firestone Parkway, Akron, 44301, Ohio, USA

**Tel:** +1 330 773 8911

**Fax:** +1 330 773 1028

**Email:** drogers@apvcoatings.com

**Web:** www.apvcoatings.com

APV will be featuring its unique ability to manufacture water-based and VOC-free materials used in every process of tire production. From compound coding through pre-cure releases, to include patented water-based cements, to tire finishes, stripping, coding, marking – APV covers every aspect of production. Virtually every tire made in the USA contains APV products; through distribution we are now making these available to the world. Discover how we can assist you in supplying materials to maintain and improve quality, reduce scrap, and that are both environmentally friendly and economic in use. APV is pre-registered for REACH.

## ATTREZZERIA PAGLIARI

**Stand:** 4427

**Stand Representatives:** Andrea Pagliari, Bruno Maroscutti

**Address:** Via Dell' Artigiano 12, Solaro, 20020, Milano, Italy

**Tel:** +39 02 969 0427

**Email:** attpagli@tin.it

**Web:** www.attrezzeriapagliari.com

Attrezzeria Pagliari srl: worldwide ISO 9001. A certified producer of sipes and electrodes for tire mold companies.

## BAINITE MACHINES PVT LTD

**Stand:** 4760

**Address:** C-10 Nand Dham Ind, Estate, Marol Maroshi Road, Andheri (E), Mumbai, 400 059, India

**Tel:** +91 22 2920 5910 / 1933

**Fax:** +91 22 2920 1465

**Email:** vss@bainitemachines.com

**Web:** www.bainitemachines.com

## BARTELL MACHINERY



**Stand:** 4004

**Stand Representatives:** Geoff Worthington, Brian Turvey, Ged Lee

**Address:** 1 Pearson Road, Central Park, Telford, TF2 9TX, Shropshire, UK

**Tel:** +44 (0) 1952 201 291

**Email:** gworthington@bartellmachinery.co.uk

**Web:** www.bartellmachinery.com

Bartell is a world leader in the design and manufacture of bead winding systems – both single wire systems and multiwire systems. Other beadroom equipment available includes automatic truck apexing, bead measuring machines, bead wrapping machines, bead handling systems and wire pre-heaters. All this is supported by our extensive parts and service department – 24/7.

**MetraViB**

## Material characterization at its best!

Visit us on  
our booth n°F1

DMA

Crack growth test

Payne effect

Viscoelastic properties  $E^*$ ,  $G^*$ ,  $\tan\delta$

Simultaneous analysis capabilities

Mullins effect

Heat build-up

Robotized analysis

Glass transition

Vulcanisation

Fatigue

Creep/stress relation

01dB-Metravib

[www.dma-instruments.com](http://www.dma-instruments.com)



**AREVA**

**26, 27, 28 October 2009,  
HITEX Exhibition Centre, Hyderabad, India**

**BOOK YOUR  
STAND NOW!  
VISIT STAND NO. 4706**

**tire**  
technology  
**EXPO INDIA**

THE WORLD'S LEADING TIRE DESIGN AND TIRE MANUFACTURING  
EXHIBITION AND CONFERENCE COMES TO INDIA  
[www.tiretechnology-expoindia.com](http://www.tiretechnology-expoindia.com)

### **BARTELL MACHINERY SYSTEMS LLC**

**Stand:** 4004

**Stand Representatives:** Brian Turvey, Chris Rushton

**Address:** 6321 Elmer Hill Road, Rome, NY 13440-9325, USA

**Tel:** +1 315 336 7600

**Email:** kbturvey@bartellmachinery.com

**Web:** www.bartellmachinery.com

Bartell is a world leader in the design and manufacture of bead winding systems – both single wire systems and multi-wire systems. Other beadroom equipment available includes automatic truck apexing, bead measuring machines, bead wrapping machines, bead handling systems and wire pre-heaters. All this is supported by our extensive parts and service department – 24/7.

### **BECKHOFF AUTOMATION GMBH**

**Stand:** 4415

**Stand Representatives:** Klaus Büttner

**Address:** Eiserstr. 5, Verl, D-33415, Germany

**Tel:** +49 5246 963 0

**Fax:** +49 5246 963 198

**Email:** info@beckhoff.com

**Web:** www.beckhoff.com

Beckhoff offers open and flexible automation solutions for the tire and rubber industry. Besides industrial PCs, I/Os and field-bus components, as well as drive technology and the TwinCAT automation software, the range of products encompasses a uniform, scalable and modular control system. Beckhoff implements open automation systems based on PC-based control technology for mixing, preparation, tire building, curing and final finish.

### **BETACONTROL GMBH & CO KG**

**Stand:** 4315

**Stand Representatives:** Michael Hecht

**Address:** Am Weidekamp 10, Freudenberg, D-57258, Germany

**Tel:** +49 2734 46812

**Fax:** +49 2734 46859

**Email:** michael.hecht@betacontrol.de

betacontrol will be presenting innovative measuring systems for tire production at the TTE 2009. As a leading expert in the sector for industrial measuring and control engineering, betacontrol sets high standards in terms of exact automated and non-contacted gauging. The online weight and thickness measuring systems have been developed and designed in such a way as to satisfy any demand and may be flexibly adapted to customer requirements. Besides the planning and production of individual solutions, betacontrol provides engineering and consulting services and on request also offers its customers a 24-hour support service.

### **BRANDENBURGER ISOLIERTECHNIK GMBH & CO**

**Stand:** 4230

**Stand Representatives:** Lutz Schöne, Robert Krohn

**Address:** Taubensuhlstr. 6, Landau, D-76829, Germany

**Tel:** +49 6341 5104 140

**Fax:** +49 6341 5104 156

**Email:** p.schwab@brandenburger.de

Brandenburger Isoliertechnik GmbH & Co KG develops, produces and sells thermal insulation materials for heated presses and molds used in the wood, plastics and rubber industries. Companies of the tire industry in particular are using Brandenburger thermal insulation materials to prevent energy loss and excessive heat emissions at their heated tire curing presses and molds. Brandenburger Insulation Materials also enable shorter

heating-up periods and an improved production process.

### **BST INTERNATIONAL GMBH**



**Stand:** 4115

**Stand Representatives:** Andreas Flöter, Torsten Probst

**Address:** Heidsieker Heide 53, Bielefeld, D-33739, Germany

**Tel:** +49 5206 999 0

**Fax:** +49 5206 999 759

**Email:** automation@bst-international.com

**Web:** www.bst-international.com

BST International GmbH is the market leader worldwide. It is our automation systems and web guide control that set trends in the market. Our products are successfully used around the globe in the rubber and tire industries, printing, film (foil) industries. We are a powerful team – experienced engineers, developers, sales professionals, manufacturing experts, service technicians and the many other members of the team all use their expertise and know-how to guarantee high-quality products, continual innovations and satisfied customers. Founded in 1979 in Bielefeld, Germany, we are able to rely on closely integrated global production and sales networks that provide you with top-class service.

### **BUZULUK KOMAROV AS**

**Stand:** 4205

**Address:** Buzulucka 108, Komarov, CZ-267 62, Czech Republic

**Tel:** +420 311 575 539

**Fax:** +420 311 572 284

**Email:** info@buzuluk.cz

**Web:** www.cgs.cz





It all depends on  
the right mixture!

**struktol®** HT series

**Advanced products for advanced tyre technologies:**

**Struktol HT 105** | Natural rubber - viscosity reduction without compromise

**Struktol HT 204** | Compound release additive for mixer mill and mould release, especially effective for silica compounds

**Struktol HT 254** | Efficient silica processing in high performance compounds

**Struktol HT 324** | Makes innerliner compounds stretch further

**Schill+Seilacher**

Schill + Seilacher "Struktol" Aktiengesellschaft

Moorfleeter Straße 28 | D-22113 Hamburg | Phone +49 (0) 40 733 620 | Fax +49 (0) 40 733 62 194

www.struktol.de | E-Mail: info@struktol.de

**Call us. We have the solution.**

See you at  
**Tire Technology Expo 2009**  
in Hamburg, February 17, 18, 19, 2009  
Hall A1 Stand no. F03

**Your partner in NDT inspection**



**Efficient inspection & metrology solutions for high quality standards**

- Full range of inspection machines
- Higher image quality
- Automatic Defect Detection
- X-ray, laser, vision, tomography

**Passenger, Truck and OTR radial tires**

**Open and flexible software**  
**Compact and reliable equipment**





## BYTEWISE MEASUREMENT SYSTEMS INC

**Stand:** 4110

**Stand Representatives:** Rolf K. Svensson

**Address:** PO Box 237, Trelleborg, SE-23127, Sweden

**Tel:** +46 410 12290

**Fax:** +46 410 17155

**Email:** rolf.svensson@bytwisemeasurement.com

Bytwisemeasurement Systems will display its system for analysis of runouts and splices of green tires on the tire building drum. The product, GTU, is targeted for use in trouble-shooting and monitoring the tire building process to identify sources of geometric non-uniformity that influence the cured-tire non-uniformity. The system uses Bytwisemeasurement VHSL (very high-speed sheet-of-light laser) scanning sensors to digitize the green tire topography. Once digitized, the data is displayed in a 3D solid model. Analyses include automatic calculation of radial and lateral runout magnitudes and angles, harmonic magnitudes and angles, and characterization of tire construction splices.

## CALEMARD SA

**Stand:** 4000

**Stand Representatives:** Christian Montusclat

**Address:** Z.I. Du Buisson, Rue De La Poudriere, Roche La Moliere, F-42230, France

**Tel:** +33 4 7790 0034

**Fax:** +33 4 7790 3683

**Email:** calemard@spoollex.com

**Web:** www.calemard.com

Calemard is the leader for slitting equipment used in the stock preparation process: wide slitter Orion G to convert calendered rubber components (nylon, capply, gumstrip, bias textile), and Aquila narrow slitter to convert the secondary rolls to continuous strips as narrow as 10mm. To answer the new demand for slitting reduced width mother roll, we have adapted our well-known Orion G slitter. Mainly used for passenger and light truck tires, this compact and versatile ma-

chine could slit down to 20mm various products such as gum or bias from a mother roll up to 1,000mm width.

## CARTER INTERNATIONAL LTD

**Stand:** 4462

**Stand Representatives:** Peter Fletcher, Robert Vincent

**Address:** Unit B6 & B7, Fieldhouse Industrial Estate, Fieldhouse Road, Rochdale, OL12 0AA, UK

**Tel:** +44 (0) 1706 638301

**Email:** info@carter-mixers.co.uk

**Web:** www.carter-mixers.co.uk

Manufacturers of new and rebuilt internal mixers, tangential and intermeshing ranging from 1.5 liter laboratory size up to 270 liter. In-situ calendar re-profiling (honing). On-site mixer service and inspection. Bespoke mixer designs and improvements. Any make of mixer rebuilt.

## CIMA IMPIANTI SPA

**Stand:** 4404

**Stand Representatives:** Massimo Capecechi, Alessandro Vignolini

**Address:** Via Gora E Barbatole 192, Pistoia, I-51100, Italy

**Tel:** +39 0573 904 907

**Fax:** +39 0573 402 244

**Email:** info@cimaimpianti.com

**Web:** www.cimaimpianti.com

Cima Impianti SpA is one of the leading companies in Italy specialized in the manufacturing of curing presses for retreaded and new tires production, up to 63in in size. We introduce our RP 11 and RP 14 for OTR tires curing together with our large series of equipment for tire preparation and control.

## CHINA UNITED RUBBER CORPORATION

**Stand:** 4400

**Stand Representatives:** Jason Ma

**Address:** F/15 Entry C, No.19 Xiaoying Rd., Chaoyang Dist., Beijing 100101, P.R. China

**Tel:** +86 10 58650277

**Fax:** +86 10 58650288

**Email:** rubbertech@chrubber.com, reifen.china@chrubber.com

**Web:** www.rubbertech.com.cn / www.reifenchina.com

RubberTech China 2009, the ninth international exhibition on rubber technology, organized by China United Rubber Corporation, will stage during November 11-13, 2009 at Shanghai New International Expo Centre, Shanghai, P.R. China. The show will run parallel with REIFEN CHINA 2009. The exhibiting area of these two shows is estimated to reach 23,000m<sup>2</sup> covered with about 400 exhibitors interacting with 15,000 visitors.

## CIMCORP OY

**Stand:** 4535

**Stand Representatives:** Tero Peltomäki, Esa Valtonen, Kai Tuomisaari

**Address:** Satakunnantie 5, Ulvila, FI-28400, Finland

**Tel:** +358 2 6775 111

**Fax:** +358 2 6775 200

**Email:** info@cimcorp.com; firstname.surname@cimcorp.com

**Web:** www.cimcorp.com

Cimcorp offers comprehensive automation solutions for handling of green and finished tires in the tire manufacture processes: building machine unloading, tire transportation in the building area, green tire storage, curing press loading, tire sorting and buffering before testing, tire sorting and buffering after testing, tire palletizing, automatic warehousing and order picking. Our scope of supply includes robots, conveyors and peripheral equipment, as well as software and safety systems. We integrate a total solution and supply on turnkey basis.

**COLD TESTING LAPLAND****Stand:** 4725**Stand Representatives:** Toni Kraatari**Address:** Inari Municipal Business Company Ltd, Sairaallantie 3, Ivalo, FIN-99800, Finland**Tel:** +358 400 126 970**Fax:** +358 16 687 465**Email:** toni.kraatari@inlike.fi**Web:** www.northernmosttesting.com

Cold Testing Lapland. If you're looking for the toughest, coldest and longest winter conditions in which to test the performance of your cars, tires, rims, studs or components, take a trip up to the far north of Finland, to the Arctic region of Lapland. You'll find the extreme conditions you're looking for, six months a year, plus a great many companies, services and test tracks on hand to meet your needs in this highly specialized industry sector.

**COLLMANN GMBH & CO  
SPEZIALMACHINEBAU KG****Stand:** 4120**Stand Representatives:** Gerd Poppe**Address:** PO Box 2115, Luebeck, D-23509, Germany**Tel:** +49 451 890 960**Fax:** +49 451 890 9624**Email:** poppe@collmann.com

Collmann will take the opportunity to show its product portfolio for the tire industry at Tire Technology Expo in Hamburg, and will inform about its wide range of x-ray and measuring systems. Collmann is known worldwide for high quality standards and most durable and robust machines, always employing the latest technologies to the newest machines but also maintaining and servicing older models for over 50 years. Long-term relationships and satisfied customers are our capital today and in the future. Collmann GmbH & Co. Spezialmaschinenbau KG – Member of VMI Group, Moisinger Allee 224, 23558 Luebeck,

Germany; email: contact@collmann.com; www.collmann-tire.com.

**COMERIO ERCOLE SPA****Stand:** 4710**Stand Representatives:** Pier Giorgio Crespi, Renato Lualdi, Riccardo Comerio, Guglielmo Comerio**Address:** Via Castellanza 100, Busto Arzizio, I-21052, Italy**Tel:** +39 0331 488 411**Fax:** +39 0331 488 421**Email:** info@comerco.it**Web:** www.comerco.it

Rubber production program: internal mixer MCC series 2÷270 l; roll mixing mill MGC/MGP/MGS series 200÷2,540mm; complete mixing plant – 2,3,4 roll calendars with I, L, F, S, inclined configuration. Complete calendar lines for rubberizing of fabrics, steel and textile cord. Also, complete calendaring lines for rubber sheeting. Complete calendar lines for tires. Complete calendar lines for conveyor belts up to 3,500mm. The company comes with engineering know-how with turnkey plants all over the world.

**CONTINENTAL AG CONTI  
MACHINERY****Stand:** 4750**Stand Representatives:** Karsten Jung**Address:** Jaedekamp 30, Hannover, D-30419, Germany**Tel:** +49 511 976 6780**Fax:** +49 511 976 6086**Email:** cm@conti.de**Web:** www.conti-cm.com

Conti Machinery is offering products along the entire production chain for passenger, light truck tires and truck tires. Mixing: twin-screw sheeters, batch feeders, cooling lines preparation areas for bead winders, apex appliers, textile cutters and slitters tire building for uni-stage and two-stage tire building machines. Curing, spraying machines, mold cleaning machines final finishing and testing machines. This division has production in two locations: CM Hannover-Germany Jaedekamp 30, 30419 Hannover,

Germany, telephone: +49 511 976 6780; Fax: +49 511 976 6086. Also, CM Púchov-Slovak Republic Terézie Vansovej 1054, 020 01 Púchov-Slovak Republic Phone: +421 42 461 2080; Fax: +421 42 461 2085.

**CONTINENTAL AG CONTI  
BLADDERS****Stand:** 4750**Stand Representatives:** Martin Gonschior**Address:** Jädekamp 30, Hannover, 30419, Germany**Tel:** +49 511 976 4336**Email:** martin.gonschior@conti.de**Web:** www.conti-bladders.com

Conti Bladders has been established to focus all bladder-related expertise and resources from various areas of corporation into one organization to better serve the customers. It is committed to creating value for its customers worldwide by providing high-quality curing and tire building bladders at competitive prices. Triggered by customers' specific requirements, the company develops new solutions for curing and tire building bladders.

**CYBERNETIX****Stand:** 4555**Stand Representatives:** Thierry Currenti, Frédéric Isnard**Address:** Technopole De Chateau-Gombert, 306 Rue Albert Einstein, BP 94, Marseille, F-13382, Cedex 13, France**Tel:** +33 4 4207 4222**Fax:** +33 4 4207 4236**Email:** murielle.drouin@cybernetix.fr

A specialist in non-destructive testing, Cybernetix provides a full range of x-ray inspection and metrology equipment for passenger, truck and OTR/earthmover tires. With CyXPert, automatic defect detection software, and superior image resolution, the Cybernetix machines bring effective

inspection solutions for high quality standards on the tire production lines. Cybernetix complements its machines with upstream tire identification solutions such as the color code and tread pattern recognition-based IDENTIX, or barcode identification systems, and downstream marking and sorting systems. From fully automated implementations to off-line analysis by 2D x-ray, computed tomography and optical control, Cybernetix offers a broad range of engineered products for demanding tire manufacturers.

### DAHMEN GMBH

**Stand:** 4005

**Stand Representatives:** Bernd Dahmen, Armin Kraus, Juergen Schmidt  
**Address:** Werner-Heisenberg Strasse 11, Alsdorf, 52477, Germany  
**Tel:** +49 (0) 2404 94400  
**Fax:** +49 (0) 2404 94408

**Email:** kontakt@dahmen-gmbh.com

**Web:** www.dahmen-gmbh.com

Dahmen specializes in the production of tire molds of all sizes. We are committed to the direct engraving method. This technology has been strongly developed by Dahmen over the years. We are now in a position to manufacture all kinds of patterns even with large number of sipes, meeting the economical expectations of the market. The range of molds covers: motorcycle, passenger car, light truck, truck and bus radials up to large OTR molds of 63in rim diameter. Molds can be produced in aluminum or steel based on the customer's specification.

### DATA2 CORPORATION

**Stand:** 4344

**Stand Representatives:** John Ingerslew, Robert Van Der Laan  
**Address:** 222 Turner Boulevard, St Peters, MO 63376-1079, USA  
**Tel:** +1 636 278 8888 Ext. 371  
**Fax:** +1 636 278 2180  
**Email:** maryelizabeth@data2.com

Major tire manufacturers around the world rely on Data2 labels for tracking tires and

raw material components through the entire manufacturing process. Whether attached to the bead, sidewall or tread, they perform – and they arrive on time so your plants operate smoothly. Data2's partnership with Gislottica Lda provides an experienced team to assist global tire manufacturers with plant automation, including individual tire identification, tire handling equipment, and data collection interface software. The Data2-Gislottica team can work with your project team from design through implementation and ongoing operation.

### DOLI ELEKTRONIK GMBH

**Stand:** F7

**Stand Representatives:** Rolf Grupp  
**Address:** Adi-Maislinger-Str. 7, München, 81373, Germany  
**Tel:** +49 6130 944 250  
**Fax:** +49 6130 944 251  
**Email:** sales@doli.de  
**Web:** www.doli.de

The tire/rubber industry knows Doli as the supplier of manual and fully automated standard and ultimate flexometers. The Ultimate Flexometer performs tests exactly and not just similar to the standards ISO\_4446-4 and JIS\_K\_6265. Doli as a supplier of electronics for testers, offers linear motors, controllers and software for all kinds of dynamic tests inclusive of viscoelastic properties. Since 1979, Doli has been modernizing testing systems of all brands. Whereas mainly static testers were modernized, Doli now covers the whole spectrum: from the linear motor in the low-load range to the dynamic-hydraulic system in the meganewton-range. And Doli realized tension/torsion- and biaxial applications.

### DR NOLL GMBH

**Stand:** 4755

**Stand Representatives:** Albrecht Noll, Hartwig Suhr, Josef Eble, Ralf Hahn  
**Address:** Nikolaus-Otto Strasse 13, Bad Kreuznach, D-55543, Germany  
**Tel:** +49 671 79 499614  
**Fax:** +49 6717948302

**Email:** service@drnoll.de

Supplier of camera and laser-based measuring systems for the tire industry. Online and offline profile measuring systems for tread, inner-liner, sidewalls, apex, textile cord, steel cord. High-precision scanning systems and fast light intersection (sheet of light) systems. Camera-based system to measure width and length of cut tread and sidewalls after skiver. Camera-based system to control and check position and color of painted lines at the treads in the extrusion line. Laser and camera systems to support the tire building process. Checking of splice, layer thickness, center position, etc. Profile measurement and bulge and dent systems for finished tires.

### DR D. WEHRHAHN

**Stand:** 4315

**Stand Representatives:** Dirk Wehrhahn, Martin Hauk  
**Address:** Hildesheimer Strasse 140, Hannover, 30173, Germany  
**Tel:** +49 0511 512665  
**Email:** shanke@drwehrhahn.de  
**Web:** www.drwehrhahn.de

Dr. D. Wehrhahn Measuring Systems has been supplying customized solutions for measuring tasks in all branches of the industry for more than 10 years. The OPTImess laser triangulation sensor as a non-contact measured value sensor has been used as a reliable and universally applicable instrument in production regulation and quality inspection in many sectors of the tire and automotive industry. Furthermore, our OPTImess 2D light section sensor represents a further development of the OPTImess 1D. In this new sensor, the punctiform laser beam is widened to a line. By projecting this laser line onto a CCD matrix sensor, a 2D measurement along the line is possible.

**ELECTRONIC SYSTEMS SPA****Stand:** 4707**Stand Representatives:** Paolo Calciati**Address:** SR 229 KM 12,200, Momo, I-28015, Novara, Italy**Tel:** +39 0321 928 210**Fax:** +39 0321 926 855**Email:** Paolo.calciati@electronicsystems.it**Web:** www.electronicsystems.it

This year Electronic Systems SpA is celebrating its 30-year anniversary. It has installed across the world more than 4,000 measurement systems for different applications (rubber and PVC calendaring, extrusion coating, sheet and foils, abrasives, coating and laminating, adhesive tapes, nonwovens, cast film, blown film, etc). The Electronic Systems production range includes: thickness and weight measurement systems based on different technologies such as air, beta and infrared sensors; web defects inspection systems; dosing systems, and automation control lines.

**ELISTO GMBH****Stand:** 4155**Stand Representatives:** Klaus-Dieter Nies**Address:** Robert Bosch Strasse 15, Diez/Lahn, D-65582, Germany**Tel:** +49 2732 559 790**Fax:** +49 2732 559 7915**Email:** e.hardenacke@elisto.de

Heat insulation technologies for tire curing presses. Thermostar products, developed by elisto GmbH, headquartered in Diez, Germany, have stood the test for two decades in all fields of high-performance insulation technology. The high quality of Thermostar products is based on many years of research and development, focused on the requirements of discerning customers from tire industries and the challenge of technical innovation. elisto GmbH is providing insulation plates with a high-tech coating to several well-known tire production plants. This coating offers excellent resistance to oil and chemical pollution.

**ERHARDT+LEIMER GMBH****Stand:** 4720**Stand Representatives:** Hartmut Boessmann**Address:** Postfach 10 15 40, Augsburg, D-86136, Germany**Tel:** +49 821 2435 508**Fax:** +49 821 2435 500**Email:** n.schmidt@erhardt-leimer.com**Web:** www.erhardt-leimer.com

For more than 85 years Erhardt+Leimer, has been a specialist for system solutions and automation technology on running webs. It ranks worldwide among the leading manufacturers of measuring and control technology. For the tire and rubber industry we offer tailored solutions for dip and hot stretching lines, calendars, extrusion lines, cutters, tire building machines and special applications. Given our experience of so many years and the expertise of our development staff, our response to customer demands is fast and flexible.

**FARREL LIMITED****Stand:** 4320**Stand Representatives:** Lucie Kucerova**Address:** Queensway, Castleton, PO Box 27, Rochdale, Lancashire, OL11 2PF, UK**Tel:** +44 1706 837 351**Fax:** +44 1706 719 435**Email:** lkucerova@farrel.com**Web:** www.farrel.com

Farrel is a leading manufacturer of rubber and plastic polymer processing equipment. Our line of Banbury, Intermix and Continuous Mixers, extruders, pelletizers, gear pumps, mills and laboratory equipment serves numerous industries worldwide, which depend on our commitment to technological innovation. As the owner of the two 'original technologies' with the first Banbury mixer introduced in 1916 and the first Intermix in 1939, Farrel has distinctive competence in all areas of tire

compounding. We provide the machinery and systems to meet and exceed our customers' expectations.

**FEDERAL-MOGUL DEVA GMBH****Stand:** 4576**Stand Representatives:** Jürgen Reiningner**Address:** Schulstrasse 20, Stadallendorf, D-35260, Germany**Tel:** +49 6428 701131**Fax:** +49 6428 701108**Email:** josef.schumacher@federalmogul.com**Web:** www.deva.de

In countless industrial application sectors, the name Deva has a long-standing reputation and Deva maintenance-free, self-lubricating sliding bearings are indispensable. At our Stadallendorf location in Germany, we use state-of-the-art equipment to develop and manufacture bearings from 1-3,500mm in diameter. With our highly motivated team, we have one aim: to constantly reaffirm the satisfaction of our customers, thus ensuring steady growth in demand for Deva products.

**FIRESTONE INDUSTRIAL PRODUCTS****Stand:** 4402**Stand Representatives:** Mark Hilburger**Address:** 250 West 96th Street, Indianapolis, IN 46260, USA**Tel:** +1 317 818 8615**Fax:** +1 317 818 8758**Email:** byeramanda@fsip.com**Web:** www.firestoneip.com

Firestone Industrial Products has been a leading manufacturer of tire assembly machine bladders, sleeves and accessories for over 35 years. Developed in cooperation with top manufacturers, our broad product line includes a variety of standard and custom-produced bladders and sleeves. Each is backed by individualized technical support



# We Know All About Tire Manufacturing Through Our Own World-Famous Tire Brand

**Conti Machinery** is offering machines for the material preparation area for the production of passenger, light truck and truck tires. The specific customer's requirements are being tailored.

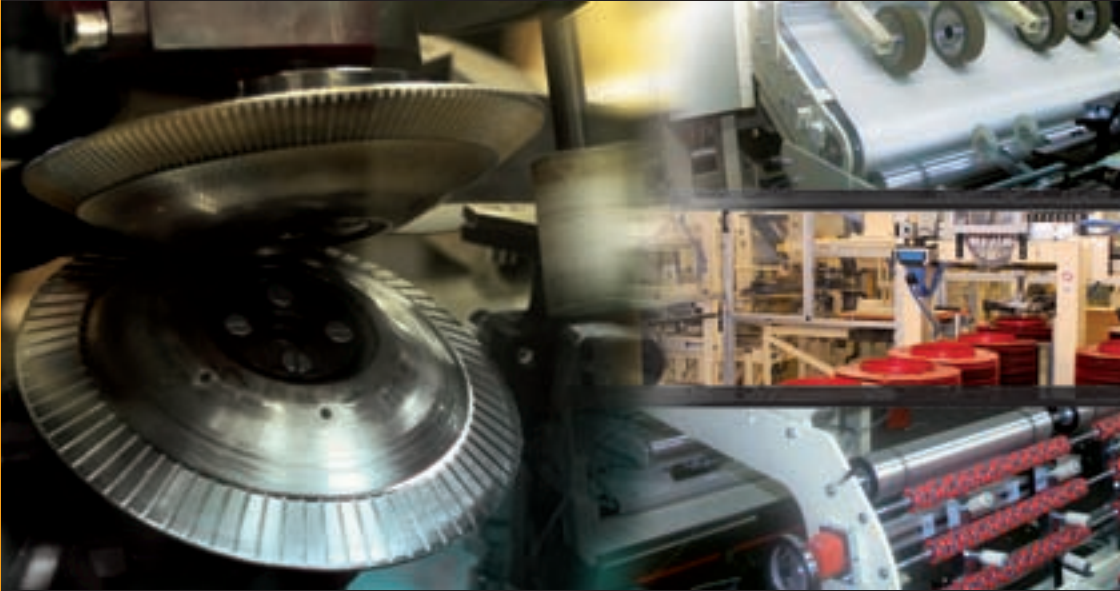

Mixing Extrusion Calendering	Preparation	Tire Building	Spraying and Curing	Final Finishing
Twin-screw Sheeter	Textile Cutter	First Stage Passenger TBM	Spraying Machine	Endurance PC Tire Test Stand
Batch Feeder	Maxi Slitter	Second Stage Passenger TBM	Control for Curing Presses	Uniformity Test Machine
Batch Off	Strip Cutting Machine	2 Drums Unstage Passenger TBM	Hydraulic Presses - Column	
	Passenger Bead Winder	3 Drums Unstage Passenger TBM	Hydraulic Presses- Frame	
	Passenger Apex Applier	2 Drums Unstage Truck TBM	Truck Molds and Containers	
	Truck Apex Applier	3 Drums Unstage Truck TBM	Automatic Dry Ice Mold Cleaner	
	Super Assembly Line			

**CM CONTI MACHINERY**

Continental AG  
CM Hannover – Germany  
Jädekamp 30, 30419 Hannover – Germany  
Phone: +49 511 976-6780, Fax: +49 511 976-6086  
e-mail: [cm@conti.de](mailto:cm@conti.de), Web: [www.conti-cm.com](http://www.conti-cm.com)

Continental AG  
CM Puchov – Slovak Republic  
Terézie Vansovej 1054, 020 01 Púchov – Slovak Republic  
Phone: +421 42 461-2080, Fax: +421 42 461-2085  
e-mail: [cm@conti.de](mailto:cm@conti.de), Web: [www.conti-cm.com](http://www.conti-cm.com)





unmatched in the industry. Our bladders and sleeves are produced under strict quality standards that result in improved bladder uniformity and extended life, which provide consistent tire uniformity and lower manufacturing costs. Our quality, experience and support have made us one of the world's preferred suppliers of bladders, sleeves and accessories.

## GABO QUALIMETER TESTANLAGEN GMBH

**Stand:** F4

**Stand Representatives:** Herbert Halm, Horst Deckmann, Ronald Gaddum, Hofmann Elke

**Address:** Schulstrasse 6, Ahlden/Aller, D-29693, Lower Saxony, Germany  
**Tel:** +49 5164 8019 0

**Fax:** +49 5164 8019 40

**Email:** info@gabo.com

**Web:** www.gabo.com

Supplier of the two in one tackiness and DMA testers: Gabotack and Eplexor. In 2008 Gabo GmbH launched a new type of tackiness tester on the market. This instrument is a 'two-in-one' combination made from Gabo GmbH DMA series (Eplexor 500N), and from the Flexometer models (Gabometer 2000/Gabometer 4000) and the Gabotack system to analyze the (auto-) adhesive behavior of an elastomer. Gabo Qualimeter introduced the Gabotack system, based on a patented technique to detect the tackiness of so-called green tires. The Gabotack was introduced to the market in 2007.

## GEPAC GESELLSCHAFT FUER POLYMERCHEMIE MBH

**Stand:** 4325

**Stand Representatives:** Derek Cornils

**Address:** Forstweg 27, Niederzier, D-52382, Germany

**Tel:** +49 2428 9020 28

**Fax:** +49 2428 9020 36

**Email:** info@gepoc.de

**Web:** www.gepoc.de

Gepoc was founded in 1971 and distributes the Marbo Release agent product range in Germany. We offer technical support, on-site help and trials. With our central storage in Germany we are able to suit all your release agent needs and delivery on time everywhere in Germany.

## GFA DE PRYCK & CO

**Stand:** 4210

**Stand Representatives:** Dirk De Pryck, Gerhard Hartmann, Gerda Verbanck

**Address:** Sedan Str 32-34, Elze, D-31008, Germany

**Tel:** +49 5068 93020

**Fax:** +49 5068 930210

**Email:** dirk.depryck@gfa-automation.de

**Web:** www.gfa-automation.de

GfA De Pryck & Co mbH is a machine supplier for the tire production industry. The main products are bead winding lines, cap strip lines, cap-ply cutting machinery and tire inspection machines. Furthermore, the company supplies special solutions and upgrades of machinery with new automation systems. Since the beginning, GfA's automation department has been very strong. Experience for the complete tire production process is available. GfA is your partner for mechanical and electrical engineering as well as for the supply of machinery and automation.

## GISLOTICA LDA

**Stand:** 4344

**Stand Representatives:** Alexandre Moreira, Humberto Ramos

**Address:** Rua Sidonio Muralha, 12, Perafita, 4455-554, Portugal

**Tel:** +351 229951782

**Email:** alexandre.moreira@gislotica.pt

**Web:** www.gislotica.pt

Gislotica is an engineering company specializing in the study and constructing of special equipment for the worldwide tire industry. Examples include the geometry machine inspection machine (VITEC), gum edging machine, warp belt machine, lubri-

cator machine, creel robotized system, multi green tire stand wind-up station, cutting machine and light box marker system. We implement a sequence of systematic improvements to ensure innovative products.

## GLEBUS ALLOYS LLC

**Stand:** 4349

**Stand Representatives:** Jim Parmelee

**Address:** 1006 Hampton Ridge Drive, Akron, Ohio, 44313, USA

**Tel:** +1 330 867 9999

**Fax:** +1 330 865 0862

**Email:** jim.parmelee@glebusalloys.com

**Web:** www.glebusalloys.com

## GLEBUS ALLOYS SRO

**Stand:** 4349

**Stand Representatives:** Michael Stefanidis, Katarina Dvorakova, Jim Parmelee, Mike Coleman

**Address:** Masarykovo Namesti 1294, Nachod, 547 01, Czech Republic

**Tel:** +420 491 421 211

**Fax:** +420 491 421 240

**Email:** sales@glebusalloys.com

**Web:** www.glebusalloys.com

Glebus Alloys manufactures self-lubricated wear plates used in tire mold containers, and is an approved vendor supplying to many of the world's leading tire manufacturers. Glebus Alloys is pleased to announce our new spring vent technology in 2009. Glebus spring vents allow tire manufacturers an innovative cost-effective solution to eliminating rubber spew from the finished tire. Glebus Alloys is committed to serving customers with quality environmentally friendly products.

## GUDEL AG

**Stand:** 4420

**Stand Representatives:** Daniele Marco Galatioto, Roger Deburgrave, Silvano Tremolada, René Giger, Martin Benz

**Address:** Industrie Nord, Langenthal, CH-4900, Switzerland

**Tel:** +41 62 916 9299

**Fax:** +41 62 916 9150

**Email:** rita.hallauer@ch.gudel.com

A supplier of automation solutions for green tire and finished tire warehouse. Manufacturer of robots for palletizing of tires. The Güdel Components help to build machines, special equipment and automation with a minimum of engineering and a maximum of reliability.

## HABASIT AG



**Stand:** 4010

**Stand Representatives:** Thilo Merkt, Johannes Altmann, Jens Niepmann

**Address:** Römerstrasse 1, Reinach-Basel, CH-4153, Switzerland

**Tel:** +41 61 715 1515

**Fax:** +41 61 715 1555

**Email:** info@habasit.com

**Web:** www.habasit.com

Habasit is the only full range supplier with a one-stop shop solution for all belting needs. The product range covers power transmission belts, textile belts, plastic modular belts as well as slat and conveyor chains out of its own development and production. Habasit application engineers and technicians are at your disposal to provide professional consulting, superb customer service and excellent support. Since its foundation in 1946, Habasit has proved the understanding of customer needs for about 60 years. With a comprehensive global network, Habasit is able to respond to any belting request that you may have for rubber processing, tire manufacturing as well as finished tire handling.

## HAGGLUNDS DRIVES AB

**Stand:** 4220

**Stand Representatives:** Jennifer Eiben

**Address:** Vasterselevagen, Mellansel, SE-890 42, Sweden

**Tel:** +46 660 876 38

**Fax:** +46 660 87160

**Email:** info@se.hagglunds.com

Häggglunds Drives is a global leader in the hydraulic motors and drive systems niche. The group develops, manufactures and markets drive system solutions for high torque, low speed and variable speed applications. Häggglunds drive systems are used in a wide range of industries, such as mining and materials handling, recycling, marine and offshore, pulp and paper, rubber and plastic, sugar, building and construction.

## HARBURG-FREUDENBERGER MASCHINENBAU GMBH

**Stand:** 4225

**Stand Representatives:** Sabine Sergel, Gerd-Holger Studdt, Harald Keuter, Natascha Loew, Guenter Simon

**Address:** Seevestr 1, Hamburg, D-21079, Germany

**Tel:** +49 40 77 179 370

**Fax:** +49 40 77 179 407

**Email:** sabine.sergel@hf-group.com

**Web:** www.harburg-freudenberger.com

Harburg-Freudenberger Maschinenbau GmbH is the only worldwide single-source supplier of the complete range of machinery for the rubber and tire industries. We will be presenting our latest technology and developments on machinery for the production of tires. Additionally we will be taking the opportunity to show the latest designs in mixing, extrusion, tire building and tire curing equipment at our workshop nearby in Hamburg-Harburg. We are looking forward to meeting our customers and of course, there will be the chance to discuss our complete product range with our experienced sales and technical teams.

## HERBERT MASCHINENBAU GMBH & CO



**Stand:** 4550

**Stand Representatives:** Matthias Walter, Martin Grosch, Thorsten Weiß, Christian Gärtner, Bernd Schmitt

**Address:** Industriestrasse 10, Huenfeld, D-36088, Germany

**Tel:** +49 6652 609146

**Fax:** +49 6652 609111

**Email:** bernd.schmitt@herbert.eu

**Web:** www.herbert.eu

Herbert – Tire Industry Supplier of the Year. 2008 has been an eventful year for Herbert. During Tire Technology Expo in Cologne, Herbert received the award for the Tire Industry Supplier of the Year. Herbert is the leading supplier of engraved molds with in-house production from motorcycles up to giant OTR-mold sizes (O.D. up to 6,500mm). Furthermore, Herbert has successfully launched the HCP-52" column type press and enlarged the product range for column type curing presses up to an independent operating HCP-66" press for modern TBR production. We also provide the well-known and reliable AUBO-Series of presses from 44in up to 66in for curing tires from motorcycle up to all TBR sizes.

## HIROTEK INC

**Stand:** 4530

**Stand Representatives:** Hironobu Ichimaru

**Address:** 616 Oaza Tsunemochi, Chikugo City, 833-0016, Fukuoka, Japan

**Tel:** +81 942 485188

**Fax:** +81 942 537596

**Email:** sales@hirotek.co.jp

**Web:** www.hirotek.co.jp

Hirotek will be demonstrating a variety of prime components related to tire curing machines, including various 'center mechanism' (water driven/oil hydraulic/electrically driven, etc.), vertical loader system, upper container auto-clamp devices for PC/LT and TB press, water cylinders for segmental

**GIVE US YOUR EXPECTATIONS...WE'LL GIVE YOU PERFECTION!**

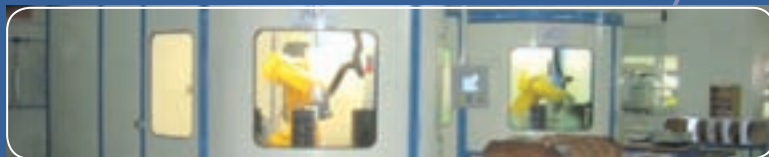

**STATE OF THE ART TECHNOLOGY**

- **Casting technologies:** High & low pressure
- **Ventless molds:** Aluminium
- **Full engraving:** Aluminium & steel

**REDUCE TIME TO MARKET**

- **Engineering • Programming • Manufacturing • Quality control**
- **Production ready • Maintenance program**



**SERVING OUR CUSTOMERS WORLDWIDE**  
**Europe • Middle East • Asia • America**

**CONTACT US:** [info@ad-deshors-mo.com](mailto:info@ad-deshors-mo.com) – [www.adgroupe.com](http://www.adgroupe.com)



# WERBA

**TAP YOUR FULL OPTIMIZING POTENTIAL WITH**

**WERBABLEND®**

**Homogenizers, Plasticizers, Tackifiers**

**WERBALINK®**

**Functional Fillers**

**WERBATEC®**

**Multifunctional Processing Promoters**

**WERBALUB®**

**Dispersants, Lubricants**

**See you at**

**Tire Technology Expo 2009**

**17<sup>th</sup>, 18<sup>th</sup>, 19<sup>th</sup> February 2009**

**Hamburg Messe, Germany**

**Stand no. F5**

**WERBA-CHEM GmbH**

Lugeck 1, A-1010 Vienna - Austria | Tel.: +43 1 51490 - 0 | Fax: +43 1 51490 - 20 | [www.werba.com](http://www.werba.com) | Email: [rubber@werba.com](mailto:rubber@werba.com)

mold/loader swing, and steam joint assembly. Hirotek pursues the development of products that correspond to the needs of all customers, from maintenance, renewal and utilization, and remodeling and improvement of old plants and equipment, to the newest manufacturing methods. Hirotek communicates with its customers and takes what they actually want and puts it into a concrete proposal.

### **HOFMANN MASCHINEN- UND ANLAGENBAU GMBH**

**Stand:** 4523

**Stand Representatives:** Jörg Möller,  
Tanas Manolevski

**Address:** Altrheinstrasse 11, Worms,  
D-67550, Germany

**Tel:** +49 6242 904 101

**Fax:** +49 6242 904 286

**Email:** heidi.schelian@  
hofmannmaschinen.com

**Web:** www.hofmannmaschinen.com

A supplier of testing equipment for tires, rims and wheels: tire uniformity machines (RGM-E/-G), automatic tire grading line ATG-E/ATG-G, dynamic and static balancing machines for tires, rims and wheels with the Hofmann sheet-of-light laser geometry measurement system GEO-SLS, bead compression machines WKM-B4, fully automatic wheel and tire mounting lines.

### **IKS KLINGELNBERG GMBH**

**Stand:** 4265

**Stand Representatives:** Volker  
Kölsch, Andreas Münch

**Address:** In Der Fleute 18, Remscheid,  
D-42897, Germany

**Tel:** +49 2191 969 318

**Fax:** +49 2191 969 4318

**Email:** jraida@interknife.com

**Web:** www.interknife.com

IKS Klingelberg GmbH is one of the leading suppliers for industrial machine knives and tools. With an extensive network of specialized divisions that are convenient to all parts of the world, we offer diversified products and comprehensive services to

a wide range of industries. To ensure customer satisfaction and the finest products, our cutting tools and knives incorporate the latest technological achievements and are manufactured according to the most challenging quality control standards. We 'performance match' the tailor-made knife or tool for your applications and recommend material grades, design and alternative cutting concepts.

### **ILMBERGER GMBH**

**Stand:** 4412

**Stand Representatives:** Irene  
Ilmberger, Erich Ackermann, Bernd Fett

**Address:** Albrecht-Duerer-Str. 28,  
Straubing, D-94315, Germany

**Tel:** +49 94 21 541 0

**Fax:** +49 94 21 541 82

**Email:** info@ilmberger.de

**Web:** www.ilmberger.de

Ilmberger is a worldwide operating specialist in the area of green tire spraying machines. With more than 40 years' experience in development and manufacturing, we are able to offer suitable systems for almost all requirements. Among other things we have already built machines for higher performance (spraying up to 18 tires per minute), for extremely large tires (external diameter up to 3.5m) or for special applications like not spraying the inner-liner splice.

### **INDSPEC CHEMICAL BV**

**Stand:** 4006

**Stand Representatives:** Joerg  
Pommerenke, Marc De Groote, Terence  
Dee

**Address:** Gebouw De Goudsesingel,  
Kipstraat 8-10, Rotterdam, NL-3011 RT,  
Netherlands

**Tel:** +31 10 275 6060

**Fax:** +31 10 414 3035

**Email:** Jorg\_Pommerenke@oxy.com

**Web:** www.indspec-chem.com

Indspec is a major producer of Resorcinol and produces a full line of Penacolite resins, to increase rubber adhesion to steel and organic fabric cords. The resins are available as

liquids for fabric dipping and solids for compounding. Indspec will be highlighting the benefits of new resorcinol-blocked isocyanate resins for polyester adhesion, in particular, Penacolite Resin I-868-C for compounding, Penacolite Resin I-168-L for adhesive activated polyester and Penacolite Resin I-868-D for precoating non-adhesive activated polyester systems. Ulti-Pro 100 reactive processing aid for higher hardness and better processing of compounds will also be featured.

### **INTEREUROPEAN SRL**

**Stand:** 4445

**Address:** via Della Moia 1, Arese,  
Milano, I-20020, Italy

**Tel:** +39 0 2 9384351

**Fax:** +39 0 2 93582520

**Email:** info@intereuropean.it

**Web:** www.intereuropean.it

### **INTRALOX LLC EUROPE**

**Stand:** 4345

**Stand Representatives:** Beate  
Fremdling

**Address:** Lemelerbergweg 20, 1101 AJ  
Amsterdam, PO Box 23280, Amsterdam,  
NL-1100 DT, Netherlands

**Tel:** +31 20 540 3600

**Fax:** +31 20 564 5500

**Email:** Intralox.Europe@intralox.com

**Web:** www.intralox.com

Intralox, the global manufacturer that invented modular plastic belting, will highlight proven, innovative conveyance solutions for tire manufacturers at Tire Technology Expo 2009. As a partner to major tire manufacturers, Intralox continually seeks to develop innovative conveyance solutions designed to respond to the specific challenges of the tire industry. Committed to ongoing research and development of new technology and services, Intralox helps tire manufacturers optimize performance in each stage of tire production – from mill-room to final finish. By providing no-risk conveyance solutions and services, Intralox helps manufacturers worldwide achieve their operational business goals.



*more than 70 years of excellence*



X-Ray Systems

Measuring Systems

Grinding Machines

Buffing Machines

Building Machines

Testing Equipment

See us at booth nr. **4120**

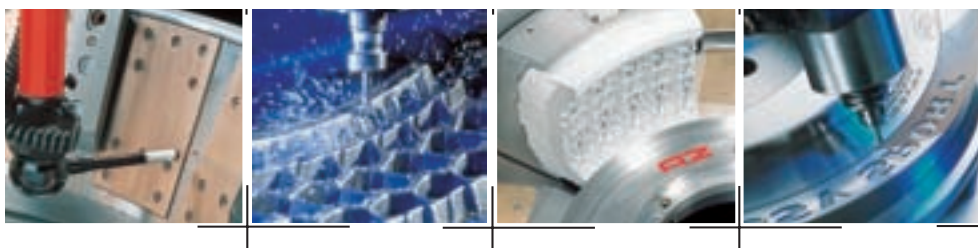

## THE **TIRE** **MOLDING** COMPANY **SINCE 40 YEARS**

### LINE OF PRODUCTS

Molds for tire curing in all sizes  
In 2 piece or radial construction  
Mold closing systems  
AZ Container systems (WORLD PATENTS)  
Machines for mold production

### IN HOUSE PRODUCTION FACILITIES

Precision foundries for tread pattern in AL & IRON  
Tread pattern production by engraving in AL & STEEL  
Complete production process by CAD & CNC equipment



### **A-Z FORMEN- UND MASCHINENBAU GMBH**

Dessauerstraße 9 · 80992 München · Germany  
Phone + 49-89-14 9817-0 · Fax + 49-89-14 9817-90  
[info@a-z-gmbh.de](mailto:info@a-z-gmbh.de) · [www.a-z-gmbh.de](http://www.a-z-gmbh.de)



## JOVISION

**Stand:** 4565

**Stand Representatives:** Islam

Shdaifat, Moath Al-Shyoukh

**Address:** Horner Weg 42 A, Hamburg, D-20535, Germany

**Tel:** +49 17624291904

**Email:** i.shdaifat@jo-vision.com

**Web:** www.jo-vision.com/

JoVision Co is delighted to introduce JoInspector, the anomaly detection software. JoInspector complements x-ray-based inspection systems and employs modern, high-performance image processing algorithms, making tire inspection fully automated. Packages, include analyzing ply, breaker, chafer, bead and SPC, are integral parts of JoInspector. JoVision also presents its tire laser JoTL software, a highly efficient solution for laser tire inspection. JoTL utilizes nonlinear surface regression calculations to estimate the tire base-surface, offering a precise impressive and lettering pattern suppression. Features include detection of tire dimensions, and 2D defect detection in a complete tire scan.

## KARA GOSTAR ENG CO

**Stand:** 4515

**Stand Representatives:** Masoud Navabi

**Address:** 2nd Koysanat St., Town Of Qhods, Karaj Old Road, Tehran, 1998184713, Iran

**Tel:** +98 262 382 6142 - 384 8781

**Fax:** +98 262 384 8785

**Email:** navabi@karagostar.com

**Web:** www.karagostar.com

## KOBELCO STEWART BOLLING INC

**Stand:** 4432

**Stand Representatives:** Brian Hastings, Chris Wenhold, Richard Jorkasky, Hiroki Toyoizumi

**Address:** Kobe Steel Group, 1600 Terex Road, Hudson, OH 44236, Ohio, USA

**Tel:** +1 330 655 3111

**Fax:** +1 330 655 2982

**Email:** information@ksbi.com

**Web:** www.ksbiusa.com

Kobelco Stewart Bolling Inc (Kobelco) is a world leader in the manufacture of tire, rubber and plastics machinery. A truly global company with amazing capabilities and resources, Kobelco can help you respond to the changing competitive environment. Our comprehensive line-up of high-performance rubber and plastics process machinery includes: internal intensive mixers, tilt-discharge mixers (economix and four-post designs), twin screw roller head extruders (TSR), two-roll mills, calenders, and tire curing presses. Kobelco machinery is recognized worldwide for innovative designs, high operating efficiencies and machine uptime.

## KOM-TRON SYSTEMTECHNIK

**Stand:** 4406

**Stand Representatives:** Ralf Berres, Wolfgang Berres, Marco Pesie

**Address:** Claude-Dornier-Str. 8-10, Bitburg/Flugplatz, D-54634, Germany

**Tel:** +49 6561 9660 0

**Fax:** +49 6561 966006

**Email:** r.berres@kom-tron.de

The tailor-made solution for your requirement in testing and service. Hardware and software development for automotive business; QM technology development; retrofit technology; prototyping and concept analysis; MTS retrofit converting and modernization; own development and products load deflection testing; LDF high-speed linear friction testing; HSLFT pressure map scanning and reading; PMS footprint scanning and reading; FPS low- and high-speed endurance testing; HSE Rowling resistance testing; RR fuel pump endurance testing; FPE fuel pump characteristic testing; FPC hydraulic pump and motor testing; safety and guard systems, and worldwide machinery moving.

## KONSTRUKTA-INDUSTRY AS



**Stand:** 4135

**Stand Representatives:** Vladimir Ulicky

**Address:** K Vystavisku 13, Trenčin, 912 50, Slovakia

**Tel:** +421 42 461 2075

**Fax:** +421 42 461 2085

**Email:** sales@kotaind.sk

**Web:** www.kotaind.sk

A provider of tire manufacturing equipment; cutting technology; steel cord cutting lines for breaker cutting and splicing and for body ply cutting and splicing; textile cord cutting lines for body ply cutting and splicing extrusion technology; cold and hot feed extruders for bead wire rubberizing and for apex production and for feeding systems. The company also provides: multiple extrusion lines, for apex production, for sidewall production and for tread production; roller-head extrusion lines for inner-liner production, for composite rubber production and for rubber strip production.

## KRAUSSMAFFEI BERSTORFF GMBH

**Stand:** 4015

**Stand Representatives:** Hans-Georg Meyer, Uwe Wagner

**Address:** An Der Breiten Wiese 3-5, Hannover, D-30625, Germany

**Tel:** +49 511 570 20

**Fax:** +49 511 561916

**Email:** andreas.weseler@kraussmaffei.com

**Web:** www.kraussmaffei.com

KraussMaffei Berstorff is a system supplier capable of offering single vendor solutions for all the main plastics and rubber extrusion processes. These include: rubber technology, extruders and extrusion lines, rubber calenders, rubber

and TPE profile manufacturing lines and V-belt production equipment.

## KURSCHAT GMBH

**Stand:** 4217

**Stand Representatives:** Markus Schinke

**Address:** Lueneburger Schanze 16, Buxtehude, D-21614, Germany

**Tel:** +49 4161 71530

**Fax:** +49 4161 71535

**Email:** info@kurschat-gmbh.de

New low-cost traversing laser micrometers. For many years, Kurschat GmbH from Germany has been an established supplier of measuring equipment for the thickness and profile measurement of tread, inner-liner, sidewalls, etc. The new laser micrometers with different openings lengths from 300 to 1,100mm come with dynamic traversing axis, controller and various software packages for measuring, visualization, tolerance control, automatic calibration, data export and interfaces. They are especially designed for easy integration in existing production lines. The high-precision sensors for rubber applications have a resolution of and a sampling rate up to 50kHz.

## LANG GMBH & CO KG

**Stand:** 4451

**Stand Representatives:** Wilfried Hofmann, Andreas Steidel, Thomas Kozian, Martin Schmidt

**Address:** Dillstrasse 4, Huetttenberg, D-35625, Germany

**Tel:** +49 6403 7009 0

**Fax:** +49 6403 7009 40

**Email:** sales@lang.de

**Web:** www.lang.de

This year Lang is presenting its new machine for tire profile segments. With the five-axis HSC system MC 500 Lang sets new standards in precision and rapidity. The high-quality four-axis CNC servo engraving system LGT-S in combination with the LTire software is the leading system for the efficient construction of the total design of tire sidewall molds. Now Lang offers the

complete range of machines necessary for tire mold production. Everything from one source. The strength of Lang combines the continuous development of machines and software to meet the requirements of the market and our customers.

## LAP GMBH

**Stand:** 4408

**Stand Representatives:** Christoph Dorn

**Address:** Zeppelin Strasse 23, Lueneburg, D-21337, Germany

**Tel:** +49 4131 951126

**Fax:** +49 4131 951196

**Email:** c.dorn@lap-laser.com

Lap develops, produces and distributes line lasers and systems for dimensional measurement.

## LASER-MED GMBH

**Stand:** 4150

**Stand Representatives:** Gerd Schnorrenberg

**Address:** Schmidtheimer Str. 15, Dahlem, D-53949, Germany

**Tel:** +49 2447 91797 0

**Fax:** +49 2447 91797 11

**Email:** info@laser-med-gmbh.de

**Web:** www.laser-med-gmbh.de

Laser-Med GmbH develops and builds high-quality industrial laser solutions. We will present our newly developed green laser, capable of extremely small measurements. Also we will show the second version of our PLC-controlled laser positioning system LaserBox AMxxxB. The new LaserBox can control up to 10 positioning systems with only one control unit, so you can use it on the first and second stage of your TBM. The LaserBox supports almost every fieldbus and the open control unit makes it easy to implement the LaserBox in your existing production systems.

## LEONHARD BREITENBACH GMBH

**Stand:** 4686

**Stand Representatives:** Juergen Boehlemann, Uwe Fischer

**Address:** PO Box 11 11 52, Siegen, D-57081, Germany

**Tel:** +49 271 3758 0

**Fax:** +49 271 3758 290

**Email:** j.boehlemann@breitenbach.de

**Web:** www.breitenbach.de

Breitenbach's manufacturing program for the rubber and tire industries comprises high-precision calender and mixing rolls as well as heat transfer and chill rolls of different design types. Based on well-proven quality and precision, as well as short delivery times, rolls made by Breitenbach have gained an excellent reputation within the rubber and tire industries. Due to established research and development activities, Leonhard Breitenbach GmbH has developed a tremendous know-how, particularly in the field of finish machining of roll surfaces. This has made the company a globally recognized specialist in the high-quality mixing and calendaring business.

## MARANGONI MECCANICA SPA

**Stand:** 4520

**Stand Representatives:** Edoardo Salaorni, Roberto Grandi, Anna Cescatti

**Address:** Via E. Fermi 29, Rovereto, I-38068, Italy

**Tel:** +39 464 485 200

**Fax:** +39 464 430 145

**Email:** meccanica@marangoni.com

**Web:** www.marangoni.com/meccanica

Advanced tire assembly systems and tire machinery engineering. Production includes: Alpha extruder builders by strip winding for tire rubber components: inner-liner, sidewall, fillers, tread; AgriFast tire assembly systems for radial and bias agricultural large tires; UniFast-DualFast flexible tire assembly systems for large radial tires; EmFast tire assembly systems for earthmover tires; molds, milled molds and

### Maximum Tire Correction on a Minimum Budget

The design of this machine provides a simple online or offline grinding system for the purpose of reducing radial force, radial runout and conicity without compromising tire appearance.

The system, patented world wide, collects the complex profile data acquired from the tire, via a laser or from a CAD file and through various algorithms, provides a desired tread profile that the dual stone grinders then create. *Contact us today for more information.*

*Introducing the Brand New*

## ASM-PGM

**Profile Grinding Machine**

BEFORE

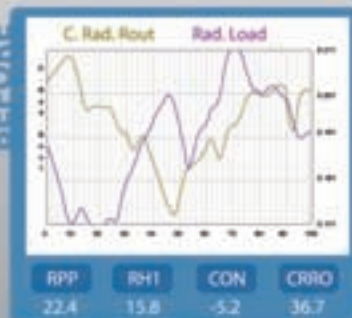

AFTER

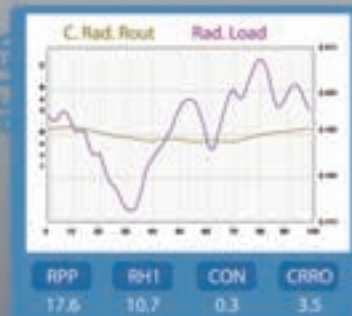

The above two charts show Tire Waveform readings before and after a 150 second grind.

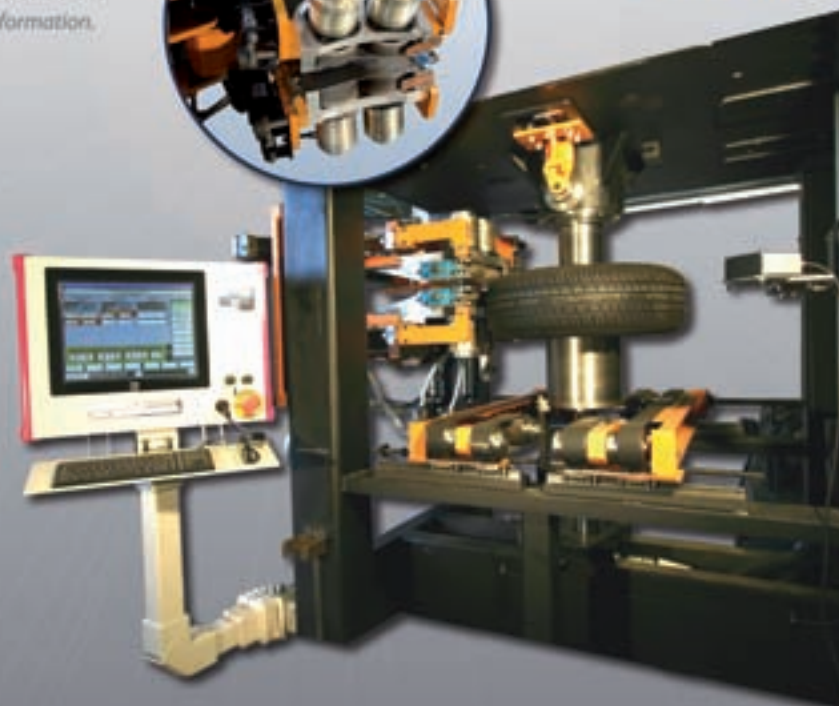



containers; advanced retreading systems; tire to energy systems. Development of highly innovative solutions in tire assembly equipment. The technology includes totally innovative unistage drums, and developments in curing systems for large tires.

## MARBO ITALIA SPA

**Stand:** 4325

**Stand Representatives:** Alberto Cortesi, Roberto Brescia

**Address:** Via T.Tasso 25/27, Pogliano Milanese, 20010, Italy

**Tel:** +39 02939611

**Fax:** +39 0293550048

**Email:** info@gruppomarbo.com

**Web:** www.gruppomarbo.com

Marbo Italia spa is one of the world's leading suppliers of release agents to the tire industry, supplying a complete range of technically advanced products for all aspects of tire manufacture. These include batch-off anti-tacks for mixing lines, semi-permanent release agents for tire building, inside and outside tire paints, bladder treatments, semipermanent release agents for the tire molding, water-based repair paints and lubricants for tire fitting. Marbo delivers these environmentally friendly products all over the world via a network of distributors and agents that support all the customer's needs with outstanding customer service, technical assistance and local warehousing.

## MARBOCOTE LIMITED

**Stand:** 4325

**Stand Representatives:** Ian Snowdon, Mike Rigby, Joanna Rimmer

**Address:** Unit B, Telford Way, Middlewich, CW10 0GX, Cheshire, UK

**Tel:** +44 (0) 1606 738737

**Fax:** +44 (0) 1606 738846

**Email:** info@marbocote.co.uk

**Web:** www.marbocote.co.uk

Marbocote Ltd manufactures a complete range of water-based release agents that are used throughout the world by all the leading manufacturers of elastomer/rub-

ber components. From tires and automotive rubber to metal components, through to belting, matting and pharmaceutical goods, Marbocote has continued the advancement of semi-permanent release technology to give the most durable release film combined with the maximum release performance. These properties give our customers significant process benefits and cost savings, making Marbocote the product of choice for all the major rubber manufacturers, including Goodyear, Pirelli, Hutchinson, ZF Boge Elastmetall, Trelleborg and many more.

## MATTEUZZI SRL

**Stand:** 4105

**Stand Representatives:** Emilio Matteuzzi, Alberto Mattarozzi, Andrea Benincasa

**Address:** Via Serra 1/E - Lippo, Calderara Di R./Bologna, I-40012, Italy

**Tel:** +39 0 517 26351

**Fax:** +39 0 517 26283

**Email:** cristina.ortoleva@matteuzzi-srl.com

**Web:** www.matteuzzi-srl.com

The Matteuzzi range of products for new tire manufacturers has been constantly improved through the years and includes: inspection and testing machines, trimming machines, run-out reducing machines (grinders), painting machines as well as machines especially designed to customers' specifications. The Matteuzzi range of products also includes machines for the tire retreading process.

## MCNEIL & NRM INC

**Stand:** 4435

**Stand Representatives:** Hans Evers, Don Spear, John McCormick, Scott Colson, Daniel Gineys

**Address:** 96 East Crosier Street, Akron, OH 44311, Ohio, USA

**Tel:** +1 330 253 2525

**Fax:** +1 330 253 7022

**Email:** bhahn@mcneilnrm.com

Founded in the early 1900s, McNeil & NRM Inc has been one of the foundations in machinery supply to the tire industry. With its technology base in Akron, Ohio and high-quality manufacturing plant in Bucharest Romania, McNeil & NRM Inc is positioned to remain a pillar in machinery supply to the industry. Together with its sister companies, McNeil & NRM Inc offers a wide range of products and services to the tire industry, including curing presses, tire assembly equipment, mills, calendars, strip winding and cutting machinery.

## MEZSERVIS SPOL SRO

**Stand:** 4200

**Stand Representatives:** Vilem Kumber, Jiri Vecer, Eva Sukana

**Address:** Jiraskova Ul. 459, PO Box 83, Vsetin, CZ-755 01, Czech Republic

**Tel:** +420 571 498 811

**Fax:** +420 571 498 888

**Email:** eva.sukana@mezservis.cz

Mezservis Ltd is a dynamically developing company with more than 90 years' experience in the sphere of electric machines and drives, focusing on the technological process automation of industrial machines, technological lines and devices. Within the rubber industry we offer complex solutions for electric equipment deliveries that cover development, hardware designing and software engineering, visualization and measurements, data processing, manufacturing and delivering of electric switchboards and operating elements as well as cable mounting, assembly and commissioning, PLC program debugging, putting into operation, operation tests, staff training and customer service.

## MGT SRL

**Stand:** 4500

**Stand Representatives:** Virgilio Gioseffi, Fabrizio Manfredi, Chiara Giuliani, Fabio Bertazzo

**Address:** Via Cavalcabo 7, Rovereto (TN), I-38068, Italy

**Tel:** +39 0464 480684

**Fax:** +39 0464 487154

**Email:** c.giuliani@mgtitalia.com

**Web:** www.mgtitalia.com

Design and manufacturing of strip winding applicators for agricultural and OTR tires up to 63in bead diameter. Design and manufacturing of vulcanizing presses for OTR tires up to 51in bead diameter.

## MICRO-EPSILON MESSTECHNIK GMBH & CO KG

**Stand:** 4003

**Stand Representatives:** Franz Hochwimmer

**Address:** Konigbacher Strasse 15, Ortenburg, D-94496, Germany

**Tel:** +49 8542 168 0

**Fax:** +49 8542 168 90

**Email:** info@micro-epsilon.com

**Web:** www.micro-epsilon.com

Supplier of tire surface inspection systems for the detection of bulges and depressions in tire production. Extruder line profilometer, thickness and profile measurement of rubber sheet, displacement and position sensors and IR temperature sensors

## MICRO-POISE MEASUREMENT SYSTEMS LLC

**Stand:** 4125

**Stand Representatives:** Mark Muroski, Walt Stashkiw, Gerry Pol, John Clark, Robert Miller

**Address:** 1624 Englewood Avenue, Akron, OH 44305-4205, Ohio, USA

**Tel:** +1 330 784 1251

**Fax:** +1 330 798 0250

**Email:** mmuroski@micropoise.com

**Web:** www.micropoise.com

Micro-Poise Measurement Systems LLC is the leading global provider of measurement and inspection systems and aftermarket services for the tire industry. With more than 90 years in business, Micro-poise continues to provide a complete line of uniformity machines, dynamic balancers, geometry measurement systems and aftermarket services to meet your needs. Our well-known brands include ASTEC for uniformity testing, AkroDYNE for dynamic balancing, and TGIS-SL with AkroSCAN laser sensors for geometry measurements. Micro-Poise corporate headquarters is located in Akron, Ohio, USA. The European office is located in the Netherlands. Asian offices are in China and Korea.

## MITSUBISHI INTERNATIONAL GMBH

**Stand:** 4005

**Stand Representatives:** Masatoshi Akama, Andreas Weisskopf, Jun Umemura, Katsuhide Aikawa, Iris Edom

**Address:** Kennedydamm 19, Düsseldorf, 40476, Germany

**Tel:** +49 0211 4397 232

**Fax:** +49 0211 4397 382

**Email:** andreas.weisskopf@mitsubishicorp.com

**Web:** www.mitsubishicorp-de.com

Mitsubishi Heavy Industries Ltd together with Mitsubishi International GmbH supply a wide range of tire machinery to more than 50 countries worldwide. From standard machines to custom-made design, we offer through our global network all kinds of solutions for hydraulic curing presses, tire building machines, internal mixers and dynamic balancing machines.

## MUENCH CHEMIE INTERNATIONAL GMBH

**Stand:** 4235

**Stand Representatives:** Florian Schreiber, Valeriana Essigke

**Address:** Viernheimer Strasse 70-76,

Weinheim, D-69469, Germany

**Tel:** +49 62 01 99 8341

**Fax:** +49 6201 99 8366

**Email:** vessigke@muench-chemie.com

**Web:** www.muench-chemie.com

Münch Chemie International GmbH was founded in 1948. For more than 60 years the company has been developing, producing and distributing our own products in all industrial applications. For the tire manufacturing industry the company supplies: batch-off, release agents, mold release agents, bladder coatings, inside and outside lubricants and molding lubricants, all available from the product range. Your application is not listed? Please come to us at booth 4235 or visit our website.

## NAKATA ENGINEERING CO LTD

**Stand:** 4440

**Stand Representatives:** Tokio Nakane

**Address:** 619 Minami, Kande Cho, Nishi Ku, 651 2312, Kobe, Japan

**Tel:** +81 78 965 1030

**Fax:** +81 78 965 3630

**Email:** k-narita@nakata-eng.co.jp

**Web:** www.nakata-eng.co.jp

Our expertise has been accumulated throughout 95 years as a rubber manufacturing equipment specialist contributing to the rubber industry worldwide. Our global service network has been strengthened year by year with successful partnerships with customers. We manufacture extruders and roller head units. Also our interface technology provides not only tread and sidewall lines, but also breaker cutters, ply cutters, non-grid bead winders and JLB systems. In 2007, we started innovation activity aimed at technological and business power-up. In addition to this, we established a new plant in China in 2008 to boost our production capacity. We promise the best partnership with you.



INTERNAL MIXERS | TSRs | MILLS | CALENDERS | TILT-DISCHARGE MIXERS | REMANUFACTURING

# Design Innovation & Manufacturing Excellence

## Internal mixers

Including  
Mixtron BB series

## TSRs

Twin screw roller  
head extruders

## Mills

Laboratory to full-size  
production models

## Tire testing machinery

Tire uniformity and  
endurance testing equipment

***The industry leader  
in rubber and plastic  
machinery...  
service...  
support***

- Full line of mixers, extruders, calenders, mills, and tire test equipment
- Most advanced designs in rotors, including the patented 6-wing VCMT rotor, and new 4-wing N
- Remanufacturing/upgrading of used machinery
- Testing lab for customized mixing solutions
- Spare parts for all manufacturers
- Full turnkey installation, start-up assistance, and support services
- 24-hour field service

For more detail, visit our website at [ksbiusa.com](http://ksbiusa.com) or call 330-655-3111.



**KOBELCO STEWART BOLLING, INC.**

1600 Terex Road, Hudson, Ohio 44236 Tel: 330-655-3111 Fax: 330-655-2982  
24-Hour Hotline: 1-800-464-0064 email: [information@ksbi.com](mailto:information@ksbi.com) website: [www.ksbiusa.com](http://www.ksbiusa.com)

## NDC INFRARED ENGINEERING LTD

**Stand:** 4020

**Stand Representatives:** Chris McGowan

**Address:** Bates Road, Maldon, Essex, CM9 5FA, UK

**Tel:** +44 1621 852244

**Fax:** +44 1621 856180

**Email:** sales@ndcinfrared.co.uk

**Web:** www.ndcinfrared.com

Calender control systems. NDC's TDi (Total Distributed intelligence) measurement and control systems enable tire manufacturers to improve quality and yield by using optimized measurement and scanning technology to measure key process parameters such as: total gum weight; wire balance; wire cord count and position, and full sheet width. Available controls include: three-zone weight control; automatic target optimization, and preset controls for quick start-ups. TDi systems use Ethernet TCP/IP communications between sensors, scanning frames and interfaces, for maximum convenience and ease of installation.

## NECUMER-PRODUCT GMBH

**Stand:** 4215

**Stand Representatives:** Michael Steinacker, Dirk Nedderhoff, Simon Garisch

**Address:** Bruchheide 16, Bohmte, D-49163, Germany

**Tel:** +49 5471 95020

**Fax:** +49 5471 950299

**Email:** info@necumer.de

**Web:** www.necumer.de

Necumer-Product GmbH, located in Bohmte/Germany, has been active in the area of developing and processing polyurethanes for over 30 years and keeps a wide range of high-performance polyurethane board materials. These years of experience enable us to offer you an optimized standard range of block and board materials for almost every application in the modeling and tooling areas of many different industries.

Necumer delivers not only standard board sizes but also custom-shaped blocks for tire model workshops. These special boards save material, time, waste disposal, tools and machining time.

## OERLIKON TEXTILE GMBH & CO KG

**Stand:** 4455

**Stand Representatives:** Oguz Karcier, Wolfgang Schöffl

**Address:** Leonhardstrasse 19, Kempten, D-87437, Germany

**Tel:** +49 831 6880

**Fax:** +49 831 688320

**Email:** sales-allma.saurer@oerlikon.com

**Web:** www.saurer.oerlikontextile.com

The business of Oerlikon Saurer comprises the product lines Allma, Volkmann, Saurer and Melco. It is the world's market leader in the entire twisting machine segment. Production program includes: two-for-one twisters TechnoCorder and TC-S MiniLab; two-for-one twisters MultiCorder; cabling machines and cableCorders.

## PARKER HANNIFIN GMBH & CO KG

**Stand:** 4100

**Stand Representatives:** Holger Szidzik

**Address:** Pat-Parker-Platz 1, Kaarst, D-41564, Germany

**Tel:** +49 2131 40160

**Fax:** +49 2131 40169199

**Email:** parker.germany@parker.com

**Web:** www.parker.com

Parker Hannifin is the global leader in motion and control technologies.

## PELMAR ENGINEERING GERMANY

**Stand:** 4350

**Stand Representatives:** Peter Riess, Jacob Peled, Hagai Peled, Richard Wilkinson, Armond Boyes

**Address:** Senefelder Strasse 4, Hasselroth, D-63594, Germany

**Tel:** +49 6055 9061074

**Fax:** +49 6055 9061073

**Email:** mail@pelmar.com

**Web:** www.pelmar.com

Pelmar Engineering Ltd is a world-leading supplier of refurbished, pre-owned, and new machinery to the tire and rubber industry. Our inventory includes mixers, calenders, mills, extruders, cutters, TBMs, presses, testing and finishing equipment, and many more, which are suitable for most tire brand production, tire retreading, tire recycling, automotive and gaskets, hoses, flooring and covering, conveyor belts manufacturing and other technical rubber goods. In addition, we specialize in reconditioning and rebuilding machinery, engineering consultations, technical and technological support, transportation and shipment, turnkey projects, plant relocation, plant evaluations, and plant acquisitions.

## POMINI RUBBER & PLASTICS SRL

**Stand:** 4001

**Stand Representatives:** Camilla Campanini

**Address:** Via Leonardo Da Vinci, 20, Castellanza, I-21053, Varese, Italy

**Tel:** +39 0331 743 111

**Fax:** +39 0331 743 204

**Email:** info@pomini-rp.com

**Web:** www.pomini-rp.com

Pomini is a company founded in 1886 and located in Castellanza, 30km north of Milan. Since April 6, 2007, Pomini Rubber & Plastics is an independent company which has been part of Possehl Group. Its production range covers equipment for mixing rooms for the rubber industry (mixers and mixing lines for production of tires, rubber technical goods and custom compounding).

# Developing Improving

## Your Victory Is Our Achievement

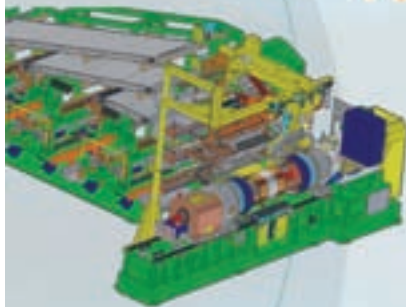

### Production Introduction

1. Tire Building Machine
  - Bias Tire
  - High Performance Radial Tire
    - Two Stages
    - Single Stage
  - All Steel Radial Tire
2. Ply Servicer
3. Building Drum Series
4. Band Building Machine Series
5. Tire Trimming Machine
6. Cord Stripping Machine
7. Curing Press
8. Horizontal Ply Auto Cutting & Splicing M/C



三智機械工業股份有限公司

SAMSON MACHINERY INC.

Address: NO. 43-5, SINHE RD., SINFONG TOWNSHIP, HSINCHU COUNTY 304, TAIWAN

TEL : +886-3-5687755 Fax : +886-3-5687722

<http://www.samson.com.tw> <http://www.samson-tbm.com.cn>

E-Mail : [webmaster@samson.com.tw](mailto:webmaster@samson.com.tw)



## Build your tires quality around our slitting solutions

For many year, Calemard has developed equipments to answer **all your slitting needs** in tire plant.

We forsee the tire market trends and **understand your production stakes**.

Take benefit of these **experience and expertise** :

Choose **the world leader** in machine for tire stock preparation,

Choose **quality**,

Choose **Calemard slitting solutions** !



*Aquila narrow slitter and spooling line*



*Orion wide slitter*

Tel : +33 (0) 477 90 00 34

Fax : +33 (0) 477 90 36 83

[calemard@spoollex.com](mailto:calemard@spoollex.com)

**[www.calemard.com](http://www.calemard.com)**



Services range from the supply of individual machines to that of complete production lines, including complete engineering and supply of all equipment together with start-up and process know-how. Pomini equipment is manufactured using the most advanced technology and is controlled by in-house-developed automation systems.

### PRODICON INTERNATIONAL SRL

**Stand:** 4310

**Stand Representatives:** Alberto Ballabio

**Address:** Via Statuto Nr. 18, Milano, I-20121, Italy

**Tel:** +39 0265 72073

**Fax:** +39 0229 002931

**Email:** manuela.falcone@prodicon.it

Prodicon is an Italian company based in Milan with more than 30 years of experience in the design and manufacturing of machinery for the rubber industry. The Prodicon system achieves results with a vast range of customized solutions with very different levels of automation and therefore of investment. Prodicon designs, manufactures and delivers worldwide cooling lines, cutting lines, multipurpose stackers and other ancillary equipment for the rubber industry, particularly for tire manufacturers.

### QINGDAO MESNAC CO LTD

**Stand:** 4245

**Stand Representatives:** Wei Xueliang

**Address:** No. 1 Zhengzhou Road, Qingdao, 266045, China

**Tel:** +86 532 84011776

**Email:** info@mesnac.com

**Web:** www.mesnac.com

Mesnac – China's famous rubber machinery maker – has achieved the European level of product quality. Mesnac is mostly focused on the design and production of mixer feeding systems, small chemical weighing systems, dynamic unbalance test machines, uniformity test machines as well as more rubber process machines. Mesnac

customers are not only all major Chinese tire producers, but also the world's top tire producers such as Michelin, Bridgestone, Pirelli, Goodyear, Kumho.

### RHODIA OPERATIONS SAS

**Stand:** 4140

**Stand Representatives:** Peter Browning, Pierre-Emmanuel Goutorbe, Remi Lebleu, Philippe Cochet, Jérôme Pisani

**Address:** 55 Avenue René Cassin, Lyon, F-69009, France

**Tel:** +33 4 37 91 81 12

**Fax:** +33 4 37 91 81 04

**Web:** www.rhodia.com

Well-known as the inventor of a highly dispersible silica, Rhodia is an innovative partner to the tire industry, providing cutting-edge filler technology from a network of seven manufacturing plants across four continents. The Zeosil and Zeosil Premium silica ranges contribute to lower tire rolling resistance and improved grip, hence reducing vehicle fuel consumption and CO<sub>2</sub> emissions while enhancing vehicle handling and safety. Rhodia focuses on its joint development platform with Dow Corning, global leader in silicones and silanes. Through their alliance, Dow Corning and Rhodia are working to create new opportunities for tire manufacturers in the field of sustainable mobility.

### RJS CORPORATION

**Stand:** 4430

**Stand Representatives:** Paul Kapper, Cheryl Hamilton, Chuck Winafeld

**Address:** 3400 Massillon Road, Akron, OH 44312, Ohio, USA

**Tel:** +1 330 896 2387

**Fax:** +1 330 896 3282

**Email:** sales@rjscorp.com

**Web:** www.rjscorp.com

RJS Corporation manufactures supporting machinery for the tire industry. Our products are well known to companies around the world. RJS will engineer complete projects around its product line or

supply its products for projects handled by others. Products include: complete steel cord creel systems for tire manufacturing; creel loading systems; precision tension controllers; plunger test/bead unseating machine; OTR band builders; slitters; tire branders, and conveyor-belt tracking devices.

### RMS EQUIPMENT COMPANY



**Stand:** 4004

**Stand Representatives:** Gene Arnold, Andrew Gibson, Nick Kocher

**Address:** 105 Glasgow Street, PO Box 9001, Kitchener, N2G 4J4, Ontario, Canada

**Tel:** +1 519 749 4634

**Email:** agibson@rmsequip.com

**Web:** www.rms-ca.com

RMS is a world-leading machinery supplier to the tire industry. Extrusion, typified by single-roll roller dies, has been recently updated. For smaller profiles, mini, single-roll roller die is being used by many major tire companies. For larger profiles we provide multiple compound single-roll roller dies, including quadruplex systems. Advantages include better dimensional control and lower extrusion temperatures plus improved line speeds. Systems can be supplied complete with cutting-edge downstream lines tailored to customer requirements. Our range of passenger and light truck tire building machines comes with automatic cutting and application of components, all backed by RMS's 90 years of experience.



**RMT ROBOTICS LTD****Stand:** 4360**Stand Representatives:** Bill Torrens, Don Heelis**Address:** 635 South Service Road, Grimsby, L3M 4E8, Ontario, Canada**Tel:** +1 905 643 9700 Ext. 273**Fax:** +1 905 643 9666**Email:** billtorrens@rmtrobotics.com**Web:** rmtrobotics.com

RMT Robotics: Small world. Big solutions. No matter where you are located in the world, RMT can help you reduce costs and improve operating efficiency. As pioneers in the industry, we design, manufacture and integrate robotic gantry-based work in process and warehousing systems for passenger and truck tires. From green tire handling to cured tire distribution, our fully integrated solutions address the unique needs of clients globally. Find out why the world's top tire manufacturers trust RMT's proven approach. Breaking new ground for over 17 years, our systems process over 750,000 tires per day (and counting) with our enduring, proven solutions.

**ROCKWELL AUTOMATION****Stand:** 4730**Stand Representatives:** Claus Biernoth, Heico Hagemann, Bertrand Chabrat**Address:** Zur Giesserei 19-27, Karlsruhe, 76227, Germany**Tel:** +49 7219650759**Fax:** +49 721 9650 888**Email:** nheier@ra.rockwell.com

Rockwell Automation is the solution provider for the tire industry, with strong industry expertise, a complete offering of integrated automation and information solutions combined with global support. We draw on our extensive global experience to deliver the right solutions, technologies and services for your tire manufacturing business so that you can: deliver your competitive advantage, improve quality, reduce costs, increase responsiveness, improve time-to-customer throughout your supply chain and

improve the performance of your machine – and your employees.

**RODOLFO COMERIO SNC****Stand:** 4562**Stand Representatives:** Claudio Sardella**Address:** Via IV Novembre 163/165, Solbiate Olona, I-21058, VA, Italy**Tel:** +39 0331 641680**Fax:** +39 0331 641666**Email:** comm@comerio.it**Web:** www.comerio.it

Founded in 1878, Rodolfo Comerio is an Italian manufacturer of calendaring lines and equipment for rubber and plastics processing, such as high-performing two-roll mills allowing production of rubberized textile and steel cords, rubber sheets, complex liners, profiling for bead filler, cushions for tread profiles and embossed elastic rubber sheets.

**RUBBER POINT SRO****Stand:** 4245**Stand Representatives:** Karol Vanko**Address:** Tovarenska 1, Dubnica Nad Vahom, 018 41, Slovakia**Tel:** +421 911256023**Email:** rgulis@coatec.sk**Web:** www.rubber-point.com

Rubber Point is a new international trade company located in Slovakia, which was established by experts with many years' experience in the tire and rubber business. Rubber Point is the official Mesnac representative and service center for Europe and the Middle East.

**SAMSON MACHINERY INC****Stand:** 4340**Stand Representatives:** Marian Hung, Kevin Lin, Christine Wang**Address:** No 13-5 Sinhe Road, Sinfong Township, Hsinchu County, 304, Taiwan**Tel:** +886 568 7755 / 568 0606**Fax:** +886 568 7722**Email:** maa@samson.com.tw

Samson Machinery Inc has been a professional tire equipment manufacturer in Taiwan since 1975. Samson has more than 30 years' experience in this field and also has ISO9001 and CE certification. Samson provides a full range of tire building machines and accessories, such as bicycle, scooter, motorcycle, activity, truck, bus, radial passenger, LTR, OTR and AF tires. Bias or radial, semi-steel or all steel, with small or large diameter, Samson can satisfy all of your needs. Please just send your inquiry to our company and we will provide the most suitable machine and information for you.

**SCHILL+SEILACHER  
STRUKTOL  
AKTIENGESELLSCHAFT**
**Schill+Seilacher**
**Stand:** F3**Stand Representatives:** Guido Robbe, Colin Clarke, Dr Karl Menting, Dr Volker Börger, Rene Mille**Address:** Moorfleeter Str. 28, Hamburg, D-22113, Germany**Tel:** +49 40 73362 129**Fax:** +49 40 73362 192**Email:** grobbe@struktol.de**Web:** www.struktol.de

Hamburg-based Schill+Seilacher is the market leader in processing additives for



A photograph of a paved road with a white line, curving through a green landscape with trees in the background. The text "who drives us?" is overlaid in large, white, sans-serif font.

# who drives us?

**Find Out at Stand # 4140**

the rubber industry. It will present its latest developments within the well-known Struktol range of processing aids and release agents. Schill+Seilacher will also report on its activities regarding the management of the new European Community's chemical regulatory framework, REACH. Two papers will be presented at the conference: Dr Börger: 'Implementation of REACH at a medium-size company. Next steps following pre-registration'; and Colin Clarke: 'Energy-efficient tire compound processing'.

## SDS SYSTEMTECHNIK

**Stand:** 4260

**Stand Representatives:** Stefan Dengler, Jörg Schäuble, Bernward Mähner

**Address:** Rudolf-Diesel-Strasse 7, Calw, D-75365, Germany

**Tel:** +49 705 1931 540

**Fax:** +49 705 1931 54 99

**Email:** cschnuth@stllabs.com

With more than 300 Interferometric Tire Testers (ITT), SDS is a leader in the tire industry for quality control, based on shearography. Its systems are cost effective, with scaled solutions for R&D up to the fastest setups for production. Systems cater for all types and sizes of tires, from motorcycle to the largest OTR tires. With the automatic Pressure Test System (PTS), detecting fatigue and structure anomalies, SDS defines a new standard to prevent casing failures with re-treads. Solutions for 3D measuring to get run-out, variation, diameter, width, etc. and other products for buffing void detection, laser marking, durability testing underscore the competence of SDS in the tire industry.

## SEICHTER GMBH

**Stand:** 4450

**Stand Representatives:** Wolfgang Seichter, Michael Meinen, Siegmund Ahlvers, Natascha Lichte

**Address:** Esperantostrasse 8, Hannover, D-30519, Germany

**Tel:** +49 511 875 970

**Fax:** +49 511 863 078

**Email:** contact@seichter.com

**Web:** www.seichter.com

TTIC [BG] the truck tire inspection center for dynamic balancing and geometry measurement is in the next phase of design. The prime target of the development is to measure truck tire geometry. The measurement of dynamic balance for truck tires is the secondary challenge of the new machine design. Seichter GmbH produces tire uniformity and geometry machines for the quality grading of tires and wheels in the final finishing: TIC for passenger car and light truck tires for tire producers; WIC for tire wheel assembly producers. Our patented conicity error correction procedure allows us to measure conicity of wheels. The WIC also permits the inspection of rims with the laser-based RimChecker.

## SIGMAVISION LTD

**Stand:** 4335

**Address:** CIE, Begbroke Science Park, Sandy Lane, Yarnton, Oxon, OX5 1PF, UK

**Tel:** +44 1865 854820

**Fax:** +44 1865 854821

**Email:** mail@sigmavision.com

**Web:** www.sigmavision.com

## SIMULIA



**Stand:** F8

**Stand Representatives:** Frans Peeters, Christiaan Stoker

**Address:** Gaetano Martinolaan 95, PO Box 1637, Maastricht, NL 6201 BP, Netherlands

**Tel:** +31 43 356 6906

**Fax:** +31 43 356 6908

**Email:** mirianne.marnette@3ds.com

Simulia is the Dassault Systèmes brand that delivers a scalable portfolio of realistic simulation solutions including the Abaqus product suite for unified finite element analysis, multiphysics solutions for insight into challenging engineering problems and lifecycle management solutions. Abaqus offers well-developed, robust computational capabilities for a broad range of tire analyses such as quasi-static, steady-state dynamic and nonlinear transient dynamic analyses that are typically required during the design process. In addition, Abaqus offers efficient solution techniques needed for large and complex tire models. Tire hydroplaning can be analyzed using the coupled Eulerian-Lagrangian capability.

## SNE DESHORS MOULAGE



**Stand:** 4346

**Stand Representatives:** Gilles Paterne

**Address:** Zac du Mazaud – Le Chassagne, BP 550, Brive La Gaillarde, Cedex, F-19107, France

**Tel:** +33 (0) 555 88 40 15

**Fax:** +33 (0) 555 88 40 36

**Email:** info@ad-deshors-mo.com

**Web:** www.adgroupe.com

Give us your expectations, we'll give you perfection! Only by using Deshors integrated business solutions. Deshors – a worldwide leader in tire molds – can help your company improve its bottom line. Proven track records and cost efficiency by integrating the Deshors team providing: tire mold construction support, engineering 3D expertise and high-quality products. Implementing our lean methodology and process with efficient techniques, we have mastered technologies such as: 3D specific development for quick CAD and CAM, five-axis CNC models, five-axis CNC high performances for full engraving tread steel or

aluminum. Low-pressure aluminum foundry, casting the most difficult tread patterns, puzzle mold since 1975 with engineering assistance for co-development in ventless solutions. We provide an advanced technology process for venting DROVE System, giving your tire a top-class appearance.

### STANDARDS TESTING LABS

**Stand:** 4260

**Stand Representatives:** Cheryl Schnuth, Dave Caniglia

**Address:** 1845 Harsh Ave., SE, PO Box 758, Massillon, OH 44648, USA

**Tel:** +1 833 8548

**Email:** cschnuth@stllabs.com

**Web:** www.stllabs.com

Standards Testing Labs is known worldwide as a leader in the manufacture of tire and wheel test equipment. Additionally, STL has been providing testing services for wheels, tires and other automotive components for more than 30 years and tests to industry standards. Rolling resistance is available for high loads (SAEJ1269) and for coast-down (SAEJ2452). Work is complete to reconstruct our cleated wheel machine for improvements in Belgian block testing. Other services include testing to numerous standards, including the FMVSS 139 and UTQG. Additional services include investigative sciences, failure analysis, expert witnessing, and nondestructive testing, shearography and x-ray.

### STEINBICHLER OPTOTECHNIK GMBH

**Stand:** 4484

**Stand Representatives:** Rainer Huber, Thomas Köhler, Roland Zehentmaier

**Address:** Georg-Wiesböck-Ring 12, Neubuern, D-83115, Germany

**Tel:** +49 8035 870421

**Fax:** +49 8035 1010

**Email:** p.kirchner@steinbichler.de

**Web:** www.steinbichler.de

Worldwide leading supplier of optical

measuring and test equipment (3D digitizing, surface inspection, vibration and deformation analysis, shearography-NDT, shearography tire inspection). Shearography tire inspection systems (intact series) for the non-destructive testing of car, (light) truck, aircraft and OTR tires. New intact 2800 for the inspection of OTR tires 45/65-45 with a maximum outer diameter of 2,800mm; extension to outer diameter of up to 4,300mm.

### SYSTRAPLAN GMBH & CO KG

**Stand:** 4137

**Stand Representatives:** Hartmut Brünger

**Address:** Einstein Strasse 5, Herford, D-32052, Germany

**Tel:** +49 5221 7677 22

**Fax:** +49 5221 7677 77

**Email:** h.bruenger@systraplan.de

Automatic booker loading devices are well known and used in the tire industry for quality assurance of treads and tires as well as for rationalization. Systraplan, specialist for warehouse techniques when it comes to flat materials, has a long history of building auto booking and handling systems for the tire industry. This machine type has been further developed on the basis of experience gained with a large number of machines. Systraplan, a company located in Herford, Germany, has perfected the auto booking systems and is now offering solutions for rework handling in combination with auto booking.

### TARRC/RUBBER CONSULTANTS

**Stand:** 4348

**Stand Representatives:** Gail Reader

**Address:** TARRC, Brickendonbury, Hertford, SG13 8NL, UK

**Tel:** +44 (0) 1992 584966

**Email:** greader@tarrc.co.uk

Rubber Consultants is the consultancy unit of one of the world's leading rubber

research and development laboratories: the Tun Abdul Razak Research Centre (TARRC), part of the Malaysian Rubber Board. Services offered include analytical and physical testing, prototype design and manufacturing and contract research. Comprehensive tire testing facilities include three testing rigs for truck and passenger tires and staff experienced in tire retreading and tire analysis. Showcased on stand 4348 will be information on passenger tire tread compounds based on silica-filled Ekoprena, a polymer derived from natural rubber. This new generation of tread compounds offers reduced rolling resistance and hence improved fuel consumption, combined with improved wet traction.

### TEXKIMP LTD

**Stand:** 4560

**Stand Representatives:** David Barker

**Address:** Swan House, New Cheshire Business Park, Wincham Lane, Wincham, Northwich, CW9 6GG, Cheshire, UK

**Tel:** +44 1606 338748

**Fax:** +44 1606 338749

**Email:** kathryn.baker@texkimp.co.uk

**Web:** www.texkimp.co.uk

Texkimp is a supplier of creels to the tire cord industry worldwide and can offer the widest range of tire cord creels, with designs that have been proved in operation for more than 20 years. The fixed creels (TC-FEL & TC-F) and mobile creels (TC-T and TC-MM) undergo continual market development and testing, making them the best-value and most consistent solutions available. Texkimp's wide range of material unwinding experience and proven attention to detail enable Texkimp to deliver the performance and partnership that is required by its customers, to maximize the benefits from the company's investment in the latest generation of weaving machines and cable corders.



# HERBERT®

PARTNER FOR SERVICE & TIRE TECHNOLOGY WORLDWIDE

## ADVANCED TECHNOLOGY



## FOR THE TIRE INDUSTRY

### HERBERT Maschinen- und Anlagenbau GmbH & Co. KG HERBERT Maschinenbau GmbH & Co.

Industriestrasse 10, Germany 36088 Hünfeld

Phone: +49-6652-609-144 / -343, Fax: +49-6652-609-111 / -312

E-Mail: [info@herbert.eu](mailto:info@herbert.eu)

[www.herbert.eu](http://www.herbert.eu)

### TIRE MANUFACTURING EQUIPMENT

TIRE MOLD CONTAINERS, SEGMENTED MOLD INSERTS

■ WITH ENGRAVED TREAD PATTERN

■ WITH INSERTED TREADRIBS OF STEEL (ENGRAVED OR CASTED)

TWO PIECE MOLDS, SIDEWALL PLATES, BEAD- AND BLADDER CLAMPING RINGS, BLADDER MOLDS WITH VARIOUS TYPES OF VENTING, SPECIAL MOLDS AND CONTAINER SOLUTIONS ACC. TO CUSTOMER REQUIREMENTS, TIRE BUILDING DRUMS

### TIRE BUILDING MACHINERY

HYDRAULIC TIRE CURING PRESSES, MECHANICAL TIRE CURING PRESSES, BLADDER CURING PRESSES, TYRE BUILDING MACHINES, MATERIAL SUPPLY EQUIPMENT / SERVICER, TRANSFERRINGS, POST CURE INFLATORS (PCI)

### HERBERT Machine Works Inc.

850 Moe Drive, Akron, Ohio 44310, USA

Phon: +1-330-929-4297, Fax: +1-330-929-4298

E-Mail: [todd.jarvis@hmw.us.com](mailto:todd.jarvis@hmw.us.com)

[larry.pinkerton@hmw.us.com](mailto:larry.pinkerton@hmw.us.com)

## ADVANCED TECHNOLOGY FOR THE TIRE INDUSTRY



**Ammeraal Beltech**  
Innovation & Service in Belting

## Relax – with our belts for the tire industry

Ammeraal Beltech offers a complete range of modular belts for the tire industry. At the 2009 Tire Expo in Hamburg we will present a new roller top belt line which is specifically of use as a collector belt of finished tires from vulcanizing/curing presses and for final tire handling. We will also show an OWL belt, which is a heat and wear resistant belt with minimal friction surface and large open areas for easy drainage and airflow. The focus here is on deep tank and batch-off equipment.

[www.ammeraalbeltech.com](http://www.ammeraalbeltech.com)

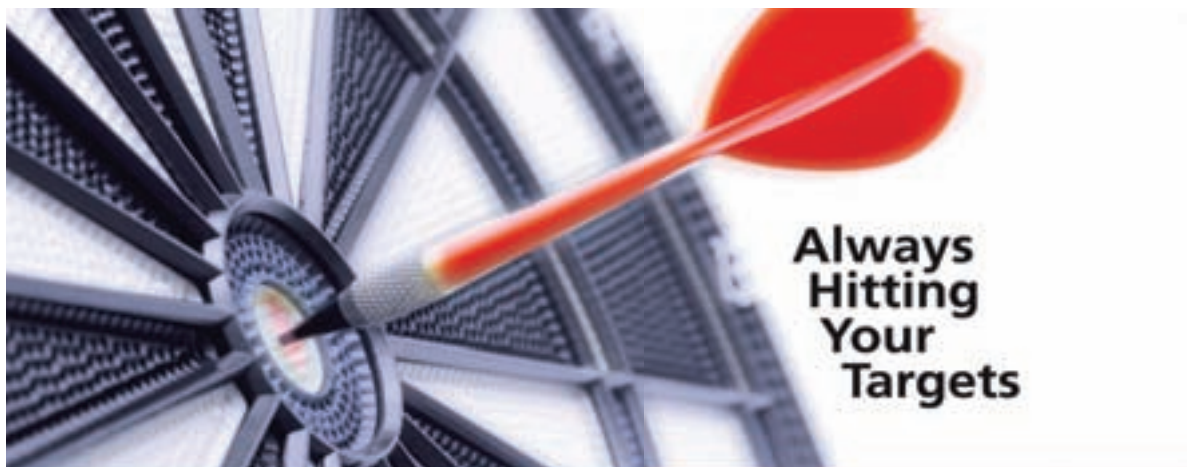

**Always  
Hitting  
Your  
Targets**

**One step ahead with BST International**

Web Guiding, Web Width Measurement and Web Width Control systems for:

- Innerliner
- Extrusion Lines
- Calender Lines (Textile- and Steelcord)
- Assembly Lines
- Cutting Lines (Textile- and Steelcord)
- Tire Building Machines
- Doubling Stations
- Special Applications



BST International GmbH | Hindeweler Heide 53 | 31739 Bielefeld | Germany | Phone: +49 5206 999-0 | Fax: +49 5206 999-758  
www.bst-international.com | automation@bst-international.com | A member of the ILLIUS group



**De Pryck & Co.  
Gesellschaft für  
Automatisierungstechnik mbH**



## Special machine equipment for tire industry



- Bead Winding Machines
- Cap Strip Machines
- Mini Slitter Lines
- Maxi Slitter Lines
- Breaker/Ply Recovery Machines
- Truck Tire Inspectomates
- PC Tire Inspectomates
- Special tools for tire industry
- electro-technical engineering,  
software programming and start-up

*Visit us at Tire Technology  
EXPO 2009 / Stand No. 4210*

**GfA De Pryck & Co.** Gesellschaft für Automatisierungstechnik mbH • Sedanstr. 32-34 • D-31008 Elze  
Tel. +49 5068/93020 • Fax +49 5068/930210 • email: info@gfa-automation.de • www.gfa-automation.de



## THE POLING GROUP



**Stand:** 4240

**Stand Representatives:** David L. Poling, Alexander Hasbach, James Shively, Tracy L. Stevanov, Jeff Nixdorf

**Address:** 2740 Cory Avenue, Akron, OH 44314, Ohio, USA

**Tel:** +1 330 753 1077

**Fax:** +1 330 753 7308

**Email:** dlpoling@akronspecial.com

**Web:** sales@polinggroup.com

The Poling Group: ASM is a leading designer and manufacturer of low- and high-speed tire uniformity, geometric and grinding machines. ASM-Hasbach provides a line of high-speed endurance testing and characteristic tire test machines. ASF offers a complete line of mill room equipment, calendars, mill blenders, slab-loader cutters and batch-off. CTI manufactures uniformity machine controllers and tread label application systems, integrated software and BI solutions. MSI manufactures control systems for uniformity machines and profile grinding machines. Firwood-ASM products include white sidewall grinder, paint applicator and pci units.

## THE STEELASTIC COMPANY



**Stand:** 4004

**Stand Representatives:** Brian Fetzer, Bill Bradshaw, Linn Tate

**Address:** 1557 Industrial Parkway, Akron, 44310, Ohio, USA

**Tel:** +1 330 633 0505

**Email:** bbradshaw@steelastic.com

**Web:** www.steelastic.com

Steelastic offers a complete line of automated tire making component equipment including: automatic bias and ply

cutting systems; steel belt and steel body ply making systems; automatic bead apex application systems; cap strip making systems; hot and cold gum edger application systems; wind-up systems; upgrades for existing lines and complete after-sales support.

## TIENT SHENG MOLDING TECH INC (TSM)

**Stand:** 4330

**Stand Representatives:** Nox Lin, Jason Lin, Emily Hu

**Address:** 32 Minlong Road, Yangmei Town, Taoyuan County, 32663, Taiwan

**Tel:** +886 3 4727239

**Fax:** +886 3 4727318

**Email:** nox013@tsm1975.com.tw

**Web:** www.tsm1975.com.tw

TSM (Tien Sheng Molding Technology Inc) is in the north of Taiwan. It focuses on producing tire molds. At present, the main customers are the majority of tire companies across Southeast Asia. We believe a good mold should be accepted by people in the industry across the whole world, because a good mold can produce the best-quality tire. This is why we absorb ourselves in the technology of the tire mold

## TIRE CURING BLADDERS LLC

**Stand:** 4472

**Stand Representatives:** Vernon Almon

**Address:** 5701 Murray Street, Little Rock, AR-72209, Arkansas, USA

**Tel:** +1 501 570 7519

**Fax:** +1 501 562 5635

**Email:** vernon.almon@tirebladders.com

**Web:** www.tirebladders.com

Tire Curing Bladders LLC is an international supplier of tire curing bladders and tire assembly machine parts. The Little Rock, AR, USA factory was purchased in a management buyout from Pirelli Tire in 2005. TCB has built its business and reputation on worldwide technical service, prompt de-

livery and quality manufactured products. A complete listing of bladder and TAM products and the company's history and background are available on our website. You can also visit our stand to view sample products, including new items and products in development.

## TIRE TECHNOLOGY EXPO 2010



**Stand:** 4706

**Stand Representatives:** Colin Scott

**Address:** Abinger House, Church Street, Dorking, Surrey, RH4 1DF, UK

**Tel:** +44 1306 743744

**Fax:** +44 1306 742525

**Email:** colin.scott@ukintpress.com

**Web:** www.ukipme.com

In 2010 Tire Technology Expo – the world's premier tire manufacturing technology exhibition and conference – returns to Cologne in Germany. Tire Technology Expo 2010 will take place on 9, 10 and 11 February at the Koeln Messe. As always, the event will feature an exhibition from the world's leading companies supplying equipment and materials from the entire tire manufacturing process. You can book your company's stand for Tire Technology Expo 2010 at the Tire Technology Expo booth.

## TIRE TECHNOLOGY INTERNATIONAL



**Stand:** 4706

**Stand Representatives:** Colin Scott, sales and marketing director, Tire Technology International; Adam Gavine, editor, Tire Technology International

**Address:** UKIP Media & Events, Abinger House, Church Street, Dorking, Surrey



## Aftermarket **Products & Services**

Committed to Maximizing Your Investment for Uniformity Machines,  
Dynamic Balancers and Geometry Measurement Systems

- ▶ Parts & Tooling
- ▶ Global Support & Services
- ▶ Machine Modernization  
& Rebuilding
- ▶ Start-Up & Testing
- ▶ Maintenance  
& Service Contracts
- ▶ Training



**Visit Us at Tire Technology EXPO 2009 – Hall A1 Stand 4125**

1624 Englewood Ave. | Akron, OH USA 44305 | +1-330-784-1251 | [www.micropoise.com](http://www.micropoise.com)

## **KONŠTRUKTA-Industry, a.s.** **TRADITION IN TYRE MACHINERY**

**tire**  
technology  
EXPO 2009

### **CUTTING TECHNOLOGY**

- Steel Cord Cutting Lines
- Textile Cord Cutting Lines

### **EXTRUSION TECHNOLOGY**

- Cold & Hot Feed  
Extruders
- Multiple Extrusion  
Lines
- Roller-Head Extrusion Lines

[www.konstrukta.sk](http://www.konstrukta.sk)

KONŠTRUKTA-Industry, a.s., K výstavisku 13, 912 50 Trenčín, Slovak Republic, e-mail: [sales@kotaind.sk](mailto:sales@kotaind.sk)

**No. Stand  
4135**



RH4 1DF, UK

**Tel:** +44 1306 743744

**Fax:** +44 1306 742525

**Email:** colinscott@ukintpress.com;  
a.gavine@ukintpress.com

**Web:** www.ukipme.com

Since its launch 17 years ago, Tire Technology International has earned international acclaim as the world's leading publication focused exclusively on tire design, manufacturing and production. Tire Technology International is published five times a year as four quarterly magazines and an Annual Review consisting of extensively illustrated technical papers. The Annual Review is a highly respected source of information on cutting-edge developments from leading research institutes, centers of excellence and suppliers involved in all areas of the tire manufacturing process. The Chinese language version of the Tire Technology International Annual Review was launched in 2004. Tire Technology International magazine, published in March, June, September and December, incorporates topical news-driven coverage on the latest breakthroughs in the industry.

## TIS GMBH & CO KG

**Stand:** 4410

**Stand Representatives:** Matthias Kaczorowski

**Address:** Lily-Braun-Str.19, Bad Oldesloe, D-23843, Germany

**Tel:** +49 4531 89 35 85

**Fax:** +49 4531 89 3619

**Email:** mk@tis-systems.com

**Web:** www.tis-systems.com

TIS GmbH & Co KG is committed to continuous development of software and hardware applications for tire inspection, increasing the breadth of solutions for clients with tire inspection needs, in both x-ray and laser applications. The latest software feature involves the use of x-ray radiation to determine tire thickness. Utilizing NTB u-shaped detectors coupled with RTW panoramic x-ray tubes, TIS has successfully applied this feature together with VRM in the world's largest EM/OTR tire x-ray inspection

machines. In addition, TIS is completing development of tire component testing, using laser and x-ray inspection in combination to achieve optimal results.

## TROESTER GMBH & CO KG

**Stand:** 4735

**Stand Representatives:** Stefan Boettcher, Gerald Fromm, Ludmila Gotovtseva

**Address:** Am Brabrinke 1-4, Hannover, D-30519, Germany

**Tel:** +49 511 87 040

**Fax:** +49 511 864 028

**Email:** info@troester.de

**Web:** www.troester.de

Troester is a leading supplier of extrusion systems to the global rubber and cable industry. A wide range of systems related to tire profile manufacturing is available for our customers. With our tailor-made tread/sidewall extrusion lines as well as inner-liner systems including downstream equipment and line control, maximum benefit for the tire industry is accomplished. Troester is well known as a reliable extrusion partner and source of know-how for all major tire companies, but also a favorite choice for medium-sized and local tire producers. A team of specialists will be present at Tire Technology Expo 2009 to explain the latest technological developments and to answer your questions.

## TS PLZEN AS

**Stand:** 4238

**Stand Representatives:** Jiri Berger, Vaclav Smazal, Ales Simunek

**Address:** Tylova 1/57, Plzen, 316 00, Czech Republic

**Tel:** +420 377 336 126

**Fax:** +420 337 336 107

**Email:** berger@tsplzen.cz

**Web:** www.tsplzen.cz

The advantages of TS Plzen (previously Skoda TS) hydraulic curing presses include: higher accuracy of mold guidance, energy savings, shortening of manipulation time, shortening of curing time, regulated closing

force, ecological conditions. A new product is a press for radial tires with: unique design, low energy consumption, independent curing process, high accuracy of mold guiding and tire loading, short handling, environmental parameters, progressive charging of bladder with technological media, high-speed heating. What we intend to show at the exhibition: curing presses 63.5in to 130in modernization (53 presses modernized within recent years). There exist capabilities of TS Plzen for manufacturing and assembling cooperation.

## UTH GMBH

**Stand:** 4600

**Stand Representatives:** Winfried Trost, Horst Hain

**Address:** Eisenhowerstr. 7-9, Fulda, D-36041, Germany

**Tel:** +49 661 9741 11

**Fax:** +49 661 974130

**Email:** pwill@uth-gmbh.com

**Web:** www.uth-gmbh.com

The unique roll-ex extrusion system is recognized as a leading technology in the field of the gear pump technique for rubber processing. Models of different sizes have been operating at countless rubber and tire production plants worldwide. Major applications for this technology in tire manufacturing are fine mesh straining of rubber compounds and precise extrusion. The fine mesh straining system of Uth includes a wide range of supplementary systems like breaker plate cleaning station and software solutions. Roll-ex gear extruders are currently available in six different sizes with a throughput range of 70 to 6,000kg/h. Trial machines are available for tests.

## UZER MAKINA VE KALIP SANAYII AS

**Stand:** 4464

**Stand Representatives:** Seyfullah Bozkurt, Ahmet Kilic

**Address:** Kocaeli Arslanbey OSB No. 95, Izmit, 41285, Kocaeli, Turkey

**Tel:** +90 262 351 3184

# POMINI

Rubber & Plastics

VISIT US AT

**tire**  
technology  
EXPO 2009

HAMBURG  
17-19/2/09  
STAND 4001

**PLAST**  
MILANO 24-28/3/09  
PAD13 STAND C10



VIC

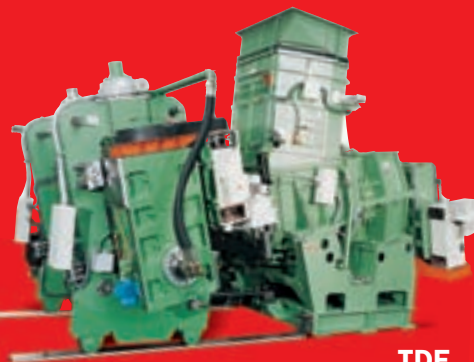
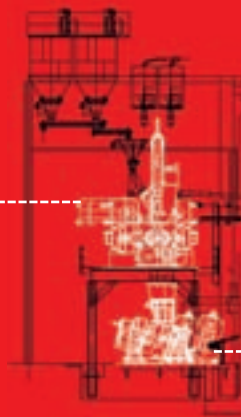

TDE

**POMINI Rubber & Plastics srl**

Via Leonardo da Vinci, 20 - 21053 Castellanza (VA) Italy

Phone +39 0331 743111 - Fax +39 0331 743204

info@pomini-rp.com - www.pomini-rp.com

# KG

**KARA GOSTAR**  
Tire Mold Manufacturer

BEST TIRES COME FROM FINEST MOLDS



**tire**  
technology  
EXPO 2009

Visit us at  
Hall A1 Stand 4515

Main office:  
**Kara Gostar Eng. Co.**  
No.160, Patris Lomomba St.  
Sattarkhan Ave. Tehran-Iran  
P.O. Box : 14455-534  
Tel. : (+98 21) 6692 8942 - 6643 4143  
Fax : (+98 21) 6642 6697

Factory:  
2nd.Koysariat St., Town of Qhods  
Tehran.Iran  
Tel. : (+98 262) 3867985 - (+98 262) 3848781  
Fax : (+98 262) 3848785  
Email: kg@karagostar.com  
www.karagostar.com

**RWTUV**  
RUBBER & WHEEL TIRE UNION  
FOR QUALITY



**Fax:** +90 262 351 3193

**Email:** [uzer@uzermakina.com](mailto:uzer@uzermakina.com)

**Web:** [www.uzermakina.com](http://www.uzermakina.com)

Uzer Makina is mainly focused on producing equipment for curing in the area of tire plants. It produces curing presses, curing molds, containers and bladder molds. Mechanical-type curing presses range from 40in to 104in, and hydraulic-type curing presses range from 40in to 52in. UM has developed a new concept hydraulic press for the production of passenger car and light vehicle radial tires. Due to advanced CNC equipment, with UM, all segmental-type curing molds, and even large full-type OTR molds are manufactured by the direct engraving method. UM produces containers per customer specifications, also bladder molds based on customer specifications and UM drawings.

## VANDERLANDE INDUSTRIES NEDERLAND BV

**Stand:** 4242

**Stand Representatives:** Roald De Groot, John Luchies

**Address:** Vanderlandelaan 2, Veghal, 5466, Netherlands

**Tel:** +31 413 495 170

**Fax:** +31 413 495 025

**Email:** [anouk.van.beers@vanderlande.com](mailto:anouk.van.beers@vanderlande.com)

Vanderlande Industries provides automated material handling systems and accompanying services. It focuses on improving its customers' business processes and strengthening their competitive position. The company is active in baggage handling at airports, distribution centers and express parcel sortation facilities. The company implements material handling systems of all sizes, and the company ranks among the top five worldwide in its field, and in baggage handling is among the top three. In every case the emphasis is on close partnership with the customer, extending from initial analysis of the underlying business processes through to total lifecycle support.

## VIPO AS

**Stand:** 4135

**Stand Representatives:** Anton Jablonicky

**Address:** Gen. Svobodu 1069/4, Partizanske, 958 01, Slovakia

**Tel:** +421 38 749 3153

**Fax:** +421 38 749 3903

**Email:** [vipo@vipo.sk](mailto:vipo@vipo.sk)

**Web:** [www.vipo.sk](http://www.vipo.sk)

VIPO AS is a customer-oriented development and engineering firm, European supplier of equipment and solutions for PCR tires, truck tires and OTR tire production. We offer: bead winding lines both single and multiwire, apex lines, bead-apex handling systems, slitting machines for rubberized textile, application of control systems and visualization.

## VMI HOLLAND BV

**Stand:** 4715

**Stand Representatives:** Ferri R. Breugelmans, Harm Voortman, Cindy Van Norel

**Address:** Gelria Weg 16, PO Box 161, Epe, NL-8160 AD EPE, Netherlands

**Tel:** +31 578 679 111

**Fax:** +31 578 621 317

**Email:** [sales@vmi-group.com](mailto:sales@vmi-group.com)

**Web:** [www.vmi-group.com](http://www.vmi-group.com)

VMI is committed to being a leading supplier of a comprehensive range of equipment for manufacturing radial car and truck tires, as well as for handling rubber compounds for the global tire and rubber industry. We have the experience and expertise to be your partner in production excellence. From our facilities in the Netherlands, Germany, Russia, Brazil, USA, Malaysia and China we provide you with superior products and local support. Our ideas and concepts implemented with the latest technologies can give you the necessary competitive edge.

## WD RACING LTD

**Stand:** 4470

**Address:** Kuljuntie 9, 37200, Siuro, Finland

**Tel:** +358 50 5411407

**Fax:** +358 3 343 2139

## WERBA-CHEM GMBH



**Stand:** F5

**Stand Representatives:** Marek Gardavsky, Izzet Bilgin

**Address:** Lugeck 1, Vienna, A-1010, Austria

**Tel:** +43 1 514 90 12

**Fax:** +43 1 514 90 20

**Email:** [izzet.bilgin@werba.com](mailto:izzet.bilgin@werba.com)

**Web:** [www.werba.com](http://www.werba.com)

Under the superscription cost saving our rubber team has developed products for the tire industry on the basis of environmental-tolerable raw materials. Those fillers, additives, waxes and resins enable significantly more efficient compound preparation and facilitate the processing. It has been proved in practice that our processing aids and resins optimize processes that were difficult to perform previously. Our waxes and fillers open new ways for compound formulation. Moreover, in some special cases those products enable processes that were impossible to perform formerly. Tap your full optimizing potential with the help of: Werbalub, Werbatec, Werbalink and Werbablend.

## WYKO TIRE TECHNOLOGY LTD

**Stand:** 4440

**Stand Representatives:** Brian Painter, Alan Parker, Ingo Mattstaedt

**Address:** Unit G, Grazebrook Industrial Park, Peartree Lane, Dudley, West Midlands, DY2 0XW, UK

**Tel:** +44 1384 844100

**Fax:** +44 1384 239572

**Email:** [info@wyko-tyre.com](mailto:info@wyko-tyre.com)

**Web:** [www.wyko-tyre.com](http://www.wyko-tyre.com)



Wyko Tire Technology is the world's leading manufacturer of tire production tooling, with a customer list covering most of the major global tire manufacturers. With over 45 years of manufacturing expertise, Wyko specializes in first- and second-stage precision tire building machine tooling, first-stage drums, belt and tread drums, transfer rings, shaping drums, band building drums and bespoke tooling. With an extensive knowledge of tire manufacturing processes, Wyko has highly experienced tire tooling engineers who can deliver maximum levels of performance, making this a winning combination. Wyko is more than happy to work with your engineers to help achieve your uniformity and productivity goals.

### **YXLON INTERNATIONAL X-RAY GMBH**

**Stand:** 4355

**Stand Representatives:** Gina Naujokat, Jürgen Melchert, Klaus Tiggesbäumker, Olaf Tropp, Oliver Arendt  
**Address:** Essener Bogen 15, Hamburg, D-22419, Germany

**Tel:** +49 40 52729 404

**Fax:** +49 40 52729 271

**Email:** gina.naujokat@hbg.yxlon.com

**Web:** www.yxlon.com

Yxlon International is the well-known specialist and world-market leader in the field of non-destructive material testing with x-ray. One important segment of Yxlon's activities is the inspection of tires-in research, development and production. The standard and customized solutions of Yxlon are designed according customers' requirements and ensure quality and safety of the tires as well as improve the manufacturing processes to reduce costs on the customer's side. Our product range starts with manual systems and ends up with CT systems. Yxlon International is located in Hamburg, Copenhagen, Akron (Ohio), Tokyo, Beijing, Shanghai and Hattingen, and has a network of representatives all over the world.

### **Z-LASER OPTOELEKTRONIK GMBH**

**Stand:** 4468

**Stand Representatives:** Stefan Frei  
**Address:** Merzhauser Str. 134, Freiburg, D-79100, Germany  
**Tel:** +49 761 296 44 44  
**Fax:** +49 761 296 44 55  
**Email:** info@z-laser.de

Laser manufacturer Z-Laser Optoelektronik, situated in Freiburg, Germany, has developed special laser models and accessories for the tire industry used in the production process, but also for quality check. This time they will show the Z-24F, a focusable red laser, which can be powered with 12 to 24 VAC or 9 to 36 VDC machine voltage by connecting it directly to the tire building machine via an industrial Lumberg plug (M12 connector). Z-Laser will also show many special mountings for aligning the lasers precisely. With the electrical adjustment drive ZES, up to three lasers can be aligned automatically. New this year: focusable green lasers and ZES for large drags.

### **ZEPPELIN SILOS & SYSTEMS GMBH**

**Stand:** 4365

**Stand Representatives:** Wolfgang Becker, John Eaton, David Scott, Guido Veit

**Address:** Leutholdstraße 108, Friedrichshafen, 88045, Germany

**Tel:** +49 7541 202 279

**Fax:** +49 7541 202 491

**Email:** zentral.fn@zeppelin.com

**Web:** www.zeppelin-industry.com

The Zeppelin group is the leading supplier of raw materials handling plants to the rubber and tire industry worldwide. Zeppelin not only has more than 20 years of experience in this field, but it also assures its customers of all the advantages of a successful industrial group with operations at many sites around the globe. From raw material reception via storage and conveying, weighing and dosing and

small component preparation, automation, up to complete turnkey mixing halls for carbon black, white fillers, plasticizer and additives, Zeppelin delivers all your system needs from a single source.

### **ZF PASSAU GMBH (ZF FRIEDRICHSHAFEN AG)**

**Stand:** 4505

**Stand Representatives:** Roland Boesl, Klaus Wildfeuer, Franz Zillner  
**Address:** Test Systems, Passau, D-94030, Germany  
**Tel:** +49 851 494 5529  
**Fax:** +49 851 494 5593

**Email:** testsystems@zf.com

**Web:** www.zf.com

Based on several decades of in-depth experience developing testing equipment and backed by the ZF Group, ZF Test Systems offers custom-designed testing systems with proven, reliable technology and stable, long-term partnerships with customers. ZF Test Systems supplies vehicle manufacturers worldwide, as well as their suppliers and companies from other industries. Especially for tires and wheels, the most delicate and severely stressed vehicle components, ZF offers prototype and series production test benches, together with numerous test procedures that tire manufacturers need to ensure fast development and certified quality assurance.

**EUROPE'S LEADING INTERNATIONAL TIRE DESIGN AND  
TIRE MANUFACTURING EXHIBITION AND CONFERENCE**

# **tire** technology **EXPO 2010**

**9, 10 & 11 February 2010**  
**Köln (Cologne) Messe, Germany**

**BOOK YOUR STAND  
NOW FOR 2010**

**VISIT STAND 4706**

**[www.tiretechnology-expo.com](http://www.tiretechnology-expo.com)**

**Tire Technology Expo 2010**  
**UKIP Media & Events, Abinger House, Church Street, Dorking, Surrey RH4 1DF, UK**  
**Tel: +44 (0)1306 743744 Fax: +44 (0)1306 877411 Email: [c.scott@ukintpress.com](mailto:c.scott@ukintpress.com)**

**Tire  
Technology Expo**  
Hall A1 Stand 4720

## Quality first, no compromise on tires

### ■ Complexor:

Precise complexing  
of secondary  
to master strip



### ■ Elsmart:

Slatted Roll Guide  
for gentle alignment of  
rubber strips and fabric liners

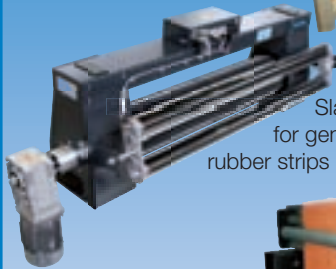

### ■ X-Pander:

Uniform cord distribution  
at the edges and throughout  
the entire web width

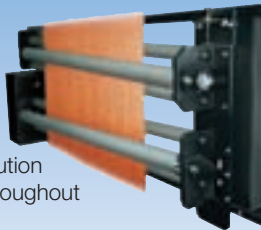

**Erhardt+Leimer**

your reliable partner for  
innovative technology in the  
Tire and Rubber industry



**Erhardt+Leimer GmbH**

Postfach 10 15 40

86136 Augsburg, Germany

Phone ++49 (0)821 24 35-531

Fax ++49 (0)821 24 35-320

info@erhardt-leimer.com

www.erhardt-leimer.com

# hfdialog

Gummimischtechnik | Kautschuktechnik | Speiseöltechnik

## let's talk

Being a strong technology partner of today is based on our 150 years of know-how in engineering and our basic principle:

Progress can only be achieved through a clear approach and ethical values.

Today Harburg-Freudenberger is a synonym for innovation and tradition: Machines, equipment and systems for the tire and rubber industry as well as for oil mills and the food industry.

We are your technology partner providing you with over 150 years of know-how.

**Meet us at booth 4225!**



powered by commitment

[harburg-freudenberger.com](http://harburg-freudenberger.com)



# Demanding applications? We've seen them all.



With a drive system from Hägglunds, you get compact, durable power up to some 3 MW per driven shaft - without foundation or gearbox. A full range of rugged motor types and complete solutions for excellent control give you total assurance, even in the most demanding applications.

**Let us know your demands we will meet them.**

**Visit us! Hall A1, stand #4220**

Hägglunds Drives AB, SE-890 42 Mellansel, Sweden.  
Tel: +46 (0)660 870 00, [www.hagglunds.com](http://www.hagglunds.com)  
E-mail Business Area Manager: [uno.sundelin@se.hagglunds.com](mailto:uno.sundelin@se.hagglunds.com)

**Our drive is your performance.**

**HÄGGLUNDS**